

# ESCAPE

## MINI

Ultra Lightweight Travel Trailers

### 2018 Décor



*Fossil*

#### Standards

- Tinted Windows
- R-7 Insulation
- Diamond Plate Rock Guard
- Rear Bumper w/Sewer Hose Storage
- Self-Adjust Electric Brakes
- Radial Tires
- 20# LP Bottle
- 30AMP Detachable Power Cord
- Cable Hookup
- City Water Fill
- Digital TV Antenna
- 12V Converter w/Charger
- Monitor Panel
- Linoleum Throughout
- 2-Burner Cooktop
- Amish-Crafted Rustic Maple-Glazed Cabinets
- Rail-Style Cabinet Doors w/Modern Handles
- Mesh Storage Pockets
- Overhead Cabinets
- LED Interior Lighting
- Shower & Toilet
- Evergreen Queen Mattress w/Reversible Comforter
- Deep Single Sink (large enough for filling pots, pans & pitchers)
- Easy to Tow (no mirror extenders w/our narrow body design)
- Wheels are mounted on the outside of the exterior walls

#### Options

- 13,500 BTU A/C Low Profile IPO Maxx-Air® Power Fan
- 24" LED TV w/Inside/Outside Bracket
- Wireless Backup Camera System – Observation
- Front Window (required, N/A on 181KST)
- Motion Security Sensor for Smart Arm Awning
- Wind Sensor for Smart Arm Awning

#### Off-Road Package

- 15" Mud Tires
- Extra Ground Clearance
- Electronically-Controlled Heated Holding Tank
- Double Entry Step

#### K-Z Advantage Package (mandatory)

##### Exterior

- Aerodynamic Front & Rear Profiles w/82" Interior Walls
- 5/8" Tongue & Groove Plywood
- Power Awning w/LED Light Strip
- Key Alike Program for Baggage & Entry Doors
- One-piece Seamless Fiberglass Roof w/Aluminum Rafters
- Max Air Multi-Speed Power Fan (N/A w/A/C option)
- A/C Prep
- Electric Tongue Jack
- Aluminum Rims
- Folding Grab Handle
- Exterior Speakers

- Spare Tire & Carrier
- (4) Scissor-Style Stabilizer Jacks
- Outside Shower
- Black Tank Flush
- Solar Prep
- Backup Camera Prep
- Nitrogen-Filled Tires

##### Interior

- 20,000 BTU Furnace
- 6 GAL LP/Electric DSI Water Heater
- Reversible Comforter
- 4.2 CU FT Refrigerator
- Convection Microwave
- Shower Surround w/Fabric Shower Curtain
- Plywood Bed Base
- Seamless Countertops
- (2) 6 ½" Interior Speakers
- Digital Media Stereo w/Bluetooth & 12V Dual USB Ports

#### K-Z Convenience Package (mandatory)

##### Exterior

- Smart Arm Awning w/Exterior Controls
- Friction Hinge Entry Door
- Omnidirectional HDTV Antenna

##### Interior

- Armstrong ToughGuard® Linoleum
- Rail-Style Cabinet Doors
- Interior Control Switches on OH End Cabinet

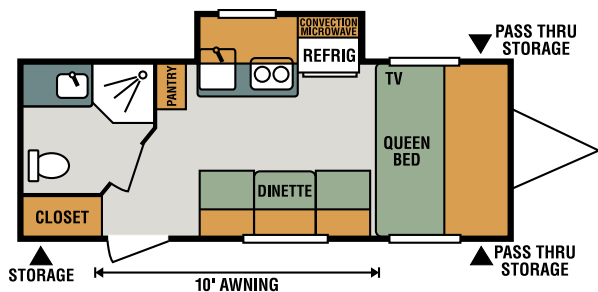

**M181KS**

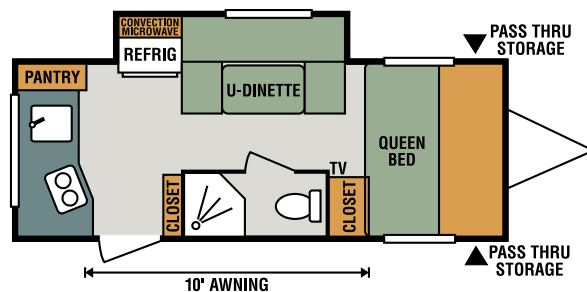

**M181RK**

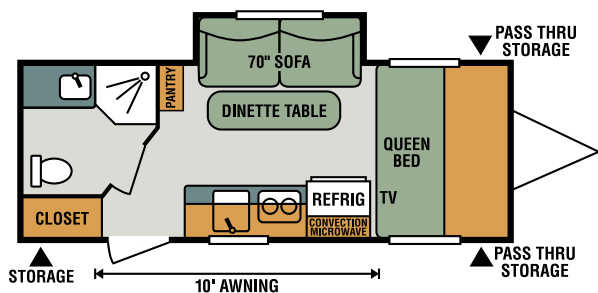

**M181SS**

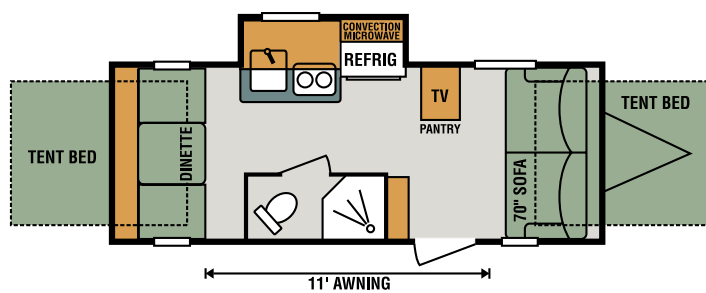

**M181KST** NEW

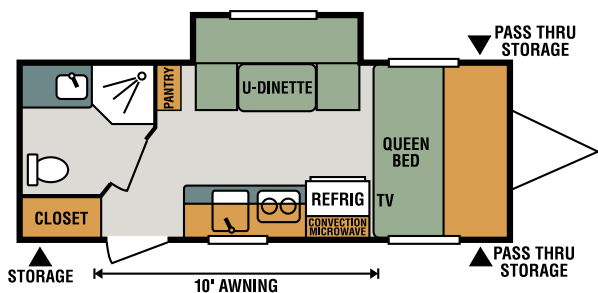

**M181UD**

Travel Trailers	M181KS	M181RK	M181SS	M181KST	M181UD
UVW (Unloaded Vehicle Weight)*	2,828	2,888	2,848	TBD	2,878
Dry Hitch Weight*	300	310	310	TBD	310
Dry Axle Weight*	TBD	TBD	TBD	TBD	TBD
NCC (Net Carrying Capacity)	672	612	652	TBD	622
GVWR	3,500	3,500	3,500	3,500	3,500
Interior Height	82"	82"	82"	82"	82"
Exterior Height	105"	105"	105"	105"	105"
Exterior Width	96"	96"	96"	96"	96"
Exterior Length	20' 9"	20' 9"	20' 9"	20' 9"	20' 9"
Refrigerator (cu. feet)	4	4	4	4	4
Water Heater Cap. (gal. G/E w/DSI)	6	6	6	6	6
Fresh Water Cap. (gal.)	30	30	30	30	30
Waste Water Cap. (gal.)	30	30	30	30	30
Gray Water Cap. (gal.)	32	32	32	32	32
LP Gas Cap. (lbs.)	20	20	20	20	20
Furnace BTUs (1,000s)	20	20	20	20	20
Tire Size	14"	14"	14"	14"	14"
Awning	10'	10'	10'	11'	10'

\*This weight reflects the rolling average unit weight for each model. Your trailer weight will vary according to optional equipment.



985 N 900 W • Shipshewana, IN 46565  
E-mail [kz@kz-rv.com](mailto:kz@kz-rv.com) • [www.kz-rv.com](http://www.kz-rv.com)

Due to continual research and advances, manufacturer reserves the right to change specifications, design, price and equipment without notice, and assumes no responsibility for any error in this literature. Some items shown are not included as standard or optional equipment. ©2017KZ | 8/31/17 | 15M