

Jayco | 2024 Jay Feather Travel Trailer



JAY FEATHER

ADVENTURE IS CALLING



2+3
YEAR | YEAR
WARRANTY

INTERIOR DESIGN



VINTAGE FARMHOUSE



Main Wood



Accent Wood



Floor



Countertop



Main Fabric



Accent Fabric

19MRK OPTION: C

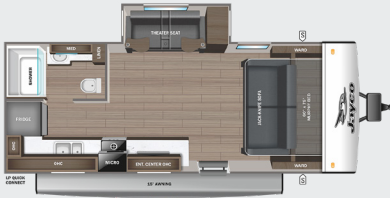

21MBH OPTION: B



21MML OPTION: C

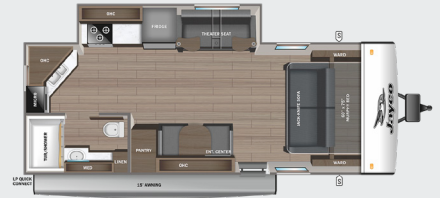

22BH



22RB OPTION: B



23RK OPTIONS: A, C



24BH OPTION: B

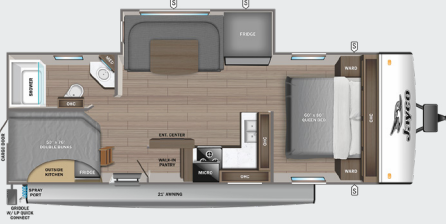

24RL OPTIONS: A, B, C



25RB OPTIONS: A, B



26RL OPTIONS: A, C



27BHB OPTIONS: A, B



	STORAGE
MICRO	MICROWAVE
OHC	OVERHEAD CABINETS
FRIDGE	REFRIGERATOR
WARD	WARDROBE

29QBH OPTIONS: A, B

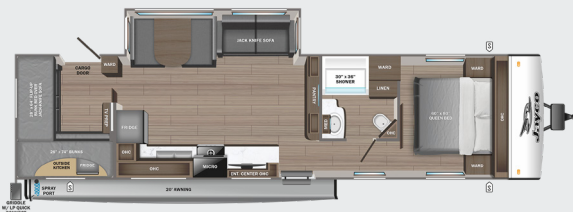

OPTIONS

A		B		C	
	Tri-Fold Sofa		Theater Seat		Griddle

STANDARDS & OPTIONS

EXTERIOR

1.5 in. fresh water drain valve
 2 in. Stronghold VBL™ floor with 2 lb. density foam
 Aerodynamic, rounded front profile with aluminum framing
 American-made Norco Z-frame with integrated A-frame
 Automotive-style aluminum rims
 Battery quick-disconnect
 Bumper-mount bracket for 17 in. griddle (select models)
 Dark-tinted safety-glass windows
 Exterior TV bracket with 120V and cable hook-ups
 Factory installed rear roof ladder
 Front molded decorative cap (select models)
 Galvanized steel and impact resistant wheel wells
 Keyed-Alike™ locking system
 Magnum Truss™ Roof System
 Marine grade exterior speakers with blue LED accent lighting
 Mounted camera bracket for pre-wired side and rear back-up prep
 Outdoor camp kitchen with galvanized steel bases (select models)
 PVC roofing membrane (limited lifetime warranty)
 Stronghold VBL™ walls with double-sided Azdel composite (sidewalls, rear walls and slide out boxes)
 Swing-out entry door assist handle

INTERIOR

4 in. high-density dinette cushions with vinyl backing
 4 in. Teddy Bear soft-touch bunk mats (select models)
 60 x 80 in. residential queen beds (60 x 76 in. in Murphy bed models)
 75 lb. full extension drawer guides
 Bathroom skylight
 Decorative backsplash
 Decorative roller shades with reflective barrier

Directional and closeable A/C vents
 Gas-strutted under bed storage (most models)
 Handcrafted, hardwood door/drawer fronts
 Hidden-hinged cabinet doors
 High output auto-ignition propane gas furnace
 LED lighting throughout
 Plywood dinette, bed, bunk and shower/tub bases
 Powered roof vents in bathroom and main bedroom (most models)
 Residential style kitchen countertops
 Residential vinyl flooring throughout
 Screwed and glued cabinet stiles
 USB charging ports (multiple locations throughout)

CUSTOMER VALUE PACKAGE (MANDATORY)

13,500 BTU roof-mounted A/C
 20 lb. propane gas bottles with auto-regulator and ABS cover
 55 gallon fresh water tank
 AM/FM/Bluetooth stereo with roof-mounted speakers
 American-made nitro-filled Goodyear® radial tires with self-adjusting electric brakes
 Automotive-style aluminum rims
 Black tank flush
 Detachable power cord
 Inverter pre-wire (2 bedroom nightstand outlets, main TV and outlet for outside kitchen fridge)
 Max-length power awning with LED light
 On-demand water heater 60,000 BTU water heater
 Outside shower
 Power tongue jack
 Rock Solid Stabilizer System
 Side and rear back-up camera prep
 Spare tire

SPORT PACKAGE (MANDATORY)

32 or 39 in. LED Smart TV
 Climate Shield (zero to 100 degree tested weather insulation package)
 Drying rack/sink cover
 Dual-hinge 10 cu. ft. 12V fridge
 LCI Solid Step fold-down aluminum tread steps on main entry door
 MAXAIR® power roof vent (main living area)
 Modern graphics package with dual-colored sidewall
 Overlander 1 Solar Package: (1) 200W solar panel and 30-amp digital controller

OPTIONS

120V heated tank pads
 15,000 BTU A/C in place of 13,500 BTU A/C
 17 in. outside griddle (select models)
 30 lb. propane gas bottles with auto-regulator and ABS cover
 50-amp service with 2nd A/C prep
 Electric fireplace (select models)
 JAYCOMMAND® Smart RV System with TPMS
 Overlander 2 Solar Package: (2) 200W solar panels, 30-amp digital controller and 1,800W inverter
 Second 15,000 BTU A/C (select models, must have 50-amp service)

*Indicates split tanks

FLOORPLAN	TOTAL EXTERIOR LENGTH	EXTERIOR WIDTH	EXTERIOR HEIGHT (WITH A/C)	INTERIOR HEIGHT	UNLOADED VEHICLE WEIGHT	DRY HITCH WEIGHT	GVWR	CARGO CARRYING CAPACITY	FRESH WATER CAPACITY	GRAY WASTE WATER CAPACITY	BLACK WASTE WATER CAPACITY	SLEEPING CAPACITY
19MRK	24' 0"	8' 0"	10' 9"	6' 6"	4,775	485	6,250	1,475	55	30.5	30.5	2-4
21MBH	27' 3"	8' 0"	10' 9"	6' 6"	5,484	587	6,995	1,511	55	30.5	30.5	6-8
21MML	26' 0"	8' 0"	10' 8"	6' 6"	5,110	535	6,500	1,390	55	30.5	30.5	2-3
22BH	28' 9"	8' 0"	10' 9"	6' 6"	5,520	590	7,000	1,480	55	61*	30.5	5-7
22RB	27' 10"	8' 0"	10' 8"	6' 6"	5,455	595	7,000	1,545	55	61*	34	2-3
23RK	29' 0"	8' 0"	10' 8"	6' 6"	5,785	530	7,200	1,414	55	30.5	30.5	2-4
24BH	30' 2"	8' 0"	10' 8"	6' 6"	6,000	670	7,500	1,500	55	61*	30.5	5-7
24RL	28' 8"	8' 0"	10' 9"	6' 6"	5,305	640	6,750	1,445	55	30.5	30.5	3-5
25RB	30' 8"	8' 0"	10' 9"	6' 6"	5,735	700	7,250	1,515	55	61*	34	3-5
26RL	31' 11"	8' 0"	10' 8"	6' 6"	6,120	665	7,500	1,380	55	30.5	30.5	2-3
27BHB	33' 2"	8' 0"	10' 9"	6' 6"	6,210	710	7,600	1,390	55	30.5	30.5	7-9
29QBH	36' 1"	8' 0"	10' 11"	6' 6"	6,970	785	8,500	1,530	55	61*	30.5	8-10

Meet your Jayco Dealer



Scan QR code for specification definitions

Some specs at the time of print may include estimates. For the most updated information, please visit Jayco.com

Jayco, Inc. | P.O. Box 460 | Middlebury, IN 46540

See dealer for further information and prices. All information in this brochure and on www.jayco.com is the latest available at the time of publication approval. Jayco reserves the right to make changes and to discontinue models without notice or obligation. Photography may show optional equipment or props used for decoration purposes only. RVs built for sale in Canada may differ to conform to Canadian codes. JAYCO and the JAYCO BIRD IN FLIGHT are registered trademarks of Jayco, Inc. Printed in USA 3/24 ©2024 Jayco, Inc.



Jayco - Part of Jayco Family of Companies