

ALPHA WOLF

TOURING EDITION

TRAVEL TRAILERS

17CB



HITCH (LBS)	525	GVWR (LBS)	6,995
UVW (LBS)	4,678	CCC (LBS)	2,317
EXT LENGTH (FT/IN)	23'4"	EXT WIDTH (FT)	8'
EXT HEIGHT W/STD AC (FT/IN)	11'		
FRESH WATER (GAL)	81	BLACK WATER (GAL)	35
GREY WATER (GAL)	35	AWNING (FT)	15'

17MKE

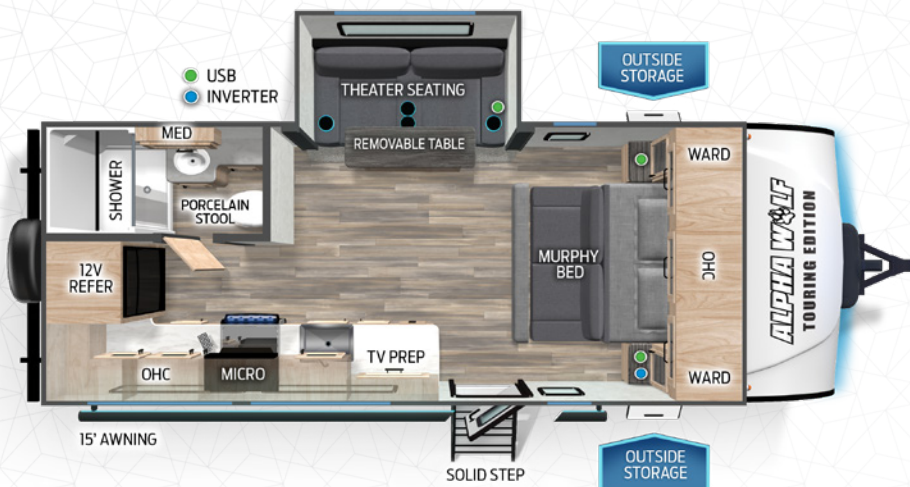

HITCH (LBS)	635	GVWR (LBS)	7,068
UVW (LBS)	4,883	CCC (LBS)	2,182
EXT LENGTH (FT/IN)	23'8"	EXT WIDTH (FT)	8'
EXT HEIGHT W/STD AC (FT/IN)	11'		
FRESH WATER (GAL)	81	BLACK WATER (GAL)	35
GREY WATER (GAL)	35	AWNING (FT)	15'

FLAWLESS FOURTEEN FEATURES

- 💰 Power Tongue Jack
- 💰 Weather Guard Package with Thermo Reflective Safety Glass Windows.
- 💰 Juice Pack Solar Power (100w Roof Mount Panel, Series 27 Battery, Battery Disconnect and Box. Voltmeter and 30amp Solar Charger.
- 💰 Extended "Lend-A-Hand" Rail (Main Entry)
- 💰 Security/Safety Camera System Prep (Side Markers, Rear and Over Main Entry)
- 💰 Tufflex™ PVC Roof Membrane
- 💰 "Niagara" Size 81 Gallon Fresh Water Tank.
- 💰 12v High Efficiency Residential Refrigerator/Freezer.
- 💰 On Demand Tankless Water Heater
- 💰 LCI One Control® Smart RV Technology
- 💰 Oversized Farm Style Kitchen Sink With Commercial Grade Faucet
- 💰 Oversized 15,000 BTU Ducted Air Conditioner
- 💰 Blackout Roller Shades
- 💰 Oxygenics® Fury RV Shower System

ALPHA WOLF TOURING EDITION STANDARDS & OPTIONS



24/7 EMERGENCY ROADSIDE ASSISTANCE WITH VEHICLE PURCHASE*

TOWING
JUMP-STARTS
TIRE CHANGES
FLUID DELIVERY
LOCKOUT
SERVICE

WINCH-OUT
MOBILE MECHANIC
TECHNICAL
SUPPORT
DEALER LOCATOR
SERVICES



*VALID FOR 1 YEAR FROM DATE OF PURCHASE



PRE-DELIVERY INSPECTION FACILITY

20,000 square feet of quality assurance. The bare essentials for a premium product. This state-of-the-art facility gives immediate daily feedback to production for quality assurance in every unit built.



Learn More

Scan this barcode using a QR Reader on your smart phone to learn more about Forest River.



A Berkshire Hathaway company.

WWW.FORESTRIVERINC.COM/ALPHAWOLF 574.264.6664

FREE MEMBERSHIP
to Forest River Owners' Group

www.forestriverfrog.com



SPECIFICATION DEFINITIONS GVWR (Gross Vehicle Weight Rating) - is the maximum permissible weight of the unit when fully loaded. It includes all weights, inclusive of all fluids, cargo, optional equipment and accessories that can be safely supported by a combination of all axles. // **GAWR (Gross Axle Weight Rating)** - is the maximum permissible weight, including cargo, fluids, optional equipment and accessories that can be safely supported by a combination of all axles. // **UVW (Unloaded Vehicle Weight)**** - is the typical weight of the unit as manufactured at the factory. It includes all weight at the unit's axle(s) and tongue or pin and LP Gas. The UVW does not include cargo, fresh potable water, additional optional equipment or dealer installed accessories. // *Estimated average based on standard build optional equipment. // **CCC (Cargo Carrying Capacity)**** - is the amount of weight available for fresh potable water, cargo, additional optional equipment and accessories. CCC is equal to GVWR minus UVW. Available CCC should accommodate fresh potable water (8.3 lbs per gallon). Before filling the fresh water tank, empty the black and gray tanks to provide for more cargo capacity. // ** Estimated average based on standard build optional equipment

Each Forest River RV is weighed at the manufacturing facility prior to shipping. A label identifying the unloaded vehicle weight of the actual unit and the cargo carrying capacity is applied to every Forest River RV prior to leaving our facilities. The load capacity of your unit is designated by weight, not by volume, so you cannot necessarily use all available space when loading your unit. FOR 2326 P/W: 2023.09.21

- Weather Guard Package
- Armored Underbelly Tank Enclosure and Forced Air Heat
- Insulator Series Wood Roof and Floor Superstructure
- Oversized Bathroom Attic Fan for Increased Interior Air Flow
- Thermo-Control Reflective Safety Glass Windows**
- PVC Roof Membrane w/ Heat Reflectivity and Lifetime Warranty**
- Central Air Conditioning Unit (15,000 BTU) with Quick Cool**
- Upgraded Laminated Exterior Walls with Block Foam Insulation
- Soft Open, Blackout Pull Shades Throughout**
- TV Prep
- Full Lino Floor Covering - No Carpet
- Nautilus Style Shower with Retractable Splash Proof Door (Square Shower)**
- Glass shower door (Radius Shower)
- Removable Clothes Hanging Rod In Shower (Square Shower/Tub Only)
- Shower/Tub Skylight
- Porcelain Stool with Water Jet Assist and Foot Flush
- Motion Sensing Night Light in Bathroom
- Smart Monitor Panel with Smart Phone Bluetooth Connectivity
- 10 cu. Ft., 12V high Efficiency Refrigerator
- "Blackout" Kitchen Appliance and Hardware Package
- "Blackout" Wheel Package
- Home Security/Safety Camera System Prep (2 Side, 1 Over Main Entry, 1 Rear)**
- "ToughBend" Rigid Skirt Metal Design
- Outside TV Prep Connections
- Leash Latch Pet Safety Technology
- Motion Sensing Lights in Pass Thru
- Convenience Light at Utility Center
- "Niagara" Size 81 Gallon Fresh Water Tank**
- Extended Lend-A-Hand Handrail (Main Entry)**
- Juice Pack - 100W Roof Mount Solar Panel (Expandable to 450W), Series 27 Battery, Battery Box, Battery Disconnect, Voltmeter and 30AMP Solar Charger
- 5/8" Tongue and Groove Plywood Floor Decking
- 1x Engineered Wood "Super Truss" Roof Structure with 3/8" Decking.
- Fully Laminated Exterior Walls with Block Foam Insulation
- LP Quick Connect
- LED Interior/Exterior Lighting Package
- Outside Shower with Hot and Cold Water

Limited Package

- 12V, Residential Refrigerator w/ Travel Lock**
- Blackout Kitchen Appliance Package
- LCI "One Control"**
- Aluminum Rims
- Spring Spout Kitchen Faucet with Pull-out Sprayer**
- Aluminum Fold Out Exterior Steps
- On Demand Tankless Hot Water Heater**
- On The Go™ Rear Ladder Prep

Features & Options

- G-Glass Entry Door w/Friction Hinge, Window and Shade Prep
- Slam Latch Storage Doors with "Safety Stay" Magnets
- USB/USBC Charging Stations Throughout
- Pet Friendly "Clean Sweep" Floor (No Heat Vents)
- Juice Pack (100W Solar Panel, Batt Disconnect, Battery and 30amp Solar Charger)**

Convenience Package

- Leash Latch Pet Safety Technology
- Large Exterior Folding Assist Grab Handle (Main Entry)
- Laser Blue Ambient Interior Accent Lighting
- Outside shower with Hot and Cold Water
- Power Front Jack with Light**
- Quick Clean Waste Tank Sprayer
- Seamless Countertops Throughout
- Tire Pressure Safety Sensors

Standards

- 150W Inverter Outlet (Main Bedroom)
- Nightstand Drawers (Main Bedroom)
- Under Bed Storage

Options

- 4 Corner Power Travel Trailer Stabilizer Jacks
- Juice Pack Expansion Kit (100W Panel)
- 32" LED TV with Swing Arm Bracket
- Rear Storage Travel Rack

CUSTOMER SATISFACTION



www.ForestRiverBuyLocal.com

YOUR **ALPHA WOLF** DEALER
TOURING EDITION