

# ALITA

CLASS C MOTORHOMES



**ALITA**  
CLASS C MOTORHOMES

[EastToWestRv.com/Alita](http://EastToWestRv.com/Alita)  
A DIVISION OF FOREST RIVER





*Cabover Bunk Space w/ Cargo Net*



*AWD Transit Cab -  
(Showing Dash Infotainment Screen and Camera Display)*



*Solid Surface Countertop w/ Extension,  
Deep Well Stainless Steel Sink*



*Front to Back Living Area*

# Alita Standards & Options

## Alita Top Standard Features

- ▶ Azdel Composite Sidewall & Slidebox Construction
- ▶ One-Piece Automotive Painted Fiberglass Frontcap
- ▶ Cabover Bunk
- ▶ Cabover Cargo Net
- ▶ Slide-Out Toppers
- ▶ (2) 12V TVs
- ▶ Convection Microwave
- ▶ Portable Induction Cooktop
- ▶ Premium Subway Tile Backsplash
- ▶ Deep Well Stainless Steel Sink
- ▶ Rear & Sideview Camera System w/ Display
- ▶ Apple Carplay/Android Auto Ready Dash Display
- ▶ Maxx Air Fan w/ Remote Control & Rain Sensor
- ▶ 4000 Watt Generator
- ▶ 15k AC
- ▶ Arctic Package
- ▶ Dicor Diflex II TPO Roof Membrane
- ▶ 12V USB Charge Ports
- ▶ 81" Interior Ceiling Height
- ▶ Driver & Passenger Swivel Seats
- ▶ Side Port Solar Panel Hookup
- ▶ Inverter Prep
- ▶ 4000lbs Tow Capacity

## Alita Value Package

- ▶ Luxury Legless Girard Awning w/ LED Light Strip
- ▶ Panoramic Frameless Windows w/ Integrated Day/Night Shades
- ▶ Slam Latch Baggage Doors
- ▶ On-Demand Hot Water Heater
- ▶ Solid Surface Countertops w/ Kitchen Countertop Extension
- ▶ 15k Ducted AC
- ▶ Induction Cooktop
- ▶ Azdel Composite Sidewall & Slidebox Construction
- ▶ 12V Tank Heat Pads
- ▶ Winegard Air 360+ Antenna w/ Integrated WiFi Prep
- ▶ 12V Smart TV
- ▶ 6 cu./ft. 12V Refrigerator
- ▶ Black Tank Flush
- ▶ Exterior LP Quick Connect
- ▶ Exterior TV Hookups
- ▶ Rotocast Exterior Storage Compartments
- ▶ Flush Floor Main Floor Construction

## Alita Options

- ▶ Solar Charge Package
- ▶ Luxury Powered Theatre Seats

## Alita Solar Overview

Gain more camping flexibility with your 12V systems such as refrigerator, TV, and lights. Keeps your 12V house batteries at a healthy charge to extend life, increase performance, and save money!

- ▶ 200 watt Monocrystalline Solar Panel
- ▶ 30-amp Charge Controller w/ LED Display
- ▶ (2) 12V Battery Installed in Step Well

## All New From Ford – AWD 350 Transit Chassis

- ▶ 3.5L EcoBoost V6 Engine touting 310HP
- ▶ 10-Speed Automatic SelectShift Transmission
- ▶ 400 lb./ft. Torque
- ▶ Xenon HID Headlights
- ▶ 178" Wheelbase
- ▶ 3 year/36,000 mile chassis warranty
- ▶ 5 year/60,000 mile powertrain warranty



**Girard Legless Awning w/ LED Light Strip**



**4000 Watt Generator**



**Slide Topper**



**Residential Bathroom**



**12V 40" Bedroom TV**

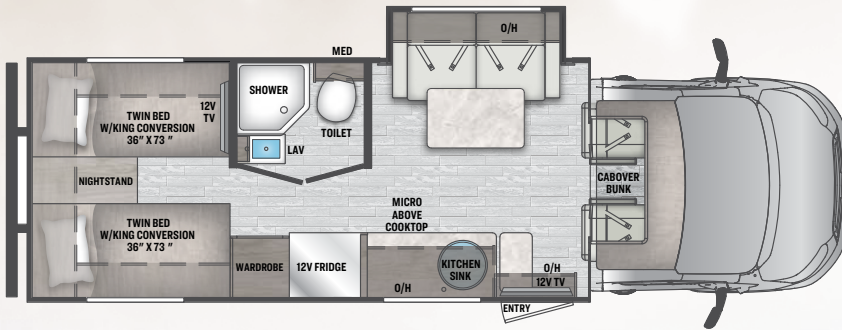

## 23 TK Specifications

Engine	<b>3.5L EcoBoost V6 Engine</b>	CCC (Lbs.)	<b>1070</b>	Interior Square Footage	<b>167</b>
Transmission	<b>10-Speed Automatic Overdrive w/ SelectShift</b>	Fuel Capacity (Gal.)	<b>25</b>	Fresh Water (Gal.)	<b>35</b>
Wheel Base	<b>178"</b>	Hitch Rating	<b>4,000</b>	Grey Holding Tank Capacity (Gal.)	<b>30</b>
GVWR (Lbs.)	<b>11,000</b>	Tongue Weight	<b>300</b>	Black Holding Tank Capacity (Gal.)	<b>30</b>
GAWRR (Lbs.)	<b>4360</b>	Length Bumper to Bumper	<b>25' 11"</b>	L.P. Capacity (Gal.)	<b>19.3</b>
GAWRF (Lbs.)	<b>7275</b>	Exterior Height w/ A/C	<b>11' 4"</b>	Awning Length	<b>16'</b>
UVW (Lbs.)	<b>9688</b>	Exterior Width	<b>90.5"</b>	Exterior Storage (Cu. Ft.)	<b>42</b>
GCWR (Lbs.)	<b>13500</b>	Interior Width	<b>87"</b>		
		Interior Height	<b>81"</b>		



**Rear Bedroom (Two Twin Beds that Easily Convert into One King Size Bed)**

**OUR COMPANY TAKES PRIDE IN OUR FIVE GUIDING PRINCIPLES AND OUR CORPORATE PHILOSOPHY**  
 which focuses on people working together to create high quality, value-added products that deliver the ultimate RV experience.

**Sustainable Manufacturing**

An important objective to our strategy and operations is to implement economically sound manufacturing processes to reduce/ recycle waste & conserve energy and natural resources.

**Corporate & Social Responsibility**

We foster a business environment in which we focus on and practice:

- Ethical Labor Practices
- Teamwork
- Philanthropy
- Volunteering

**Culture & Values**

We are a forward thinking company committed to fostering a culture of teamwork. By being transparent, we encourage our employees to think outside the box and make a difference!

**Quality & Construction**

Our team takes pride in each unit we build. Our manufacturing standards and point to point inspections ensure each EAST TO WEST brand is built to the same quality specifications every time.

**Our Commitment**

We strive to provide the highest quality products at the best possible price to our customers. We invite you to be a part of the EAST TO WEST family and we look forward to exceeding your expectations!



**24/7 EMERGENCY  
 ROADSIDE ASSISTANCE  
 WITH VEHICLE PURCHASE\***

TOWING  
 JUMP-STARTS  
 TIRE CHANGES  
 FLUID DELIVERY  
 LOCKOUT  
 SERVICE

WINCH-OUT  
 MOBILE MECHANIC  
 TECHNICAL  
 SUPPORT  
 DEALER LOCATOR  
 SERVICES



\*VALID FOR 1 YEAR FROM DATE OF PURCHASE



**Learn More**  
 Scan this barcode using a QR Reader on your smart phone to learn more about Forest River.



A Berkshire Hathaway company.

3000 COUNTY ROAD 6 WEST ELKHART, IN 46514  
 WWW.EASTTOWESTRV.COM 574.264.6664

**FREE MEMBERSHIP**  
 to Forest River Owners' Group

www.forestriverfrog.com



East To West RV



@easttowestr

**CUSTOMER SATISFACTION**



www.ForestRiverBuyLocal.com



**PRE-DELIVERY INSPECTION FACILITY**

20,000 square feet of quality assurance. The bare essentials for a premium product. This state-of-the-art facility gives immediate daily feedback to production for quality assurance in every unit built.

**SPECIFICATION DEFINITIONS**

**GVWR (Gross Vehicle Weight Rating)** - is the maximum permissible weight of the unit when fully loaded. It includes all weights, inclusive of all fluids, cargo, optional equipment and accessories. For safety and product performance do NOT exceed the GVWR.

**GAWR (Gross Axle Weight Rating)** - is the maximum permissible weight, including cargo, fluids, optional equipment and accessories that can be safely supported by a combination of all axles.

**UVW (Unloaded Vehicle Weight)\*** - is the typical weight of the unit as manufactured at the factory. It includes all weight at the unit's axle(s) and tongue or pin and LP Gas. The UVW does not include cargo, fresh potable water, additional optional equipment or dealer installed accessories.

\*Estimated average based on standard build optional equipment.

**CCC (Cargo Carrying Capacity)\*\*** - is the amount of weight available for fresh potable water, cargo, additional optional equipment and accessories. CCC is equal to GVWR minus UVW. Available CCC should accommodate fresh potable water (8.3 lbs per gallon). Before filling the fresh water tank, empty the black and gray tanks to provide for more cargo capacity.

\*\* Estimated average based on standard build optional equipment

Each Forest River RV is weighed at the manufacturing facility prior to shipping. A label identifying the unloaded vehicle weight of the actual unit and the cargo carrying capacity is applied to every Forest River RV prior to leaving our facilities.

The load capacity of your unit is designated by weight, not by volume, so you cannot necessarily use all available space when loading your unit.

YOUR **ALITA** DEALER

All information contained in this brochure is believed to be accurate at the time of publication. However, during the model year, it may be necessary to make revisions and Forest River, Inc., reserves the right to make all such changes without notice, including prices, colors, materials, equipment and specifications as well as the addition of new models and the discontinuance of models shown in this brochure. Therefore, please consult with your Forest River dealer and confirm the existence of any materials, design or specifications that are material to your purchase decision. Litho. U.S.A.  
 FTW 2434 P&W: 2024.02.19