

Jayco | 2024 Jay Flight Travel Trailer

JAY FLIGHT

#1 SELLING TRAVEL TRAILER FOR 15 YEARS



2+3
YEAR | YEAR
WARRANTY

INTERIOR DESIGN



CLASSIC FARMHOUSE



Main Wood



Accent Wood



Floor

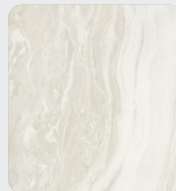

Countertop



Main Fabric



Accent Fabric

212QB



224BH



225MLS

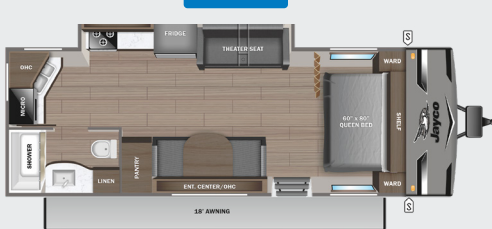

235MBH

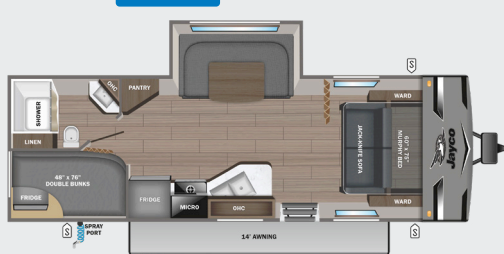

236TH

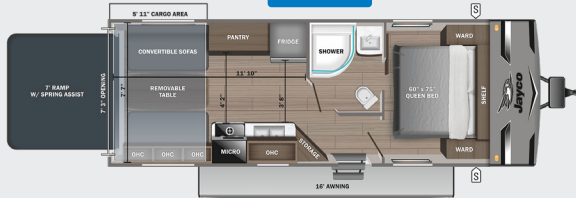

240RBS OPTION: A

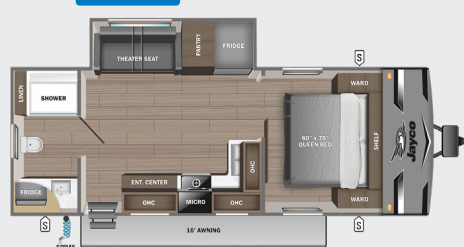

247RBS

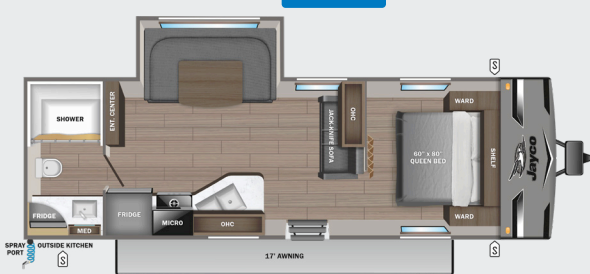

263RBS OPTION: A

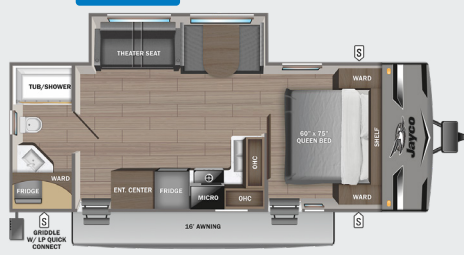

264BH



265RLS OPTIONS: A, B, C



OPTIONS

- STORAGE
- MICRO MICROWAVE
- OHC OVERHEAD CABINETS
- FRIDGE REFRIGERATOR
- WARD WARDROBE

- A**

Hide-a-Bed
- B**

Table & Chairs
- C**

Theater Seat

265TH

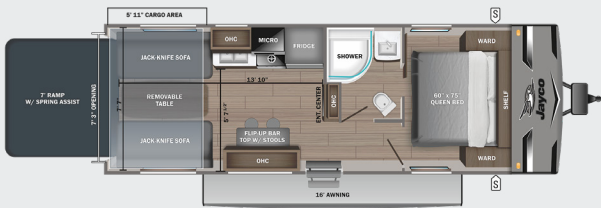

267BHS OPTIONS: A, C

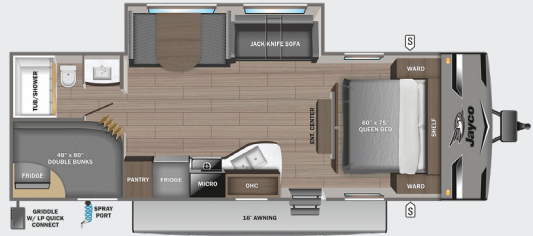

274BH



280BHK OPTIONS: A, C

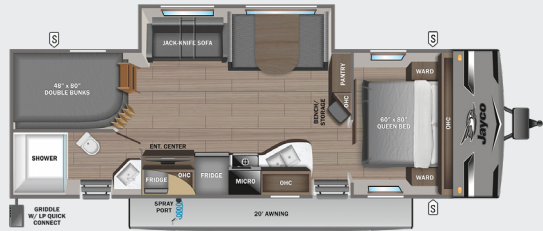

280RKS OPTIONS: A, B, C

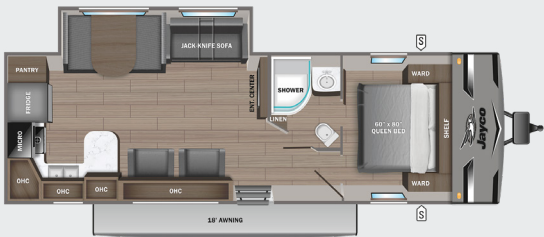

284BHS OPTIONS: A, C

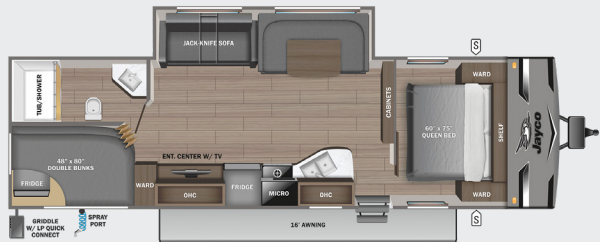

285BHS OPTIONS: A, C







294QBS OPTIONS: A, C



324BDS OPTIONS: A, C, D



OPTIONS

-  STORAGE
-  MICRO MICROWAVE
-  OHC OVERHEAD CABINETS
-  FRIDGE REFRIGERATOR
-  WARD WARDROBE

A

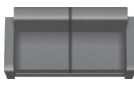

Hide-a-Bed

B

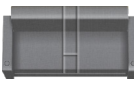



Table & Chairs

C



Theater Seat

D

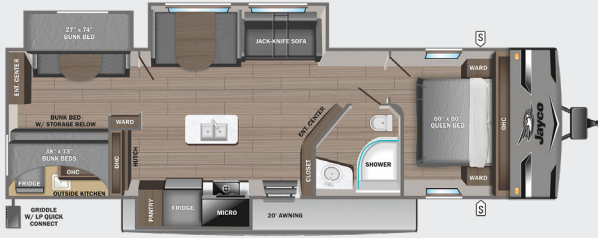
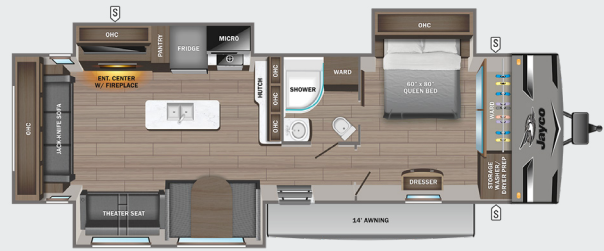

Jackknife Sofa

331BTS OPTIONS: A, D

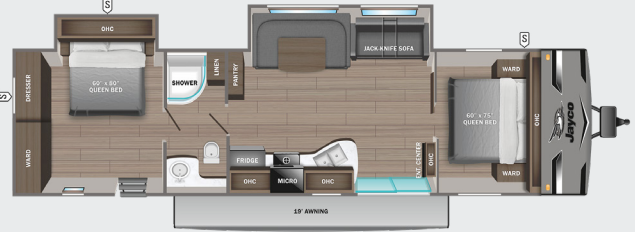
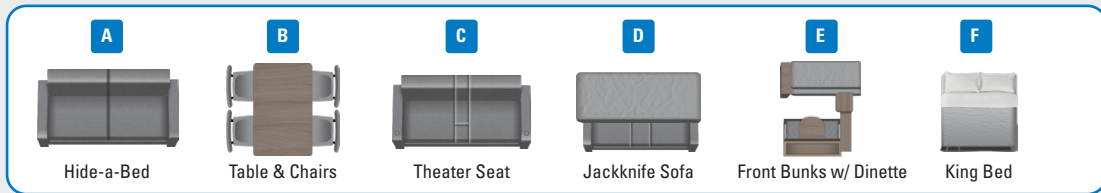
334RTS OPTIONS: A, B, F

340RLK OPTIONS: A, F

380DQS OPTIONS: A, C, E, F

OPTIONS

*Indicates split tanks

FLOORPLAN	EXTERIOR TRAVEL LENGTH	EXTERIOR WIDTH	EXTERIOR HEIGHT (WITH A/C)	INTERIOR HEIGHT	UNLOADED VEHICLE WEIGHT	DRY HITCH WEIGHT	GVWR	CARGO CARRYING CAPACITY	FRESH WATER CAPACITY (INCLUDING WATER HEATER)	GRAY WASTE WATER CAPACITY	BLACK WASTE WATER CAPACITY	SLEEPING CAPACITY
212QB	25' 8"	8' 0"	10' 7"	6' 9"	4,390	520	5,675	1,285	52	39	33	3-5
224BH	27' 1"	8' 0"	10' 7"	6' 9"	4,585	525	5,850	1,265	52	39	39	6-8
225MLS	27' 1"	8' 0"	11' 1"	6' 9"	5,300	580	6,700	1,400	52	39	39	1-3
235MBH	27' 10"	8' 0"	11' 1"	6' 9"	5,660	680	6,850	1,190	52	39	39	5-7
236TH	28' 4"	8' 0"	10' 6"	6' 9"	5,060	885	7,500	2,440	52	39	39	2-4
240RBS	27' 4"	8' 0"	11' 0"	6' 9"	5,690	715	7,000	1,310	52	78*	39	2-4
247RBS	28' 10"	8' 0"	11' 1"	6' 9"	5,480	650	6,750	1,270	52	39	39	3-5
263RBS	30' 1"	8' 0"	11' 2"	6' 9"	6,055	810	7,500	1,445	52	78*	39	3-5
264BH	29' 5"	8' 0"	10' 6"	6' 9"	4,755	560	6,200	1,445	52	39	39	7-9
265RLS	31' 1"	8' 0"	11' 1"	6' 9"	6,175	800	7,500	1,325	52	39	39	4-6
265TH	30' 4"	8' 0"	10' 6"	6' 9"	5,320	850	7,600	2,280	52	39	39	4-6
267BHS	30' 4"	8' 0"	11' 2"	6' 9"	5,850	760	7,100	1,250	52	39	39	8-10
274BH	30' 7"	8' 0"	10' 7"	6' 9"	5,165	660	6,500	1,335	52	78*	39	7-9
280BHK	34' 7"	8' 0"	11' 3"	6' 9"	6,660	800	8,250	1,590	52	78*	39	7-9
280RKS	33' 10"	8' 0"	11' 3"	6' 9"	6,525	850	8,150	1,625	52	78*	39	4-6
284BHS	33' 7"	8' 0"	11' 1"	6' 9"	6,365	880	7,950	1,585	52	39	39	8-10
285BHS	33' 4"	8' 0"	11' 4"	6' 9"	6,510	875	8,150	1,640	52	78*	39	6-8
294QBS	35' 7"	8' 0"	11' 3"	6' 9"	6,655	870	8,250	1,595	52	39	39	8-10
324BDS	36' 4"	8' 0"	11' 3"	6' 9"	7,635	1,050	9,000	1,365	52	32.5	39	8-10
331BTS	37' 10"	8' 0"	11' 3"	6' 9"	8,635	1,210	9,995	1,360	52	71.5*	39	6-8
334RTS	37' 10"	8' 0"	11' 2"	6' 9"	8,660	1,190	10,250	1,590	52	71.5*	39	3-5
340RLK	37' 10"	8' 0"	11' 3"	6' 9"	8,890	1,235	10,350	1,460	52	71.5*	39	2-4
380DQS	40' 4"	8' 0"	11' 3"	6' 9"	8,375	1,005	9,995	1,620	52	39	39	3-5

Some specs at the time of print may include estimates. For the most updated information, please visit Jayco.com

STANDARDS & OPTIONS

EXTERIOR

20 lb. propane bottles with cover (2)
30-amp service
5/8 in. tongue-and-groove plywood floor decking
Axles with electric, self-adjusting brakes and easy-lube hubs
Enclosed and heated underbelly
Exterior TV mount and bracket
Front diamond plate
Fully integrated A-frame
Galvanized steel, impact-resistant wheel wells
I-Class™ cambered structural steel I-beams
Large exterior downspouts
Propane quick connect (outside gas grill prep)
Magnum Truss™ Roof system with plywood decking
PVC roofing membrane (limited lifetime warranty)

INTERIOR

300 lb. rated bunk beds (select models)
4 in. thick bunk mats (select models)
600 lb. rated bunk beds (double bunks)
8 cu. ft. 12V refrigerator
81 in. ceiling height
Heavy-duty, 75 lb., full-extension, steel ball-bearing drawer guides
J-Steel™ jackknife sofa with armrest and cup holders (most models)
Main bed struts
Plywood bed platforms
Privacy curtains in bunk areas (select models)
Queen mattress
Residential-style kitchen countertops
Shower curtain with curved shower track (select models)
Shower/tub surround

Smoked-glass cabinet door inserts (select models)
Solid hardwood cabinet doors
USB charging station
Vented bunk windows (select models)
Vinyl flooring throughout (including slide floors)
Window shades
Wooden bedroom doors (select models)

CUSTOMER VALUE PACKAGE (MANDATORY)

13.5K BTU A/C
AM/FM/Bluetooth® stereo
Backup and side view camera prep
Bathroom medicine cabinet
Bathroom power vent
Bathroom skylight
Black tank flush
Detachable power cord
Fitted bed sheet
Friction hinge entry door with window and shade prep
G20 dark tinted privacy windows
Goodyear® Endurance® tires (made in the USA)
Inverter pre-wire
Keyed-Alike™ entry and baggage doors
Large main entry door grab handle
LED exterior and interior lights
Marine grade exterior speakers
Microwave oven
On-demand tankless water heater
One-piece front fiberglass exterior wall
Outside shower
Oven with 3-burner recessed cooktop with glass cover
Overlander 1 Solar Package: (1) 200W solar panel and 30-amp digital controller

Power awning with LED lights
Power tongue jack
Range hood
Rock-Solid Stabilizer System
Seamless countertops
Sink cover
Solid Step® entry steps (N/A 380DQS)
Spare tire with cover

OPTIONS

15,000 BTU A/C
2nd A/C in bedroom (select models)
50-amp service (select models)
Chil N' Stor (264BH)
Fiberglass sidewalls (select models)
Front bunks with dinette (380DQS)
Hide-a-bed with tri-fold mattress (select models)
King bed (340RLK, 334RTS, 380DQS)
LED Smart TV (standard on 284BHS, 334RTS, 340RLK)
Outside griddle with bumper mount (select models)
Rear sofa with folding bunk (331BTS)
Roof ladder (N/A 236TH and 265TH)

Meet your Jayco Dealer



Some specs at the time of print may include estimates. For the most updated information, please visit [Jayco.com](https://www.jayco.com)

Jayco, Inc. | P.O. Box 460 | Middlebury, IN 46540

See dealer for further information and prices. All information in this brochure and on www.jayco.com is the latest available at the time of publication approval. Jayco reserves the right to make changes and to discontinue models without notice or obligation. Photography may show optional equipment or props used for decoration purposes only. RVs built for sale in Canada may differ to conform to Canadian codes. JAYCO and the JAYCO BIRD IN FLIGHT are registered trademarks of Jayco, Inc. Printed in USA 3/24 ©2024 Jayco, Inc.



Jayco - Part of Jayco Family of Companies