

*Vintage*  
CRUISER



*The Best of the Old  
and the Best of the New  
- Together at last!*



# Vintage CRUISER

Every feature of the Vintage Cruiser recalls the flat-out fun of the 50's - But don't worry, state-of-the-art luxuries are here too, including the all-important microwave oven, a Blue Tooth home theater system, cool, efficient LED lights, USB charging ports, and wiring for satellite, cable, solar power and HDTV.

Take your pick! Teal & Cream, Crimson & Cream, and the Knotty Pine Estate Wagon option - Any way you go, you'll take the fun of the 50's with you.

*The fun of the 50's,  
the technology of the 21st Century!*



## Cozy, colorful living spaces

Bright, cheery upholstery brings charm and inviting warmth to the living spaces of the Vintage Cruiser, while huge windows frame picture-postcard views. Whether you choose the standard interior or our optional "Woody" with Knotty Pine paneling, you'll love the smart use of space and thoughtful features we've included.

Shown here: A) Main living area of 23MBS, with U-shaped dinette in slide-out, large kitchen counter with double-bowl sink, and Murphy bed ready for a good night's sleep.

B) Murphy bed sofa with handy side tables, hanging closets, individual two-way reading lights, two windows, and optional Knotty Pine paneling. (19MBS shown; 23BHS and 23MBS are similar.)

C) Convertible sofa with laminated end tables and overhead corner cabinets in slide-out of the 23RSS.







## *Now you're cookin'!*

Whether you're entertaining new-found friends, cooking for family, or just fixing a snack, you'll love the way meals come together in your Vintage Cruiser.

You get your dream kitchen in every floor plan, with stainless steel appliances, stylish tile backsplash, big double-door refrigerator/freezer, master-crafted cabinetry, bright LED lighting, 110 volt and USB outlets, large sink with hi-arc faucet, and a cheery kitchen window.

Shown here: D) 19RBS (19MBS is similar); E) 23QBS (23MBS, 23BHS, and 23FBS are similar); F) 19ERD; G and H) Examples of Kitchen Pantry and Cabinet drawers.







Shown on this page: A) 19ERD, with picture windows on three sides, overhead cabinet, designer light fixtures, and folding picnic table.

B) Cool blue LED atmosphere/night lights.

C) Party-size U-shaped dinette with under-seat storage and large picture window. (23BHS shown, 23RBS, 23MBS, 23FBS are similar.)

D) Table for four with designer lights, extensive overhead storage, and optional Knotty Pine paneling. (19RBS shown, 19MBS is similar.)

## *Camp life revolves around your Vintage Cruiser dinette*

Rainy day card games, late night heart-to-hearts, breakfast at dawn, happy hour with new-found friends, crafts, email, and TV - Everything happens here!





E.



Shown on this page: E) The 60" x 74" bed as featured in the master bedroom of the 19ERD, 19RBS, 19CSK, 23RSS, 23QBS, and 23FBS; with his 'n hers hanging closets, night-stands with 110 volt and USB outlets, two-way LED reading lights, overhead cabinet, under-bed storage, two windows, and custom bedspread with pillow shams.

F) Upper and lower bunks for young campers, with reading lights, power plugs, and cushy bunk mattresses; also multi-speaker home theater stereo and hookups for optional HDTV, with swing-arm mount, all in the 23BHS and 23QBS.

G) Comfy sofa becomes a base and end tables turn into night stands for the Murphy bed stowed in the front wall space.

H) Ingenious Murphy bed unfolds in seconds to turn your living room into your bedroom; as featured in the 19BFD, 19MBS, 23BHS, and 23MBS.

## Great beds, sweet dreams

Whether your day is filled with adventure or relaxation, you'll get a good night's sleep in your Vintage Cruiser.



F.

G.



H.









# Floor Plans

With 20- to 23-foot models on single axles, 26-foot models on double axles, 60" x 74" owner's beds, ingenious Murphy beds, and kid-friendly bunks, Vintage Cruiser truly offers something for everyone. Find yours!

**17RWD**

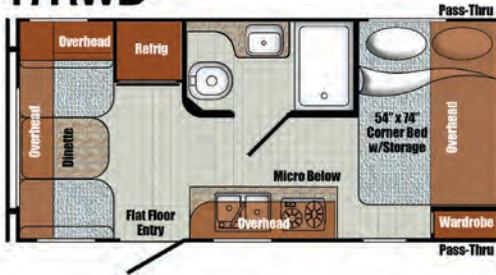

**19RBS**

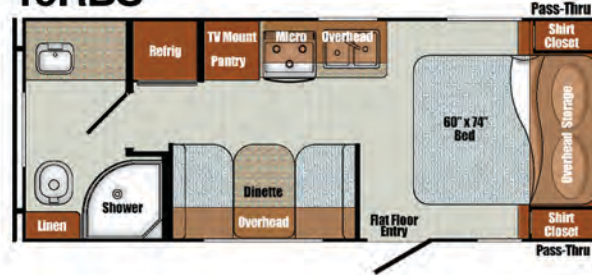

**23BHS**

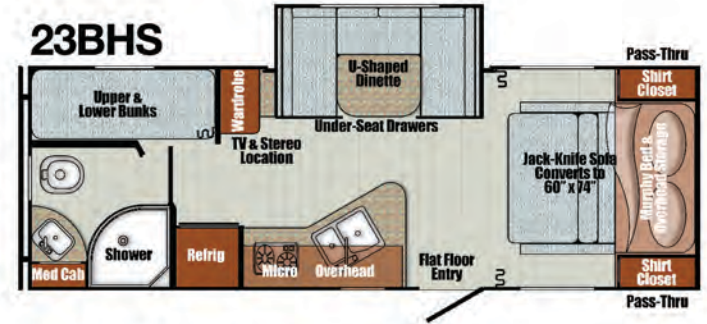

**17SCD**



**19MBS**

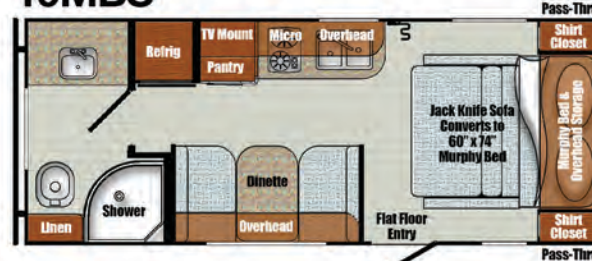

**23QBS**

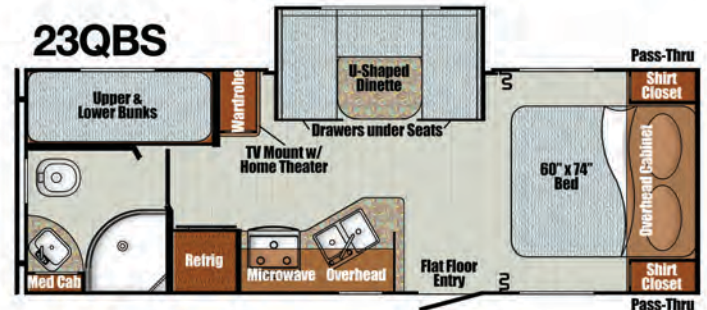

**19ERD**

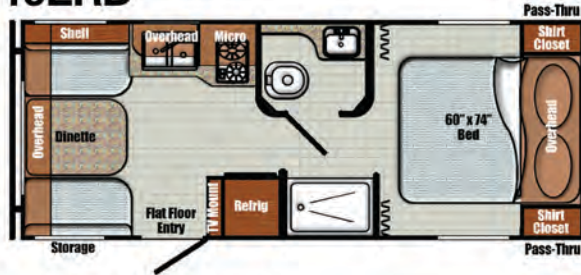

**19BFD**

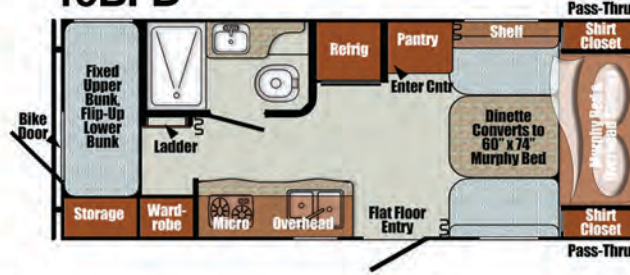

**23MBS**

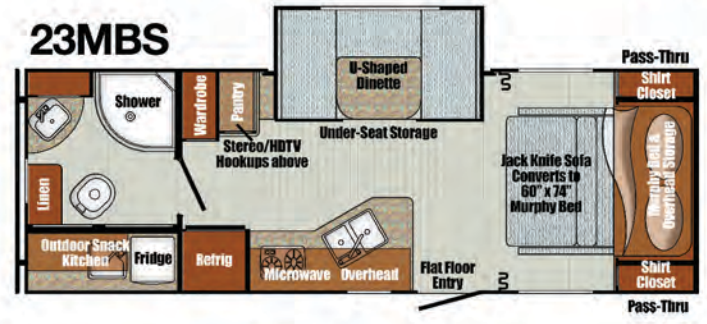

**19CSK**

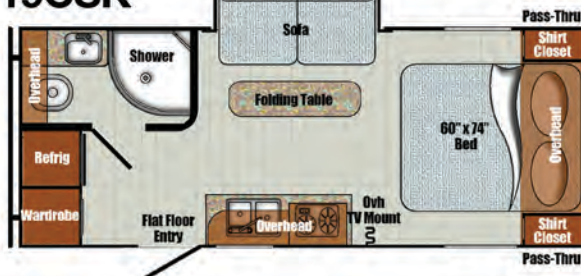

**23RSS**

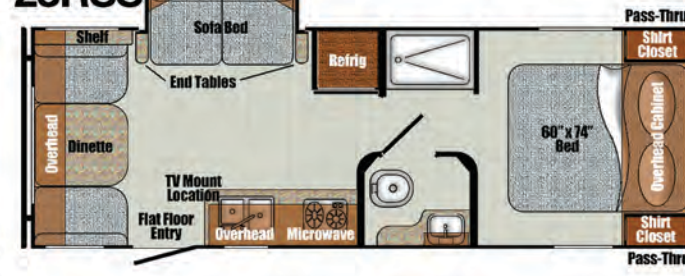

**23FBS**

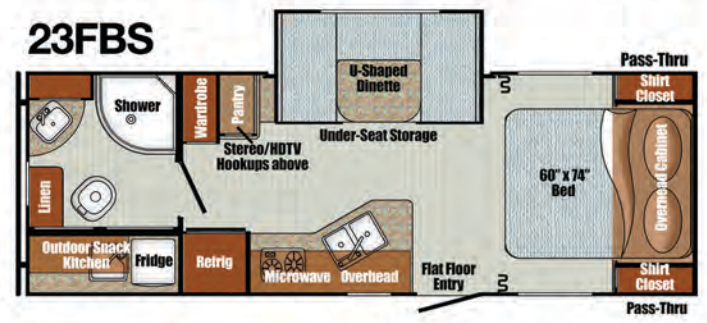



## Standard Features

### Decor

- High-Performance Vinyl Flooring
- Easy-Care Wall & Ceiling Vinyl
- Wood Cabinet Stiles, Pocket-Screwed Frames

### Heating & Cooling

- Prewired for Roof Air Conditioner
- 20,000 BTU Furnace w/Wall Thermostat (16,000 BTU on 17RWD, 17SCD)
- 6 Gal DSI Gas Water Heater

### Safety

- Break-Away Switch; Safety Chains
- Wall-Mount Fire Extinguisher
- Smoke Detector, Combo LP & CO Detector

### Electrical/Power

- Satellite & Cable-Ready Prep
- Multiple USB Charging Ports
- Monitor Panel
- Hitch Light
- LED Running Lights
- LED Pass Through Storage Light w/Switch
- LED Step Light w/Switch
- LED Interior Ceiling Lights
- Non-Directional TV Antenna w/Booster
- Solar-Ready & Back-Up Camera Prep
- 30 Amp 30' Power Cord w/Storage
- 35 Amp Converter/Charger w/LED lights
- Power Range Hood w/Light

### Bath

- Foot Flush Toilet
- High Velocity Bath Vent
- Wood Medicine Cabinet w/Mirror
- Tub/Shower Surround
- 24" x 36" Tub/Shower (17RWD, 19ERD, 19BFD, 23RSS)
- 32" Radial Shower (17SCD, 19RBS, 19MBS, 19CSK, 23BHS, 23QBS, 23MBS, 23FBS)

### Furnishing

- Booth Dinette (17RWD, 19ERD, 19RBS, 19MBS, 23RSS; 2-Person in 17SCD)
- U-Shaped Dinette (23BHS, 23QBS, 23MBS, 23FBS)
- 60" x 74" Walkaround Bed (19ERD, 19RBS, 19CSK, 23RSS, 23QBS, 23FBS)
- 54" x 74" Corner Bed (17RWD, 17SCD)
- 60" x 74" Murphy Bed (19BFD, 19MBS, 23BHS, 23MBS)
- 28" x 74" Bunks (19BFD, 23BHS, 23QBS)

### Windows & Doors

- Friction Hinged Entry Door
- Black Radius Tinted Windows
- Radius Storage Doors w/Magnetic Catches

### Exterior

- One Piece Fiberglass Roof, Front/Rear Walls
- Six-Sided Welded Aluminum Frame, Vacuum Bonded Walls
- Light Weight Chassis
- Laminated Floor w/Lauan Substrate
- Laminated Fiberglass Sidewalls w/exterior layer of Azdel Composite Substrate
- Easy-Lube Axles
- In-Floor Spare Tire Storage under Bed

## Popular Options

- 3-Burner Range w/Oven (N/A 17SCD)
- Interior & Exterior TV Mounting Brackets
- 19" or 32" LED HDTV
- Rear Bumper Mount Gas Grill (N/A 19BFD)
- Power Tongue Jack in place of Manual Jack
- Glass Shower Door (19RBS, 19MBS, 19CSK, 23BHS, 23QBS, 23MBS, 23FBS)
- Soft-Touch Shower Door (17RWD, 19ERD, 19BFD, 23RSS)
- Electric Awning w/LED Awning Light and Outdoor Speakers (Required)
- 13,500 BTU Air Conditioner (non-ducted)
- Blue Tooth Home Theater Stereo w/Speakers
- Premium Foam Mattress
- Wide White-Wall Radial Tires
- 14" Spare Tire
- Outside Spray Port
- 6 Gal DSI Gas/Electric Water Heater
- Sink Covers
- Black Tank Flush
- "Solid Step" for Entry Door

Specifications, materials, & standard features are subject to change without further notice. Not responsible for typographical errors. Some items shown are extra cost options. Visit [www.gulfstreamcoach.com](http://www.gulfstreamcoach.com) or check with a local dealer for more information. ©Gulf Stream Coach, Nappanee, IN USA \* #VIN012019

## Vintage Package

You get all this! (Included, Required)

- Vintage Exterior Graphics w/Oyster Glass
- Vintage Painted Bumper, A-Frame & Radius Metal, Fender Skirts, & Rims
- 14" Radial Tires w/Moon Hubcaps
- Front & Rear Brushed Aluminum Diamond Plate
- All Woodgrain Interior
- Pearl Fabric Shower Curtain
- Cream Countertop w/Self-Edging
- Bedroom Reading Lights
- Stainless Microwave & 2-Burner Cooktop w/Cover
- 6 cu. ft. Double Door Refrigerator/Freezer (5.0 ft. in 17RWD, 17SCD)
- Vintage Flat Cabinet Doors
- Vintage Dinette
- Vintage Drapes w/Decorative Rods
- Vintage Custom Comforter w/Vintage Logo Pillow Shams
- Vintage Dinette Trumpet Light

# Vintage CRUISER

## "Woody" Package Option

We've captured the nostalgic look of a rustic cabin in our "Woody" package with:

- Oyster Painted A-Frame, Bumper, Wheels
- Slate Radius Metal
- Woody Fender Skirts and Graphics
- Hickory Saddle Floor Vinyl
- Southern Pine Sidewalls and Rear Wall
- Southern Pine Cabinets & Cabinet Doors
- Woody Curtain Package



## Meet "The Vintage Cruisers"

You'll find this friendly, helpful, active group of over 1,000 Vintage Cruiser owners on Facebook. Just search for "The Vintage Cruisers." Better yet, choose a Vintage Cruiser of your own and join in the fun!



QUALITY • INNOVATION • VALUE

503 South Oakland Avenue  
Nappanee, IN 46550  
[www.gulfstreamcoach.com](http://www.gulfstreamcoach.com)

Your Gulf Stream Coach Dealer.