

Jayco | 2024 Eagle Fifth Wheel

# EAGLE FW

ADVENTURES AROUND EVERY BEND



**2+3**  
YEAR | YEAR  
WARRANTY



# INTERIOR DESIGN



## CLASSIC FARMHOUSE



Main Wood



Accent Wood



Floor

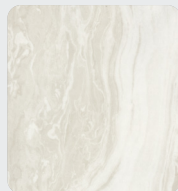

Countertop

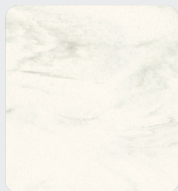

Comfort Plus Package Countertop

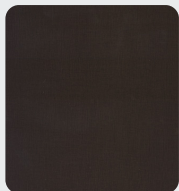

Main Fabric



Accent Fabric

**28.5RSTS** OPTIONS: A, B

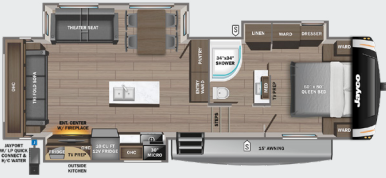

**29.5BHDS** OPTIONS: A, C, D

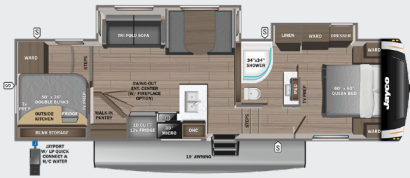

**29.5BHOK** OPTIONS: A, C, D

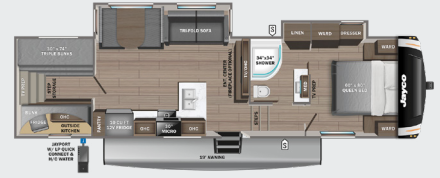

**30.5RSOK** OPTION: A



**31MB**

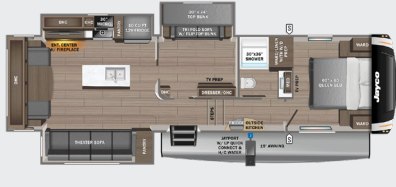

**317RLOK** OPTIONS: A, B, E

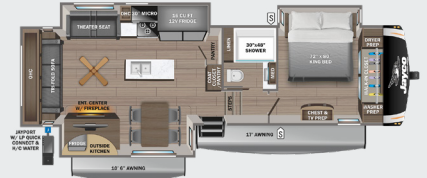

**319MLOK** OPTIONS: A, B, E

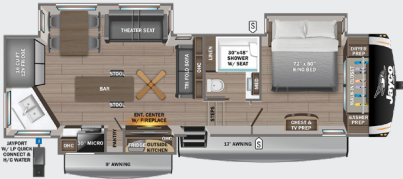

**321RSTS** OPTIONS: A, B, E

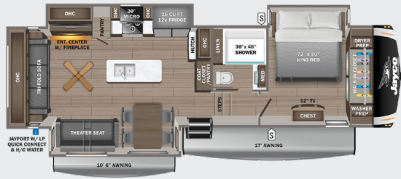

**335RDOK** OPTION: E



**355MBQS** OPTIONS: A, B, E

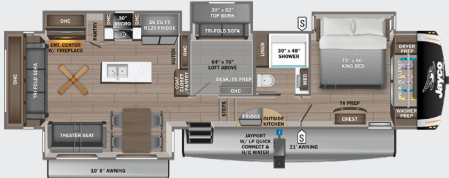

**360DBOK** OPTIONS: B, E

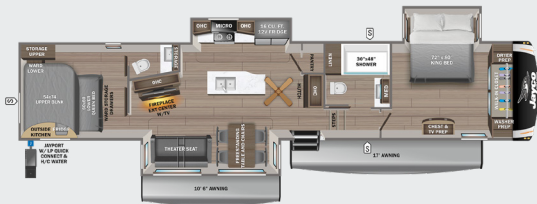

**370FBTS** OPTIONS: A, B, E, F

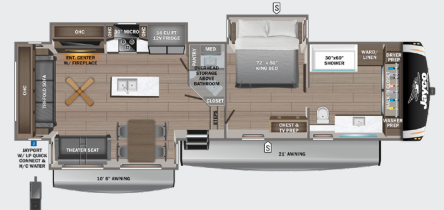

**OPTIONS**

**A**



Table & Chairs/Bench

**B**



Dinette

**C**



Theater Seat

**D**



Table & Chairs

**E**



Queen Bed

**F**



Griddle/Sink



**MICRO**

**OHC**

**FRIDGE**

**WARD**

STORAGE

MICROWAVE

OVERHEAD CABINETS

REFRIGERATOR

WARDROBE

# STANDARDS & OPTIONS

## EXTERIOR

1.5 in fresh water drain valve  
 5 in. Magnum Truss™ Roof System with Alpha roof membrane system with limited lifetime warranty  
 50-amp detachable power cord  
 LED lighting in pass through area with 3-way switches  
 Auto-grade vinyl graphics  
 Automotive style front cap with max turn radius (painted on select models)  
 Battery disconnect in pass through area  
 Black tank flush  
 Climate Shield™ zero-degree tested weather protection:  
 - Fully enclosed and heated underbelly (ducted)  
 - 35,000 BTU furnace  
 - Double layer fiberglass batt insulation in ceiling and floor  
 - Double sided radiant barrier insulation (roof, floor and behind cap)  
 - PEX plumbing  
 Commercial grade rubber flooring in pass through area  
 Digital TV antenna with WiFi prep  
 Dual 30 lb. propane bottles  
 Dual channel exterior speaker  
 Factory installed roof ladder  
 Galvanized steel coated outside kitchens  
 HELIX Cooling System™ (industry exclusive):  
 - Jayco exclusive insulated duct design  
 - Directional and closeable A/C vents  
 - Larger return air vents with user accessible filters  
 Independent satellite and cable hookups  
 JaySMART™ (Safety Marker And Reverse Travel) exterior LED lights  
 LED exterior lighting package  
 Propane quick connect for gas griddle (next to JayPort)  
 Metal slam latch baggage doors  
 Nautilus 2.5 water connections  
 Nitrogen filled undermount spare tire (model/option varies 15 in. or 16 in.)  
 Quick connect water connections (door side hot/cold and off door side cold only)  
 Slide topper/awning prep  
 Stronghold VBL™ walls (laminated sidewalls, rear walls and slide out walls)

## INTERIOR

2-piece high gloss bathroom surround  
 5/8 in. tongue-and-groove plywood flooring  
 75 lb. full extension drawer guides  
 90 in. x 92 in. residential quilted bedspread (both queen and king mattresses)  
 Bathroom skylight  
 Bedroom TV prep  
 C.P.A.P. prepped bedroom  
 Extra 120V power outlets in kitchen and slide rooms (where applicable)  
 Furniture cup holder tables (1 pair)  
 Gas strutted under bed storage  
 Handcrafted and glazed door/drawer fronts (new sizes)  
 Inverter pre-wire (multiple locations) (7) 110 outlets (6 USB's 12V)  
 LED backlit medicine cabinet with custom framed mirror

LED lights with dimmer switches and motion activated (throughout interior)  
 Matte black kitchen faucet with pull-out sprayer  
 Porcelain foot flush toilet  
 Residential 60 in. x 80 in. queen size mattress (28.5RSTS, 29.5BHDS, 29.5BHOK, 30.5RSOK, 31MB)  
 Residential vinyl flooring throughout  
 Solid hardwood slide fascia  
 Stainless steel kitchen sink  
 Theater seating (select models)  
 Tri-fold hide-a-bed sofa with residential memory foam sleep surface (select models)  
 USB charging ports (multiple locations throughout)

## CUSTOMER VALUE PACKAGE (MANDATORY)

15K BTU "Whisper Quiet" A/C and bedroom A/C prep  
 4K Ultra LED HD Smart TV in living room (43 in. on 28.5RSTS, 29.5BHDS, 29.5BHOK, 30.5RSOK, 31MB)  
 4K Ultra LED HD Smart TV in living room (50 in. on 317RLOK, 319MLOK, 321RSTS, 335RDOK, 355MBQS, 360DBOK, 370FBTS)  
 50-amp service with dual A/C ducts  
 60K on-demand water heater with mixing tank  
 Custom machined aluminum rims  
 Electric patio awning with integrated dimmable LED lights  
 GE 30 in. over-the-range black and stainless microwave with exhaust fan  
 GE black and stainless 21 in. range with edge to edge grates (28.5RSTS, 29.5BHDS, 29.5BHOK, 30.5RSOK, 31MB)  
 GE black and stainless 24 in. range with edge to edge grates (317RLOK, 319MLOK, 321RSTS, 335RDOK, 355MBQS, 360DBOK, 370FBTS)  
 Hidden hinges on cabinet doors  
 JBL Aura Bar 12V with Bluetooth® and dual HDMI (dual zone)  
 Keyed-Alike™ lock system  
 MORryde Step Above™ entrance steps (main entrance) with blue LED  
 Rain proof bathroom power vent  
 Rear 2 in. towing receiver (4-pin connector on fifth wheels only)  
 Security monitor prep (rear, sides and entrance door)  
 Upgraded friction hinge entrance door

## LUXURY PACKAGE (MANDATORY)

Blackout roller shades with reflective side throughout  
 Electric auto-leveling  
 GE 10 cu.ft. 12V refrigerator (28.5RSTS, 29.5BHDS, 29.5BHOK, 30.5RSOK, 31MB)  
 JAYCOMMAND® "Smart RV System" (Pro Tablet)  
 JayPort 2 in. mount (for outside accessories)  
 LED fireplace with 5,000 BTU electric space heater (select models)  
 MORryde Safe-T-Rail grab handle  
 Overlander 1 Solar Package (200W panel and 30-amp solar controller)  
 Residential style glass shower door  
 TPMS (Tire Pressure Monitoring System) in-stem monitoring  
 Washer/dryer prep (select models)

## 5-STAR HANDLING PACKAGE (MANDATORY)

Dexter® ABS brake system with anti-sway  
 Dexter® Axles with NEV-R-Adjust® brakes and E-Z Lube® hubs  
 Goodyear® Endurance® tires (load range E)  
 MORryde® CRE-3000™ rubberized suspension  
 Wet bolt fasteners with bronze bushings

## COMFORT PLUS PACKAGE (MANDATORY)

(317RLOK, 319MLOK, 321RSTS, 335RDOK, 355MBQS, 360DBOK, 370FBTS ONLY)  
 16 in. Endurance® Goodyear® wheels/tires  
 2nd 15,000 BTU "Whisper Quiet" A/C  
 BMPPro Bluetooth® light switches throughout  
 Drinking Water System (patented)  
 King bed (72 in. x 80 in.) mattress with under-bed storage  
 Larger exterior baggage door sizes  
 Second power awning with dimmable LED lights (N/A 335RDOK)  
 Solid surface kitchen countertop with bamboo sink covers and strainer  
 Upsized 16 cu.ft. 12V refrigerator  
 Upsized 34 in. LED fireplace with 5,000 BTU electric space heater  
 Upsized 50 in. 4K SMART LED TV in living room  
 Upsized GE 24 in. residential stove with 4-burner cooktop

## OPTIONS

15K bedroom A/C  
 22 in. outside griddle with deep sink attachment for JayPort system (select models)  
 360 degree security monitor kit with 7 in. view  
 Booth dinette (select models)  
 Dry Camping Package (generator prep and extra LP capacity)  
 Dual 40 lb. propane bottles (select models)  
 Extreme Weather Package with 120 heat pads (12V heat tape on fresh water)  
 Frameless dual pane windows  
 Free standing table with leaf and bench seat, 2 storage chairs and 2 folding chairs  
 Free standing table with leaf, 2 storage chairs and 2 folding chairs in place of booth dinette  
 LED fireplace with 5,000 BTU electric space heater (select models)  
 Overlander 2 Solar Package: (2) 200W panels, MPPT 30-amp solar controller and 1800W inverter)  
 Overlander 4 Solar Package: (4) 200W panels, (2) 100AH lithium batteries, 60-amp MPPT solar controller, 3000 W split phase inverter/charger, DC/DC power converter, soft start 15,000 A/C with heat pump, battery monitor, roof pre-wire solar, generator option, battery enclosed)  
 Residential 60 in. x 80 in. queen size mattress (317RLOK, 319MLOK, 321RSTS, 335RDOK, 355MBQS, 360DBOK, 370FBTS)  
 Residential 72 in. x 80 in. king size mattress (N/A 28.5RSTS, 29.5BHDS, 29.5BHOK, 30.5RSOK, 31MB)  
 Theater seating in place of tri-fold sofa (select models)

\*Indicates split tanks

FLOORPLAN	TOTAL EXTERIOR LENGTH	EXTERIOR WIDTH	EXTERIOR HEIGHT (WITH A/C)	INTERIOR HEIGHT (MAIN)	INTERIOR HEIGHT (UPPER DECK)	UNLOADED VEHICLE WEIGHT	DRY HITCH WEIGHT	GVWR	CARGO CARRYING CAPACITY	FRESH WATER CAPACITY	GRAY WASTE WATER CAPACITY	BLACK WASTE WATER CAPACITY	SLEEPING CAPACITY
28.5RSTS	32' 10"	8' 1"	12' 5"	8' 5"	6' 3"	9,420	1,870	11,500	1,980	81	82*	45	4-6
29.5BHDS	34' 7"	8' 1"	13' 0"	8' 5"	6' 3"	9,540	1,955	11,500	1,960	81	82*	45	8-10
29.5BHOK	35' 5"	8' 1"	13' 0"	8' 5"	6' 3"	9,585	1,934	11,500	1,915	81	82*	45	8-10
30.5RSOK	33' 10"	8' 1"	12' 3"	8' 5"	6' 3"	9,720	1,985	14,000	2,030	81	80*	45	2-4
317RLOK	36' 8"	8' 1"	12' 10"	8' 7"	6' 6"	10,870	2,135	12,995	2,125	81	87*	50	3-5
319MLOK	36' 7"	8' 1"	12' 11"	8' 7"	6' 6"	10,940	2,145	12,995	2,055	81	87*	50	4-6
31MB	37' 6"	8' 1"	12' 5"	7' 11"	6' 3"	10,690	2,025	12,750	2,060	81	82*	45	5-7
321RSTS	36' 8"	8' 1"	12' 9"	8' 7"	6' 6"	10,835	2,060	12,900	2,065	81	87*	50	4-6
335RDOK	37' 11"	8' 1"	12' 9"	8' 7"	6' 6"	10,855	2,110	12,995	2,140	81	87*	50	6-8
355MBQS	42' 4"	8' 1"	12' 9"	8' 7"	6' 6"	12,883	2,420	15,200	2,370	81	87*	50	5-7
360DBOK	43' 4"	8' 1"	13' 3"	8' 7"	6' 6"	12,510	2,500	14,950	2,440	81	87*	87*	6-8
370FBTS	40' 10"	8' 1"	12' 10"	8' 7"	6' 6"	12,035	2,320	14,000	1,965	81	87*	87*	2-4

Meet your Jayco Dealer



Scan QR code for specification definitions

Some specs at the time of print may include estimates. For the most updated information, please visit [Jayco.com](http://Jayco.com)

Jayco, Inc. | P.O. Box 460 | Middlebury, IN 46540

See dealer for further information and prices. All information in this brochure and on [www.jayco.com](http://www.jayco.com) is the latest available at the time of publication approval. Jayco reserves the right to make changes and to discontinue models without notice or obligation. Photography may show optional equipment or props used for decoration purposes only. RVs built for sale in Canada may differ to conform to Canadian codes. JAYCO and the JAYCO BIRD IN FLIGHT are registered trademarks of Jayco, Inc. Printed in USA 3/24 ©2024 Jayco, Inc.



Jayco - Part of Jayco Family of Companies