

LEAD THE WAY



PIONEER

 BROUGHT TO YOU BY
HEARTLAND®

TOP 5

EXTERIOR FEATURES

- 1 | Flip-Down Storage Rack** – Store items like bikes, wood, coolers and more.
- 2 | King Kong Sized Pass-Thru Storage** - 52 cubic feet of storage and LED lights. (N/A in Trail Blazer Models)
- 3 | Hybrid Aluminum Front Profile** - Aerodynamic radius front structure for better wind and water deflection, adding strength and reducing tongue weight.
- 4 | Pioneer Power Pack** - Power stabilizer jacks, power tongue jack and power awning.
- 5 | EZ Camp Package** - Black tank flush, outside shower with hot and cold water, LP Quick connect, outside TV hookup and a flip down secure step with XL handle.
Top 5 Features n/a Trail Blazer Models

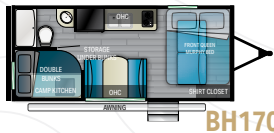

BH170

LENGTH: 22'6" | HEIGHT: 9'10" | HITCH: 502 lbs.
DRY: 3,690 lbs. | GVWR: 4,500 lbs. | SLEEP CAPACITY: 7-8

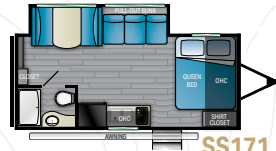

SS171

LENGTH: 22'9" | HEIGHT: 9'10" | HITCH: 470 lbs.
DRY: 4,008 lbs. | GVWR: 4,400 lbs. | SLEEP CAPACITY: 5-6

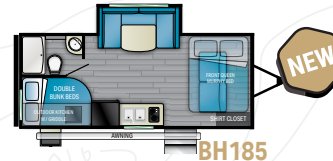

BH185

LENGTH: TBD | HEIGHT: TBD | HITCH: TBD
DRY: TBD | GVWR: TBD | SLEEP CAPACITY: TBD

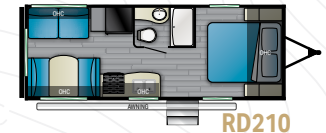

RD210

LENGTH: 26'10" | HEIGHT: 11'0" | HITCH: 636 lbs.
DRY: 4,728 lbs. | GVWR: 6,900 lbs. | SLEEP CAPACITY: 5-6

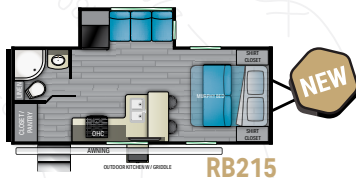

RB215

LENGTH: 25'5" | HEIGHT: 11' | HITCH: TBD
DRY: TBD | GVWR: TBD | SLEEP CAPACITY: 3-4

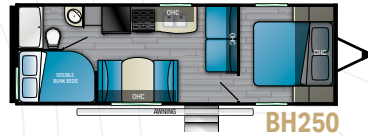

BH250

LENGTH: 29'10" | HEIGHT: 11'0" | HITCH: 735 lbs.
DRY: 5,175 lbs. | GVWR: 6,900 lbs. | SLEEP CAPACITY: 7-8

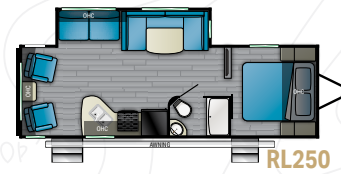

RL250

LENGTH: 30'6" | HEIGHT: 11'2" | HITCH: 620 lbs.
DRY: 6,134 lbs. | GVWR: 7,600 lbs. | SLEEP CAPACITY: 5-6

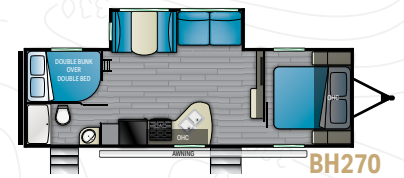

BH270

LENGTH: 32'7" | HEIGHT: 11'2" | HITCH: 680 lbs.
DRY: 6,354 lbs. | GVWR: 7,700 lbs. | SLEEP CAPACITY: 7-8

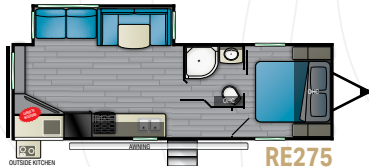

RE275

LENGTH: 32'6" | HEIGHT: 11'2" | HITCH: 670 lbs.
DRY: 6,416 lbs. | GVWR: 7,700 lbs. | SLEEP CAPACITY: 7-8

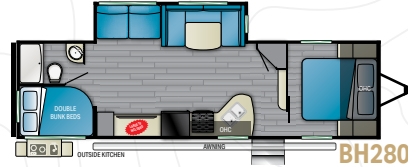

BH280

LENGTH: 34'6" | HEIGHT: 11'2" | HITCH: 654 lbs.
DRY: 6,810 lbs. | GVWR: 9,000 lbs. | SLEEP CAPACITY: 7-8

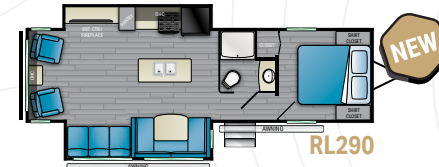

RL290

LENGTH: 32'7" | HEIGHT: 11'2" | HITCH: TBD
DRY: TBD | GVWR: TBD | SLEEP CAPACITY: 5-6



TOP 5 INTERIOR FEATURES

- 1 | **Ultimate Kitchen** - Solid surface counter tops and large stainless steel sink with high rise faucets.
- 2 | **Carpet Free RV** - Full linoleum on the main floor and no carpet in slide outs.
- 3 | **Pioneer Master Suite** - Full size residential queen bed (60" x 80"), full length dual wardrobes with integrated lighting and USB charging, CPAP ready storage with full power access.
- 4 | **Crossflow Windows** - Extra large windows that open allowing for cool fresh air.
- 5 | **"Expect More" Standards** - 8 cubic feet gas/electric refrigerator with chalk board, front fireplaces (select floorplans), and 50 amp service & second ac prep (select floorplans).

Top 5 Features n/a Trail Blazer Models



QB300

LENGTH: 35'0" | HEIGHT: 11'2" | HITCH: 806 lbs.
 DRY: 6,896 lbs. | GVWR: 9,000 lbs. | SLEEP CAPACITY: 7-8

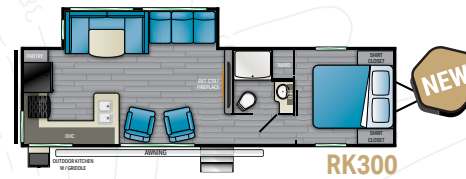

RK300

LENGTH: 34'5" | HEIGHT: 11'2" | HITCH: 728 lbs.
 DRY: 6,912 lbs. | GVWR: 9,000 lbs. | SLEEP CAPACITY: 5-6

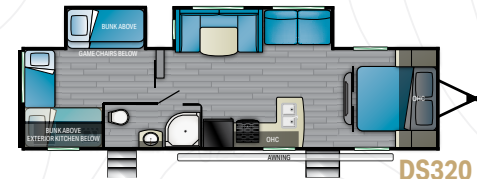

DS320

LENGTH: 37'5" | HEIGHT: 11'4" | HITCH: 870 lbs.
 DRY: 7,696 lbs. | GVWR: 9,000 lbs. | SLEEP CAPACITY: 7-8

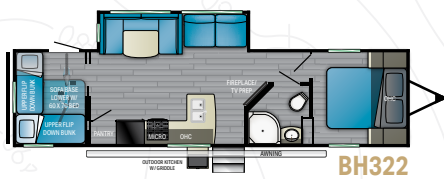

BH322

LENGTH: 36'11" | HEIGHT: 11'4" | HITCH: 788 lbs.
 DRY: 7,436 lbs. | GVWR: 9,000 lbs. | SLEEP CAPACITY: 7-8

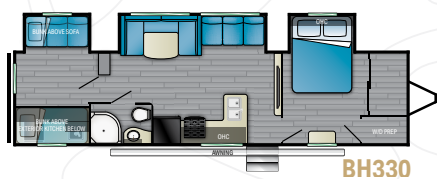

BH330

LENGTH: 37'7" | HEIGHT: 11'4" | HITCH: 794 lbs.
 DRY: 8,926 lbs. | GVWR: 10,400 lbs. | SLEEP CAPACITY: 7-8

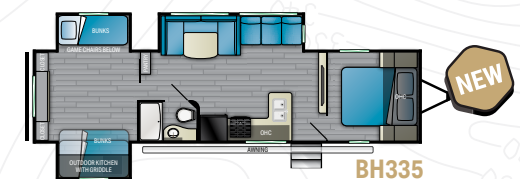

BH335

LENGTH: 32'6" | HEIGHT: 11'2" | HITCH: 670 lbs.
 DRY: 6,416 lbs. | GVWR: 7,700 lbs. | SLEEP CAPACITY: 7-8

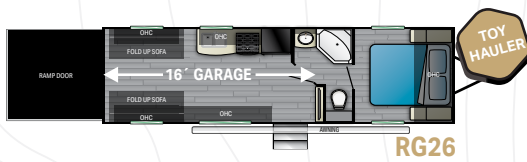

RG26

LENGTH: 30'8" | HEIGHT: 11'2" | HITCH: 788 lbs.
 DRY: 5,254 lbs. | GVWR: 7,500 lbs. | SLEEP CAPACITY: 3-4

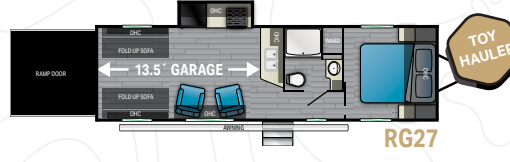

RG27

LENGTH: 32'3" | HEIGHT: 11'2" | HITCH: 970 lbs.
 DRY: 6,368 lbs. | GVWR: 9,000 lbs. | SLEEP CAPACITY: 3-4

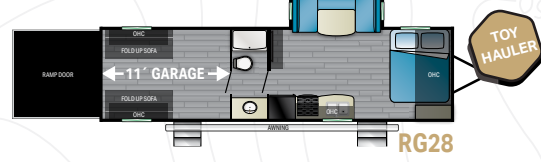

RG28

LENGTH: 33'8" | HEIGHT: 11'4" | HITCH: 1,142 lbs.
 DRY: 6,558 lbs. | GVWR: 9,000 lbs. | SLEEP CAPACITY: 5-6

PIONEER VALUE PACKAGE

- Solid Surface Kitchen Counter Tops
- Residential High Rise Faucet
- Residential Queen Size Bed
- CPAP Bedroom Storage
- USB charging ports throughout
- LED Interior Lights
- ABS Tub/Shower Surround
- Radial Tires
- Safety Glass Windows
- DSI Gas/Electric Water Heater
- Stainless Steel Sink
- Ball Bearing Drawer Guides
- Range Hood w/Light & Exhaust Fan
- Finished Drawer Boxes
- Flush Mount 3-Burner Cook Top
- XL Full Size Baggage Doors
- Lighted pass-through storage
- Cable TV Hookup w/RG6 Coax Cable
- Outside Outlet
- XL Grab Handle
- TV Antenna w/Signal Booster
- Systems Monitor Panel
- LP Bottle Cover
- Front Diamond Plate Stone Guard
- Exterior Speakers
- Flush Floor Slides
- HDMI/AM/FM Stereo w/Bluetooth
- Electric Rack & Pinion Slide Out System
- EZ Lube Axles
- LP Quick Disconnect



Pioneer Trail Blazer
(BH170, SS171, BH185)
Single Axle Unit

TRAIL BLAZER MODELS

- Power Awning w/ LED Light Strip
- Stabilizer Jacks (4)
- Spare Tire & Carrier
- Night Shades
- USB Ports
- Full Size RV Refrigerator
- Residential Stainless Steel Sink
- LED Interior Lights
- Radial Tires
- DSI Water Heater
- Ball Bearing Drawer Guides
- Finished Drawer Boxes
- Brushed Nickel High Rise Faucet
- Diamond Plate Stone Guard
- Outside Electric Outlet
- Cable TV Hookup w/RG6 Coax Cable
- Range w/2 Burner Cook Top

PIONEER LEAD THE WAY PACKAGE

- Power Stabilizer Jacks (2 Pair)
- Power Tongue Jack
- Power Awning w/ LED Lights
- Heated & Enclosed Underbelly
- Oven
- Black Tank Flush
- Night Shades
- Exterior Shower
- 50 AMP Service and 2nd A/C Prep
(RL290, DS320, BH322, BH330, BH335 Only)



SPECIAL FEATURE - Flip Down Storage Rack

VISIT US ONLINE

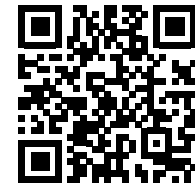

For more information and to take a virtual walk-through, visit www.heartlandrvs.com

Your authorized Heartland dealer: