

Shadow Cruiser

Freedom Within Reach

For everyone who's ever wanted to see America, but thought you couldn't afford a serious travel trailer, the Shadow Cruiser is for you. It's the most affordable trailer in our lineup, but that doesn't mean it's short on quality or comfort. Feature for feature, dollar for dollar, this budget-friendly beauty leaves all competitors in its shadow. It's lightweight, easy to tow, surprisingly well appointed, and even boasts a thoughtfully enclosed and heated underbelly to keep you toasty in cooler weather. This family favorite comes in 14 versatile floorplans – from cozy couples coaches to bunkhouse models that sleep up to 10 spirited adventurers.



SHADOW CRUISER



Strong Foundation

- Oversized I-beam frame
- Heavy-duty axles
- Heavy-duty tires with aluminum rims
- 5/8" tongue and groove plywood flooring



Ultra-lite Construction

- Lightweight but strong
- Azdel composite wall panels
- High-density block foam insulation
- Fully walkable roof



Cruiser Comforts

- King bed slide system (patent pending)
- Dual ducted A/C system
- Industry-leading ceiling heights
- Extended Season RVing Package



Camping Conveniences

- Industry-leading pass-through storage
- Full Belly Storage (patent pending)
- More drawers, cabinets and cubbies
- Power stabilizer jacks
- 30" wide entry door



Cruiser Care

- Employee pride
- 100% pre-delivery testing
- State-of-the-art production & warehouse facilities
- 1-year limited factory warranty
- 3-year limited structural warranty
- Multi-year supplier warranties



Top 5 Exterior Features

1. Patent pending full belly storage
2. Painted, molded fiberglass front cap
3. Azdel composite laminated sidewalls
4. 5-sided aluminum framing
5. Surround seal slide system with rain gutter

Top 5 Interior Features

1. Patent pending king bed slide system
2. Industry first underbed pet palace
3. Tongue and groove plywood floors
4. Seamless edge kitchen countertops
5. Dual ducted A/C and high BTU furnace



For more information and full technical specifications, visit our website at cruiserrv.com



Length 25' 7" Dry TBD Hitch TBD Height TBD

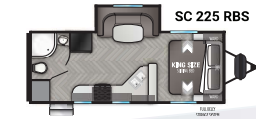

Length 25' 10" Dry 4,725 lbs. Hitch 430 lbs. Height 10' 11"

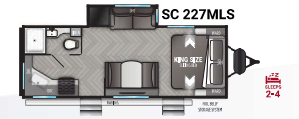

Length 26' 11" Dry TBD Hitch TBD. Height TBD

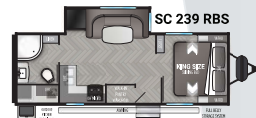

Length 27' 11" Dry 5,718 lbs. Hitch 668 lbs. Height 10' 11"



Length 28' 11" Dry 5,606 lbs. Hitch 516 lbs. Height 10' 11"

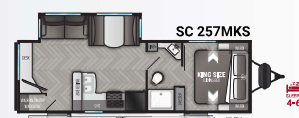

Length 29' 11" Dry 5,812 lbs. Hitch 720 lbs. Height 10' 11"



Length 29' 9" Dry TBD Hitch TBD Height TBD



Length 30' 11" Dry 5,706 lbs. Hitch 750 lbs. Height 10' 11"

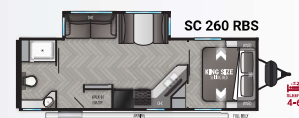

Length 30' 10" Dry 5,920 lbs Hitch 780 lbs. Height 10' 11"



Length 30' 11" Dry 5,832 lbs. Hitch 820 lbs. Height 10' 11"



Length 32' 10" Dry 6,565 lbs. Hitch 660 lbs. Height 11' 2"



Length 31' 11" Dry 5,930 lbs Hitch 710 lbs. Height 10' 11"



Length 36' 6" Dry 7,312 lbs. Hitch 1,036 lbs. Height 11' 2"



Length 36' 11" Dry 7,284 lbs Hitch 1,100 lbs. Height 11' 2"