

Jayco | 2024 Pinnacle Fifth Wheel



PINNACLE

TOP OF THE LINE LUXURY



INTERIOR DESIGN



VINTAGE FARMHOUSE

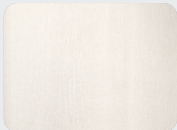

Main Wood

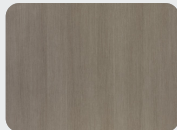

Accent Wood

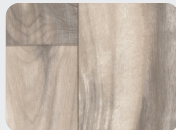

Floor

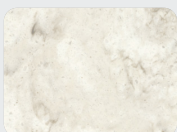

Countertop

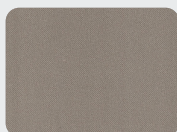

Main Fabric



Accent Fabric

MODERN FARMHOUSE



Main Wood

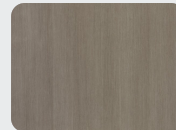

Bath Wood



Floor

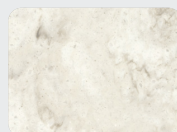

Countertop

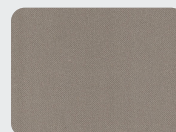

Main Fabric



Accent Fabric

STORAGE
 MICRO MICROWAVE
 OHC OVERHEAD CABINETS
 FRIDGE REFRIGERATOR
 WARD WARDROBE

32RLTS OPTIONS: A, B

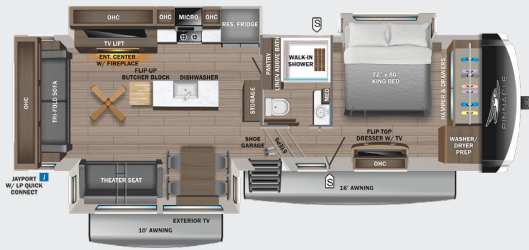

36FBTS OPTIONS: A, B

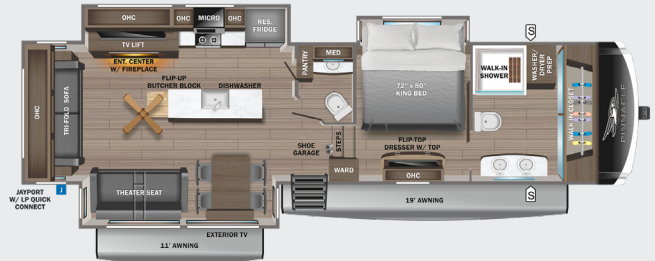

36KPTS OPTIONS: A, B

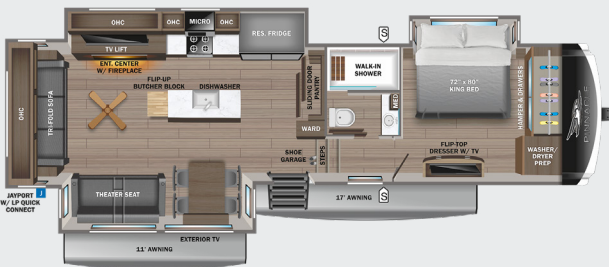

36SSWS OPTIONS: A, B, C

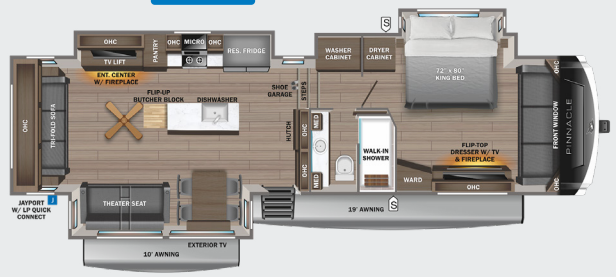

37MDQS OPTIONS: A, B

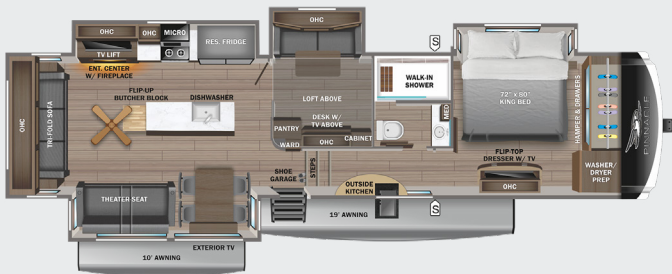

38FBRK OPTIONS: A, B

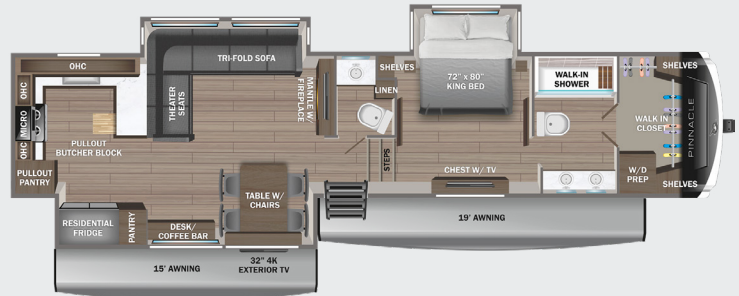

38FLGS OPTIONS: A, B, D

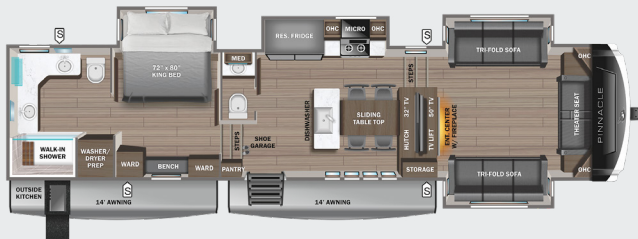

OPTIONS

A		B		C		D	
	20 Cu. Ft. Fridge		Queen Bed		Walk-In Closet		Butler Pantry

PINNACLE PAINT OPTIONS



Diamond Full-Body Paint



Sand Full-Body Paint



Steel Full-Body Paint

STANDARDS & OPTIONS

EXTERIOR

(3)40 lb. LP propane bottles with auto regulator (120 lb. max LP system)
 102 in. widebody construction
 12 in. structural steel I-beam with 10 in. steel drop frame
 120V heat blankets on all tanks plus 12V heat tape on fresh water line
 3,000 lb. tow hitch with 4-way pin
 Battery disconnect
 Built-in sewer hose carrier
 Climate Shield™ zero-degree tested weather protection:
 40,000 BTU output furnace
 Double layer fiberglass batt insulation (roof and floor)
 Fully enclosed and heated underbelly (ducted)
 PEX plumbing, 2 in. block foam and reflective foil
 Custom automotive-grade vinyl exterior graphics package
 Digital TV antenna with Wi-Fi extender
 Exterior marine-grade speakers with Bluetooth® controller
 Frameless dark tinted safety-glass windows
 Fully enclosed, universal docking center:
 Black tank flush
 Independent satellite wiring
 Quick-connect outside shower
 Selectable water connections
 Whole coach cable hookups
 Winterization and sanitation
 Inverter pre-wire to select outlets
 JayPort outside griddle prep (standard on all floorplans without a standard outside kitchen)
 JaySMART™ (Safety Markers And Reverse Travel) LED lighting (patented)
 LED exterior lighting package
 Magnum Truss™ XLO™ Roof System (strongest tested roof in the industry) with Alpha roof membrane system with limited lifetime warranty
 Painted fiberglass front and rear cap with clear coat and built-in specialty LED lighting
 Pass-through storage with Slam-latch™ baggage doors
 Skirt metal enclosed drop frame
 Stronghold VBL™ aluminum framed and vacuum bond laminated gelcoated fiberglass exterior walls (including slide room end walls)
 Under-mounted spare tire
 Water heater bypass

LED backlit custom framed mirror and medicine cabinet
 LED interior lighting throughout
 Porcelain toilet with foot flush
 Pull-out spice rack above microwave (select models)
 Pull-out utility drawer under kitchen sink
 Residential quilted bedspread and pillows
 Residential-grade, pull-out kitchen faucet
 Residential walk-in shower with teak seat and shower tower
 "Shoe garage" in hallway step (select models)
 Soft close, heavy-duty, 75 lb. full extension, steel ball-bearing drawer guides
 Solid hardwood slide fascia
 Toe kick nightlights in bedroom, bathroom and kitchen
 Tri-fold hide-a-bed sofa with sleep surface (select models)
 Vessel bowl sink with high rise faucet in main bath
 Vinyl flooring (made in the USA) throughout including slide rooms

GE Profile Series 30 in. residential convection microwave with built-in air fryer
 GE Profile Series residential 24 in. range (3.7 cu. ft. with 9100 BTU high output burner)
 High gloss gelcoated sidewalls
 JAYCOMMAND® "Smart RV" system
 LED fireplace with electric space heater
 MORryde® StepAbove™ entrance steps (main entrance) with strut assist
 Oversized multi-battery compartment (industry leading room for 4-6 batteries)
 Powered 50-amp cord reel
 Residential solid-surface kitchen countertop with solid-surface sink covers
 Residential walk-in shower with shampoo/soap holder, teak seat and shower tower
 Solid hardwood cabinet styles
 Under-sink dishwasher
 Washer/dryer prep

CUSTOMER VALUE PACKAGE (MANDATORY)

15,000 BTU "Whisper Quiet" A/C (bedroom)
 15,000 BTU "Whisper Quiet" A/C with heat pump (main)
 16 gal. gas/electric DSI water heater
 50 in. 4K SMART LED HDTV with fully digital HDMI® output and two additional HDMI® cables
 Backup, main entrance door and side observation security camera prep (includes a power switch in the bedroom to use the optional 7 in. monitor for security)
 Custom machined aluminum rims
 Electric patio awning with integrated LED lights
 Hidden hinges on cabinet doors
 JBL® home entertainment system with sound bar and subwoofer
 Keyed-Alike™ lock system (single key for all doors/locks)
 MORryde Safe-T-Rail grab handle
 Residential king (72 in. x 80 in.) mattress with under-bed storage
 Rooftop and ground solar prep
 Wireless remote control system (includes Bluetooth® wireless interior controls) with dimmer switches

OPTIONS

20 cu. ft. 12V refrigerator
 3rd 15,000 BTU ducted A/C
 5,500W Onan® Microquiet generator
 7K hydraulic disc brake package (ABS N/A with disc brakes)
 8K hydraulic disc brake package (ABS N/A with disc brakes)
 Butler's pantry (in place of half bath 38FLGS)
 Frameless dual-pane tinted safety-glass windows
 Front wardrobe in place of front windshield and sofa lounge (36SSWS)
 Full body paint- Sand, Steel and Diamond
 Generator prep
 MORryde independent suspension with 8K axles and disc brakes (ABS not available)
 Outside griddle for JayPort system (32RLTS, 36FBTS, 36KPTS, 36SSWS)
 Overlander 2 Solar Package: 30-amp controller, (1) 1800W inverter and (2) 200W solar panels
 Overlander 4 Solar Package: (4) 200W solar panels, (2) 100-amp/hour lithium heated batteries, 60-amp controller, 3000W inverter, DC/DC power converter, soft start power save main 15K A/C, soft start power save for bedroom 15K A/C, battery monitor, energy management system, roof pre-wire for additional solar panels, generator prep capable and heavy gauge steel battery enclosure
 Overlander EXT Solar Package: 3,000W inverter/charger with internal 50-amp transfer switch, energy management system, (6) solar panels with 200W each, (6) 100-amp/hour lithium heated batteries, 12V DC A/C in bedroom, DC to DC battery charger, 100-amp MPPT controller management, generator prep capable
 Queen residential foam-top mattress
 Sani-Con® Turbo waste management system
 Slideout awning(s) (quantity varies by model)
 True interior design choice (Modern Farmhouse or Vintage Farmhouse)
 Truma on-demand hot water system
 Wireless backup/side view/front entry door observation kit with 7 in. monitor

INTERIOR

12V charging station
 5/8 in. tongue-and-groove joined plywood floor and 3/8 in. roof decking
 Bathroom skylight
 Built-in laundry hamper in wardrobe (select models)
 CPAP prepped bedrooms
 Carbon monoxide and propane detector
 Cedar-lined front wardrobe closet
 Ceiling fan (select models)
 Extra 120V power outlets in kitchen and slide rooms
 Farmhouse stainless steel kitchen sink
 Flip-up countertop extension with 24 in. x 24 in. butcher block bar top (select models)
 Flip-up hidden storage in bedroom chest of drawers (select models)
 Flip-up tabletop storage next to tri-fold sofa (select models)
 Gas-strutted under-bed storage
 Handcrafted hardwood glazed doors, stiles, drawers and trim
 JayVoice™ voice command system - controls lighting, A/C and furnace
 LED accent lighting above slideouts

5 STAR HANDLING PACKAGE (MANDATORY)

17.5 in. 16 ply 'H' rated Uniroyal tires
 Dexter® Axles with ABS and Tow Assist - includes Nev-R-Adjust® brakes and E-Z Lube® hubs
 MORryde® LRE-4000™ rubberized suspension
 MORryde® rubber pin box
 Wet bolt fasteners, bronze bushings and 4,000 lb. leaf springs

LUXURY PACKAGE (MANDATORY)

2nd electric patio awning with integrated LED lights
 32 in. 4K outside Smart LED TV
 32 in. 4K Smart LED bedroom TV
 6-point hydraulic auto-leveling system
 Cellular prep for 4G WiFi antenna and JAYCOMMAND®
 Central vacuum system with dust port
 Day/night roller shades in living room
 Frameless dark tinted safety-glass windows
 Free-standing (no pedestal) table with leaf, (2) free-standing and (2) folding chairs
 Fresh Water Drinking System (patented) for fresh drinking water at the kitchen sink and water/ice dispensers in the residential refrigerator
 GE 21 cu. ft. residential refrigerator with 1800W inverter

The 5-Star Handling Package is a Jayco exclusive, a powerful blend of high-end American-made components that make pulling a luxury fifth wheel a breeze.



DEXTER® AXLES WITH ABS & TOW ASSIST - INCLUDES NEV-R-ADJUST® BRAKES & E-Z LUBE® HUBS

The Benchmark of the trailer industry!



MORryde® PIN BOX

Allows pin box to travel forward and backward as well as side-to-side, creating a smoother tow.



DEXTER® HEAVY-DUTY 1/2" SHACKLES WITH WET BOLT FASTENERS AND BRONZE BUSHINGS

Resists the wear-and-tear of towing.



MORryde® RUBBERIZED SUSPENSION SYSTEM

Better absorbs and isolates road shock.



UNIROYAL® TIRES

17.5 in. 'H' Rated

*Indicates split tanks

FLOORPLAN	TOTAL EXTERIOR LENGTH	EXTERIOR WIDTH	EXTERIOR HEIGHT (WITH A/C)	INTERIOR HEIGHT (MAIN)	INTERIOR HEIGHT (UPPER DECK)	UNLOADED VEHICLE WEIGHT	DRY HITCH WEIGHT	GVWR	CARGO CARRYING CAPACITY	FRESH WATER CAPACITY (INCLUDING WATER HEATER)	GRAY WATER CAPACITY	BLACK WASTE WATER CAPACITY	SLEEPING CAPACITY
32RLTS	36' 4"	8' 6"	13' 4"	8' 6"	6' 8"	13,290	2,395	16,275	2,985	75	87*	50	3-5
36FBTS	40' 9"	8' 6"	13' 4"	8' 6"	6' 7"	14,065	2,695	17,250	3,185	75	87*	87*	2-4
36KPTS	41' 1"	8' 6"	13' 4"	8' 6"	6' 8"	14,270	2,780	17,350	3,080	75	87*	50	2-4
36SSWS	40' 0"	8' 6"	13' 3"	8' 6"	6' 7"	14,735	2,915	17,650	2,915	75	87*	50	3-5
37MDQS	41' 8"	8' 6"	13' 3"	8' 6"	6' 7"	14,970	3,020	17,900	2,930	75	87*	50	6-8
38FBRK	43' 9"	8' 6"	13' 4"	8' 6"	6' 7"	14,995	2,940	18,000	3,005	75	87*	50	2-4
38FLGS	44' 5"	8' 6"	13' 3"	8' 6"	6' 7"	15,350	2,865	18,000	2,650	75	82.5*	74*	4-6

Meet your Jayco Dealer



Scan QR code for specification definitions



Some specs at the time of print may include estimates. For the most updated information, please visit Jayco.com

Jayco, Inc. | P.O. Box 460 | Middlebury, IN 46540
 See dealer for further information and prices. All information in this brochure and on www.jayco.com is the latest available at the time of publication approval. Jayco reserves the right to make changes and to discontinue models without notice or obligation. Photography may show optional equipment or props used for decoration purposes only. RVs built for sale in Canada may differ to conform to Canadian codes. JAYCO and the JAYCO BIRD IN FLIGHT are registered trademarks of Jayco, Inc. Printed in USA 3/24 ©2024 Jayco, Inc.

Jayco - Part of Jayco Family of Companies