

SURVEYOR

Eco-Lite Edition

By Forest River

DISCOVER THE WORLD OUTSIDE



TRA Certified **GREEN** Capable Manufacturer
Surveyor has been certified as a **GREEN** Capable Manufacturer.
TRA Certification's evaluation of their quality system, production process, material usage, recycling & environmental practices has earned them this distinction.



STRONG, DURABLE LAMINATED FIBERGLASS WITH ALL ALUMINUM CAGE CONSTRUCTION

SURVEYOR SPORT EXPANDABLES

FLOORPLANS AND SPECIFICATIONS

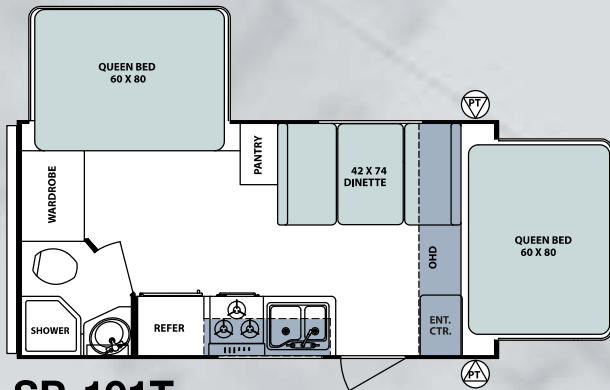

SP-191T

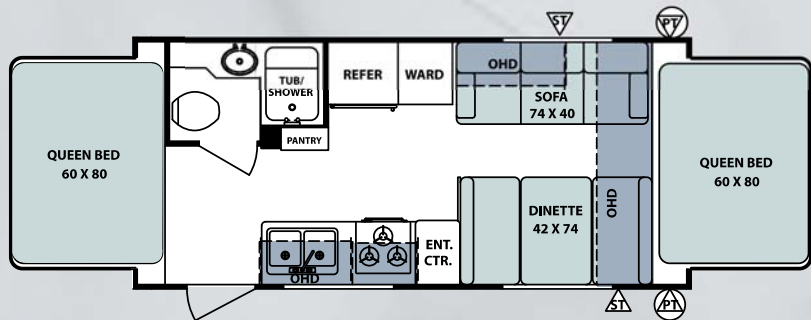

SP-192T

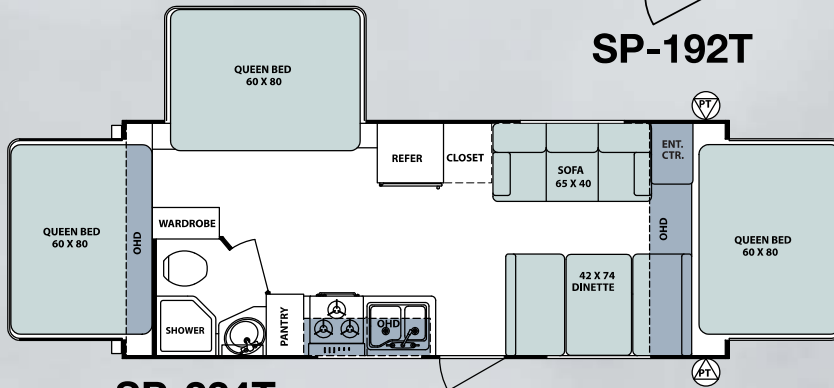

SP-224T

ST=Storage PT= Pass Thru Storage OHD= Overhead Cabinet



EASY GOING

There's no need to give up space or amenities with the Surveyor Sport. Expandable sleeping areas provide for a spacious slumber while the lightweight design makes towing a breeze. Rich in features the Surveyor Sport Expandable is a smart choice for those who choose to travel well but light!



	SP-191T	SP-192T	SP-224T
TOTAL DRY WEIGHT	2799	3237	3574
LOAD CAPACITY	808	3788	3538
HITCH WEIGHT	443	361	448
OVERALL LENGTH (Closed)	20'4"	21'11"	24'7"
OVERALL LENGTH (Open)	20'4"	25'7"	28'3"
EXTERIOR WIDTH	8'0"	8'0"	8'0"
EXTERIOR HEIGHT (roof edge)	8'7"	8'7"	8'7"
FRESH WATER (gal.)	36	36	36
GREY WATER (gal.)	30	30	30
BLACK WATER (gal.)	30	30	30
AWNING SIZE	12'	10'	13'

*We know weights and dimensions are an important part of your buying decision. Surveyor weighs every model to ensure accuracy, although refinements to the product can create variations to weights and dimensions. Review a current model at your nearest authorized Surveyor Dealer today.



SP-224T-EARTH INTERIOR



SP-224T-EARTH INTERIOR

SURVEYOR SPORT

FLOORPLANS AND SPECIFICATIONS



SP-186

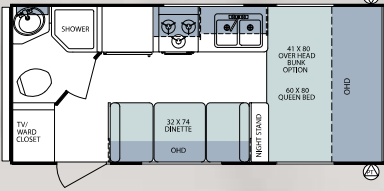

SP-189

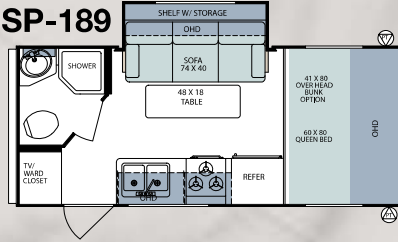

SP-230

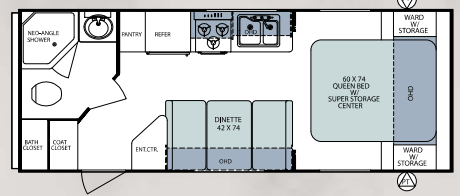

SP-240

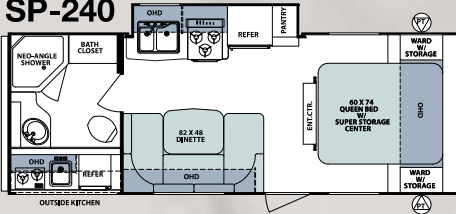

SP-260

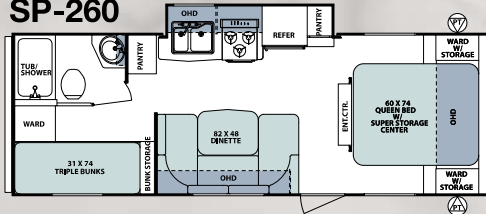

SP-275

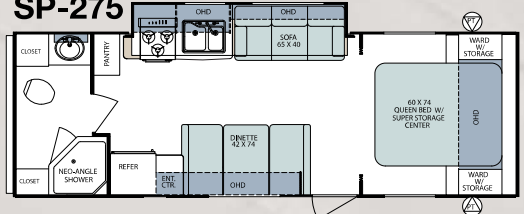

SP-280

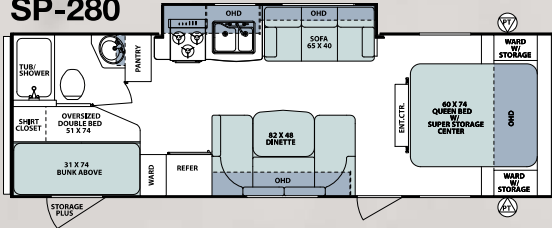

SP-292

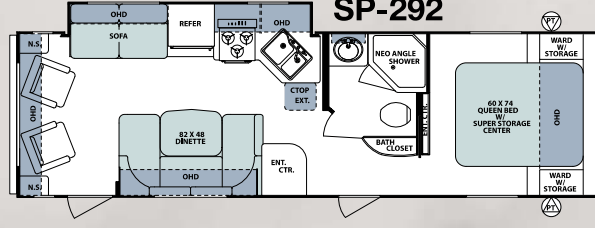

SP-293

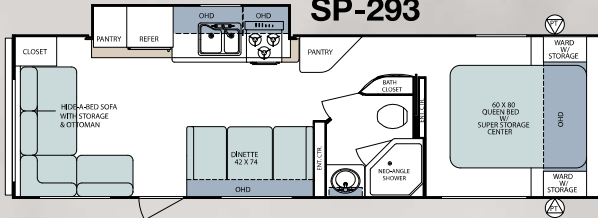

SP-295

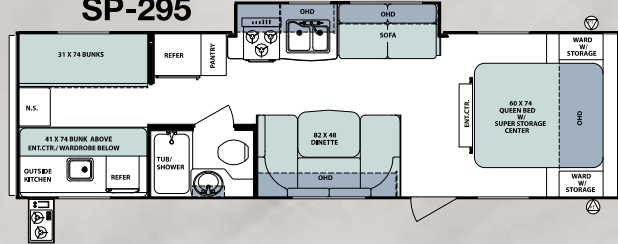

ST=Storage PT= Pass Thru Storage OHD= Overhead Cabinet

	SP-186	SP-189	SP-230	SP-240	SP-260	SP-275	SP-280	SP-292	SP-293	SP-295
*TOTAL DRY WEIGHT	2685	2964	3429	4008	4015	3985	4172	4546	4587	5034
LOAD CAPACITY	2176	1964	1615	3107	3114	3015	2960	2623	2533	2423
HITCH WEIGHT	235	302	380	418	465	418	468	505	494	457
OVERALL LENGTH	20'2"	20'6"	25'7"	26'6"	28'0"	28'9"	30'7"	32'5"	33'0"	33'2"
EXTERIOR WIDTH	7'0"	7'0"	8'0"	8'0"	8'0"	8'0"	8'0"	8'0"	8'0"	8'0"
EXTERIOR HEIGHT (roof edge)	8'7"	8'7"	8'7"	8'7"	8'9"	8'9"	8'9"	8'9"	8'9"	8'9"
FRESH WATER (gal.)	36	36	36	36	36	36	36	36	36	36
GREY WATER (gal.)	30	30	30	30	30	30	30	30	30	30
BLACK WATER (gal.)	30	30	30	30	30	30	30	30	30	30
AWNING SIZE	11'	12'	17'	13'	16'	20'	18'	18'	20'	18'

*We know weights and dimensions are an important part of your buying decision. Surveyor weighs every model to ensure accuracy, although refinements to the product can create variations to weights and dimensions. Review a current model at your nearest authorized Surveyor Dealer today.



SP-293-EARTH INTERIOR W/ L-SOFA AND OTTOMAN.



SP-293-BATHROOM

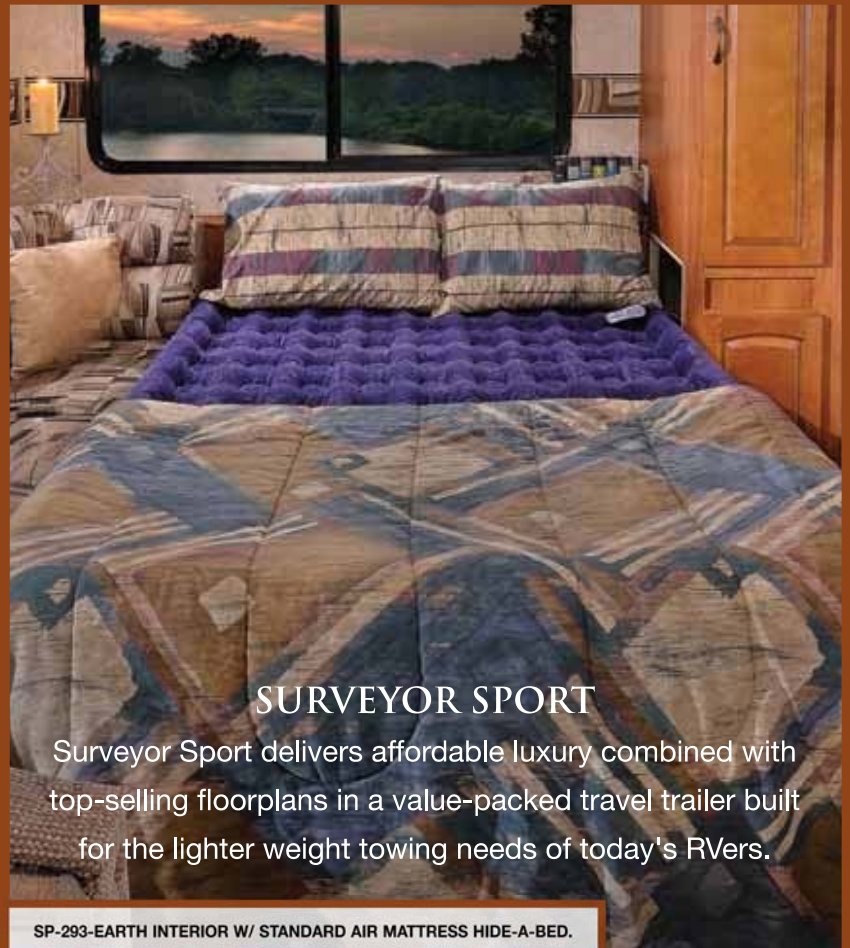

SURVEYOR SPORT

Surveyor Sport delivers affordable luxury combined with top-selling floorplans in a value-packed travel trailer built for the lighter weight towing needs of today's RVers.

SP-293-EARTH INTERIOR W/ STANDARD AIR MATTRESS HIDE-A-BED.

SURVEYOR SELECT

FLOORPLANS AND SPECIFICATIONS

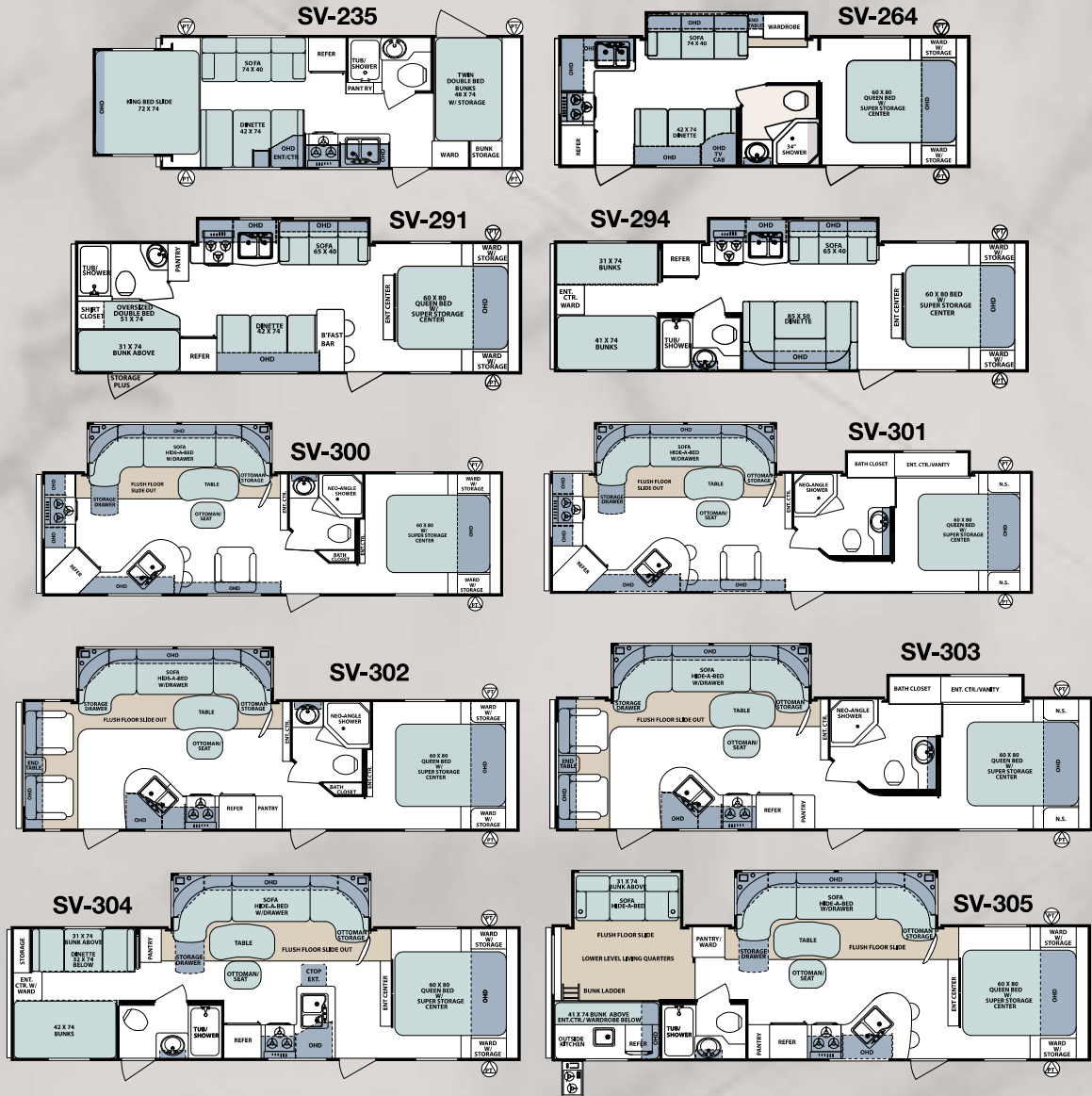

ST=Storage PT= Pass Thru Storage OHD= Overhead Cabinet

	SV-235	SV-264	SV-291	SV-294	SV-300	SV-301	SV-302	SV-303	SV-304	SV-305
*TOTAL DRY WEIGHT	4064	4308	4423	4673	TBD	TBD	6106	TBD	6208	7181
LOAD CAPACITY	2939	2698	2587	2399	TBD	TBD	4255	TBD	4277	3236
HITCH WEIGHT	476	481	440	547	TBD	TBD	676	TBD	800	732
OVERALL LENGTH (open)	25'8" (29'8")	29'0"	31'0"	33'0"	33'8"	35'7"	34'1"	36'0"	34'3"	35'7"
EXTERIOR WIDTH	8'0"	8'0"	8'0"	8'0"	8'0"	8'0"	8'0"	8'0"	8'0"	8'0"
EXTERIOR HEIGHT (roof edge)	8'6"	8'8"	8'8"	8'8"	9'6"	9'6"	9'6"	9'6"	9'6"	9'6"
FRESH WATER (gal.)	36	36	36	36	36	36	36	36	36	36
GREY WATER (gal.)	30	60	30	30	60	60	30	30	30	30
BLACK WATER (gal.)	30	30	30	30	30	30	30	30	30	30
AWNING SIZE	16'	20'	18'	20'	18'	20'	20'	20'	18'	20'

*We know weights and dimensions are an important part of your buying decision. Surveyor weighs every model to ensure accuracy, although refinements to the product can create variations to weights and dimensions. Review a current model at your nearest authorized Surveyor Dealer today.



SURVEYOR SELECT

The Surveyor Select delivers the exclusive combination of comfort and functional performance you've been searching for. Offering you more standard safety features, like a torsion suspension system, and more unique design cues, like the all-new Vista Lounge, the Surveyor Select continues to capture the essence of satisfaction and value. **The Surveyor Select. Light-weight by design, upgraded by demand.**

SV-305-CINNAMON INTERIOR WITH VISTA LOUNGE



SV-305-CINNAMON INTERIOR SUNKEN BUNK ROOM



SV-305-CINNAMON INTERIOR WITH STANDARD AIR MATTRESS HIDE-A-BED



SV-305 WITH AWNING EXTENDED



SP-295 & SV-305-EXTERIOR KITCHEN

SURVEYOR FEATURES



POWER STABILIZER JACKS
Set up is a breeze with Surveyor Select's push button electric stabilizer jacks. (N/A Sports)



FOLDING ASSIST HANDLE (OPT.)
This oversized assist handle allows for safe entry and exit from your coach.



EXTERIOR SPEAKERS (OPT.)
Optional outside speakers let you listen to your favorite music or sport channel outside.



POWER AWNING
Surveyor's push button electric awning with adjustable rain dump = 1 touch setup. No manual awnings here!



SUPERIOR CONSTRUCTION
Surveyor is one of the strongest light weight trailers because of our lamination process. High quality materials, 100% glue coverage and fully framed aluminum floor, roof, walls, fronts and backs provide you a structure for peace of mind.

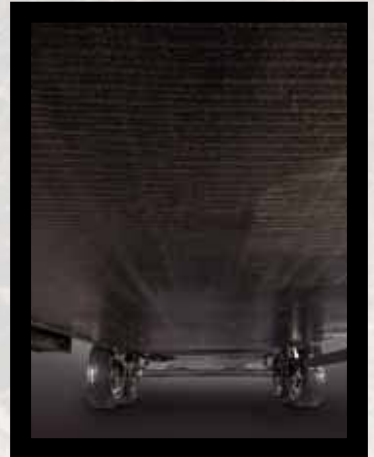

HEATED AND ENCLOSED UNDERBELLY
Surveyor Select's aerodynamic underbelly is heated and enclosed. The entire underbelly is warmed by radiant heat from the heat duct allowing you to use the coach in colder weather environments. This unique construction method opens up storage space above the floor, while lowering the units' center of gravity for towing ease and stability. (N/A Sports)



EXTERIOR SHOWER
Hot and cold controls make clean-up simple and easy.



BLACK TANK FLUSH
Tank clean out made simple with this standard and convenient feature.

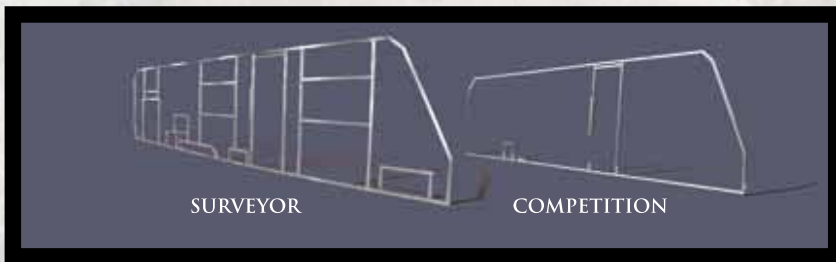

SURVEYOR SIDEWALL
Your Surveyor is constructed with tubular aluminum framing in "all" openings. Is this necessary - we think so! Aluminum framed openings add strength and integrity to every Surveyor sidewall. No other lightweight trailer compares.



POWDER COATED FRAMES
Our all steel I-Beam frames provide you with the most superior foundation.



SPACIOUS PANTRIES

Surveyor's unique use of adjustable shelves and residential recessed spring loaded hidden hinges offers you the freedom to store all your camping necessities.



FANTASTIC FAN

Fantastic Fans are standard in all Surveyor Select baths. This 12" 10-blade bath fan significantly increases air circulation and the removal of condensation as compared to the industry's standard smaller bath vent. (N/A Sports)



DOORS AND DRAWERS

Surveyor's solid wood doors and drawers are structurally superior inside - naturally beautiful outside. Genesis "ES" cabinet doors offer a 10 year limited warranty on the "Endura" panel doors.



DAY/NITE SHADES (OPT.)

Designer styled hard valances and optional Day/Nite shades provide all the privacy you need.



SERTA MATTRESS

Serta Dreamscape Mattress come standard on all Select Models. Stretch out and sleep in on this Forest River Exclusive. (N/A Sports)

SURVEYOR DESIGNER INTERIORS



Cinnamon



Earth



Saffron



WATER FILTRATION

You'll appreciate the water filtration system that is standard with each Surveyor Select. This compact unit filters water for the entire coach, eliminating those unwanted contaminants and odors. Ensuring safe drinking water for you and your family. (N/A Sports)

SURVEYOR STANDARDS

APPLIANCES/EQUIPMENT	SPORT	SELECT
Dometic, G/E Flush-Mount Refrigerator	X	X
Power Range Hood w/ Light	X	X
Six Gallon Gas/Electric DSI Water Heater w/ Quick Recovery (DSI Optional on Sports)	X	X
Three Burner Range Top	X	X
Gas Oven with Piezo Ignition	O	X
Microwave Oven	X	X
20,000 BTU Furnace (Ducted 23'-26')	X	X
30,000 BTU Ducted Furnace (27' and Above)	X	X
13.5K Air Conditioning (Ducted 25' and Above)	X	X
Digital Wall Thermostat	X	X
Stereo CD/DVD with MP3/SD Card/USB Ports and Remote Control	X	X

BATH	SPORT	SELECT
Fiberglass Tub/Shower	X	X
Adjustable Shower Head/Faucet	X	X
Lavatory Sink and Faucet	X	X
Wood Medicine Cabinet w/ Mirror	X	X
Fantastic Fan	N/A	X
Shower Curtain with Tieback	X	X
Thetford Commode with Foot Flush	X	X
Skylight in Tub/Shower	X	X
Monitor Panel	X	X

CONSTRUCTION	SPORT	SELECT
Fully Laminated Aluminum Construction	X	X
Full Walk on Roof	X	X
3" Laminated Roof (R14) (Certain Models)	X	X
2" Laminated Roof (R9) (Certain Models)	X	X
2" Laminated Sidewall (R9)	N/A	X
1-1/2" Laminated Sidewall (R7)	X	N/A
2" Laminated Floor (R9)	X	X
Electric Powered Slide-Out Mechanism w/ Manual Override	X	X
Electric Powered Rear Slide-Out Mechanism w/ 1000# Capacity	N/A	X

ELECTRICAL	SPORT	SELECT
Detachable 28', 30-amp Power Cord	X	X
55 amp Converter with Charger	X	X
Exterior 120 volt Recept	X	X
Patio Light with Amber Lens	X	X
12-volt Interior Lighting	X	X
120-volt GFI Protected Circuit Safety	X	X
Decorative Globe Light (some models)	N/A	X
Cable & Satellite Ready	X	X

EXPANDABLE BEDS	SPORT	SELECT
Vinyl Weathershield Tent(s)	X	N/A
Automotive Rubber Gasket and Compression Latches	X	N/A
Decorative Bunk Cushions	X	N/A
Radius Door w/ Hinge	X	N/A
1,000# Capacity	X	N/A

SAFETY	SPORT	SELECT
Break-Away Switch	X	X
Fire Extinguisher	X	X
LP Detector	X	X
Smoke Detector	X	X
Ground Fault Protected Electrical Circuit(s)	X	X
Dead-Bolt Door Lock	X	X
Safety Chains	X	X
CO ² Detector	X	X
Tinted Safety Glass	X	X

EXTERIOR	SPORT	SELECT
Rubber Roof w/ 12 Year Warranty	X	X
Lamilux Super 1000 Fiberglass Skin w/ 2 Year Warranty	X	X
Radius Corner Windows	X	X
Butyl Tape Sealant on Seams	X	X
Combination Entrance/Screen Door w/ Dead-Bolt Lock	X	X
Flush Mount Outside Storage Compartment(s) w/ Rubber D-Seal	X	X
Self-Storing Double Entrance Step(s)	X	X
Self-Storing Triple Entrance Steps (some models)	N/A	X
Designer Exterior Graphics	X	X
30# LP tanks w/ Molded Cover	X	X
Heated Enclosed Underbelly	N/A	X
Drip Rail and Down Spout	X	X
Electric Awning w/ Adjustable Rain Dump	X	X
Power Stabilizer Jacks	N/A	X
Heavy Duty Scissor Jacks	X	N/A
Windstar [®] TV Antenna	X	X
Dual Battery Rack	X	X
4" Square Bumper w/ Sewer Hose Storage	X	X
Outside Shower	X	X
Spare Tire w/ Carrier and Cover	X	X

INTERIOR	SPORT	SELECT
Deep Double-Bowl Kitchen Sink w/ High Rise Faucet	X	X
Knife Block Behind Stove	X	X
Panoramic Galley Window	X	X
Valances with Mini-Blinds	X	X
No-Wax Seamless Vinyl Flooring	X	X
Solid Lumber Core Cabinet Fronts Assembled w/ Screws	X	X
Residential Style Cabinet Doors w/ Concealed Hinges	X	X
Reversible Dinette Cushions	X	X
Power Range Hood with Light	X	X
Residential Style Wood Drawers w/ Metal Glides	X	X
In-Floor Heat Ducts	N/A	X
78" Interior Height	X	X
100# Gas Bed Struts (Queen Beds)	X	X
Adjustable Shelves in Pantry (Where Applicable)	X	X
Message Center w/ Key Hooks	N/A	X
E-Z Glide Dinette Table	X	X
Ceiling Light Switch at Entrance Door	X	X
60x80 Serta [®] Queen Beds	N/A	X
Screwed & Glued Cabinetry	X	X
Sink Covers	N/A	X
Stove Cover	N/A	X

PLUMBING	SPORT	SELECT
Black Tank Flush	X	X
Color-Coded Water Lines	X	X
Copper Gas Lines, Double Flared	X	X
Rotocast Holding Tanks, Underfloor	X	X
Rotocast Fresh Water Tank, Underfloor	X	X
Demand Waterpump, 12-volt	X	X
City Water Fill	X	X
Gravity Water Fill	X	X
Water Filtration System	N/A	X
Water Heater Bypass Kit	X	X
Winterization Kit	X	X

RUNNING GEAR	SPORT	SELECT
Super-Lube Hubs	X	X
Galvanized Steel Wheel Wells	X	X
Independent Torsion Suspension System	N/A	X
Leaf Spring Axle(s)	X	N/A
Radial Trailer Tires	X	X
Nev-R-Adjust [®] Electric Brakes, All Wheels	X	X
Tough, Powder Coated Frame	X	X
2-5/16" Coupler	X	X
205/75/R14C Tires		
STD: SV235, SV264, SV291, SV294	X	X
225/75/R15D Tires		
STD: SV300, SV301, SV302, SV303, SV304, SV305	N/A	X

SURVEYOR OPTIONS

INTERIOR LUXURY PACKAGE	SPORT	SELECT
Interior Luxury Package	X	X
Exterior Luxury Package	X	X
15K Air Conditioner IPO 13.5 BTU A/C	O	O
Gas oven	O	X
6 Gal. G/E DSI water heater	O	X
Day/Nite shades	O	O
Outside stereo speakers (2)	O	O
41" Folding bunk bed (SP186 & SP189)	O	N/A
Aluminum split spoke wheels	O	O
26" LCD flat screen TV (Only available in certain models)	O	O
19" LCD flat screen TV (all models)	O	O
Roof Ladder (N/A SP192T, SP224T & SV235RKS)	O	O
Outside gas grill (STD, SP240, SP295 & SV305)	O	O
Raised panel refer door inserts	O	O
Power tongue jack	O	O
Axle Risers (N/A SV300, SV301, SV302, SV303, SV304 & SV305)	N/A	O
Exterior assist grab handle	O	O
Slide-Out Awning topper	O	O
CO ² detector (Required in all models)	X	X
Booth dinette with Hide-A-Bed sofa IPO "Vista Lounge"	N/A	O

X = STANDARD EQUIPMENT, O = OPTIONAL, N/A = NOT APPLICABLE

SURVEYOR SPORT ADVANTAGES

- Aluminum Framing Around All Openings
- Full Walk on Roof
- 30 lb. LP Bottles w/ Cover
- 4" Square Bumper
- Tinted Safety Glass
- 78" Interior Height
- Double Steps
- Detachable Power Cord
- 100 lb. Gas Struts (Queen Bed)
- Wood Medicine Cabinet
- 55 amp Power Converter
- Wood Kitchen Drawers w/ Metal Glides
- Electric Awning
- Black Tank Flush
- E-Z Glide Dinette Table
- Skylight in Tub/Shower
- (4) Scissor Stabilizer Jacks
- Outside Shower

SURVEYOR SELECT ADVANTAGES

- Aluminum Framing Around All Openings
- 2" Thick Sidewalls
- Independent Torsion Axles
- Heated and Enclosed Underbelly
- Full Walk on Roof
- 78" Interior Height
- Gas/Electric DSI Water Heater
- 30 lb. LP Bottles w/ Cover
- 4" Square Bumper
- Water Filtration System
- Fantastic Fan
- Detachable Power Cord
- 60" x 80" Queen Beds (N/A SV235RKS)
- 100 lb. Gas Struts (Queen Bed)
- Tinted Safety Glass
- Outside Shower
- Black Tank Flush
- Electric Awning
- E-Z Glide Dinette Table
- Power Stabilizer Jacks
- Serta Mattress

SURVEYOR SPORT MANDATORY OPTIONS

Interior Luxury Package: 90 lbs., Raised panel cabinet doors w/ residential hinges, AM/FM/CD/DVD stereo system w/ remote control, 3 burner cooktop, microwave, skylight over tub/shower, tub surround, decorative wall paper border, double door refrigerator and E-Z glide dinette table

Exterior Luxury Package: 246 lbs., Electric awning, 30# LP bottles w/ cover, spare tire/carrier and cover, stabilizer jacks, TV antenna w/ cable/satellite hook-up, detachable 30 amp power cord, alum-cage construction, 13.5 BTU air conditioner, double entry step, tinted safety windows Lamilux 1000 gel-coated fiberglass & black tank flush

SURVEYOR SELECT MANDATORY OPTIONS

Interior Luxury Package: 208 lbs., Decorative shower curtain, raised panel cabinet doors w/ residential hidden hinges, stove cover, AM/FM/CD/DVD stereo system w/ remote control & 4 speakers, sofa pillows, water filtration system, 3 speed fantastic fan in bathroom, 6 gal. G/E DSI water heater, 3 burner cooktop w/ oven, sink covers, tub surround, microwave, E-Z glide dinette table, decorative bedroom pillows, skylight over tub/surround & the Serta "Dreamscape Mattress"

Exterior Luxury Package: 267 lbs., Electric awning, 13.5 BTU air conditioner, 30# LP bottles w/ cover, spare tire/carrier & cover, outside shower, power stabilizer jacks, TV antenna w/ cable/satellite hook-up, independent torsion axles w/ ultralube hubs, enclosed & heated underbelly, alum-cage construction, detachable 30 amp power cord, 2" exterior walls, (R-9) insulation, Lamilux 1000 gel-coated fiberglass, tinted safety glass windows & black tank flush

SURVEYOR WARRANTY INFORMATION

For Details on Surveyor's complete warranty program, see your Surveyor dealer. Surveyor offers the following additional limited warranties to the original purchasers. Consult written warranty for details.

1. Twelve year rubber roof warranty
2. Two year fiberglass warranty
3. Two year axle warranty
4. One year bumper to bumper warranty
5. Available second-year warranty

FOREST RIVER ENCOURAGES YOU TO BUY LOCALLY

Forest River, Inc. strongly encourages our retail customers to purchase from their local dealership whenever possible due to the following factors:

- Our Dealers are, as a rule, independently owned and operated businesses. Outside of those customers they personally sold products to, they are not contractually obligated to perform warranty service on Forest River products that were purchased elsewhere. There may be an occasion that you would be required to return to the point of purchase to satisfy warranty requirements.
- Although many dealerships will eventually service products not purchased at their place of business, they will usually take care of their customers and other Forest River customers who are traveling away from their local dealer as they would their own.
- Local purchases allow a customer to establish a relationship with a dealer close to home. This relationship provides the customer with a convenient location for service and support from a "home town" professional.
- The opportunity for a thorough PDI (Pre Delivery Inspection) and product orientation is an additional benefit of buying from your local dealer. Further providing the opportunity for refresher courses or the ability to get questions answered much more conveniently.
- For our Canadian customers, there are also requirements which must be met to bring an RV purchased out of the country to their home. Although not insurmountable, these requirements may involve such things as additional inspections and certifications, taxes and fees. Your local Canadian Dealer is a professional at meeting these requirements.
- Forest River's goal is for all RV owners to fully enjoy their RV experience. In light of this goal, and considering the advantages of buying local, we encourage you to be thorough when determining what product to purchase and which dealer to purchase it from as both are key to your ultimate satisfaction and the realization of your dreams.



20,000 SQUARE FEET OF QUALITY ASSURANCE

The bare essentials for a premium product

Brought online in 2005, Forest River is proud of its state-of-the-art test facility. This beautiful building blends many of the old tried and true methods of testing our diverse types of RVs with new innovative ways of solving quality issues. Being centrally located to most Forest River manufacturing facilities, this 20,000 square foot PDI (Pre-delivery Inspection) test building gives immediate daily feedback to individual managers. This assures the production facilities that nothing has slipped by the plant's quality assurance personnel and the units are "green" and ready to ship.



PEACE OF MIND

Forest River has yet another exclusive feature to offer: One year of free roadside assistance will be given to every new Surveyor customer. This is just one more way to say "Thank you" and to ensure an enjoyable traveling experience.



SURVEYOR... DESIGNED WITH YOUR TOW VEHICLE IN MIND!

The tow ratings listed below are the highest available for the respective models listed. Certain optional equipment may be required and other restrictions may apply. See your automotive dealer for more information.

	Tow Max		Tow Max		Tow Max
ACURA		HUMMER		MINI	
MDX	5,000	H2 (2009)	8,200	Cooper	3,500
AUDI		H2 SUT (2009)	8,200	Cooper S	3,500
Q5	4,400	H3 5 Cyl.	4,500	Countryman	3,500
Q7 (all trim levels)	6,600	H3 8 Cyl.	6,000	Countryman S	3,500
BMW		H3 SUT 5 Cyl.	4,400	Countryman S	3,500
X3	3,000	H3 SUT 8 Cyl.	5,900	NISSAN	
X5 (all trim levels)	6,000	HYUNDAI		Frontier 2WD	6,300
X6 (all trim levels)	6,000	Santa Fe GLS FWD/AWD	2,000	Frontier 4WD	6,100
BUICK		Santa Fe SE FWD/AWD	3,500	Murano	3,500
Enclave	4,500	Santa Fe Limited FWD/AWD	3,500	Pathfinder V6	6,000
CADILLAC		Tucson (All Trim Levels)	1,000	Pathfinder V8	7,000
Escalade 2WD	8,300	Veracruz (All Trim Levels)	3,500	Quest	3,500
Escalade AWD	8,100	INFINITI		Titan King Cab 2WD	9,500
Colorado/ Canyon 2WD 5 Cyl.	4,000	FX35 V-6 RWD	-	Titan King Cab 4WD	9,400
Colorado/ Canyon 4WD 5 Cyl.	5,500	FX35 V-6 AWD	2,000	Titan Crew Cab 2WD	9,400
Colorado/ Canyon 4WD 8 Cyl.	6,000	FX50 V-8 AWD	3,500	Titan Crew Cab 4WD	9,400
Equinox 6 Cyl.	3,500	QX56 2WD	9,000	Xterra	5,000
Express/Savana G1500	6,200	QX56 4WD	8,900	PORSCHE	
Silverado/ Sierra 1500 5.3L	9,700	JEEP		Cayenne	7,716
Silverado/ Sierra 1500 6.2L	10,700	Commander 2WD V6	3,500	Cayenne S	7,716
Silverado/ Sierra 2500 HD 6.0L	13,000	Commander 2WD V8	7,400	SAAB	
Silverado/ Sierra 3500 HD 6.6L	13,000	Commander 4WD V6	3,500	9-7X 6 Cyl. (2009)	5,500
Silverado/ Sierra Hybrid	6,100	Commander 4WD V8	7,200	9-7X 8 Cyl. (2009)	6,500
Suburban/ Yukon XL 1500	8,100	Grand Cherokee 2WD V6	3,500	SATURN	
Suburban/ Yukon XL 2500	9,600	Grand Cherokee 2WD V8	7,400	Outlook (2009)	5,200
Tahoe/ Yukon 2WD	8,400	Grand Cherokee 4WD V6	3,500	Vue 4 Cyl. (2009)	1,500
Tahoe/ Yukon 4WD	8,200	Grand Cherokee 4WD V8	7,200	Vue V6 (2009)	3,500
Tahoe/ Yukon Hybrid	6,000	Grand Cherokee 4WD V8	7,200	Vue Hybrid (2009)	1,500
Traverse/ Acadia (All Trim Levels)	6,000	Grand Cherokee SRT8	3,500	SUBARU	
DODGE/ CHRYSLER		Patriot w/ Freedom Drive II	2,000	Forester	2,400
Dakota 3.7L 2WD	4,650	Wrangler Unlimited 2WD/4WD	3,500	Tribeca	3,500
Dakota 3.7L 4WD	4,650	KIA		SUZUKI	
Dakota 4.7L 2WD	7,050	Sportage V-6 2WD/4WD	2,000	Equator Extended Cab 4 Cyl.	3,500
Dakota 4.7L 4WD	6,900	Sedona	3,500	Equator Extended Cab V6	6,500
Ram 1500 V6	3,800	LAND ROVER		Equator Crew Cab 2WD	6,300
Ram 1500 4.7L 2WD	7,650	LR2	3,500	Equator Crew Cab 4WD	6,100
Ram 1500 4.7L 4WD	7,500	LR4	7,716	Grand Vitara (All Trim Levels)	3,000
Ram 1500 5.7L 2WD	10,450	Range Rover	7,716	TOYOTA	
Ram 1500 5.7L 4WD	10,250	Range Rover Sport	7,716	4Runner 4 Cyl.	2,000
Ram 2500 5.7L 2WD	9,100	LEXUS		4Runner V6	5,000
Ram 2500 5.7L 4WD	8,450	GX460	6,500	FJ Cruiser	5,000
Town & Country/Caravan (TP)	3,800	LX570	8,500	Highlander 4 Cyl. (TP)	3,500
Ram 1500 5.7L RC SB 2WD 4:10:1	5,050	RX350	3,500	Highlander V6 (TP)	5,000
FORD		RX450H	3,500	Highlander Hybrid	3,500
Edge	3,500	LINCOLN		Land Cruiser	8,500
Escape 4 Cyl.	1,500	MKT	4,500	Rav4 4 Cyl.	1,500
Escape 6 Cyl.	3,500	MKX	3,500	Rav4 V6 (TP)	3,500
Escape Hybrid	1,000	Navigator 2WD	9,000	Sequoia 4.6L (All Trim Levels)	7,000
E-150 Van 4.6L	6,100	Navigator 4WD	8,700	Sequoia 5.7L (All Trim Levels)	9,600
E-150 Van 5.4L	7,000	Navigator L 2WD	8,700	Sienna	3,500
Expedition 2WD	9,200	Navigator L 4WD	8,500	Tacoma	3,500
Expedition 4WD	9,000	MAZDA		Tacoma V6 Tow Prep PKG	6,500
Explorer V-6 2WD 2-Dr	5,375	CX-7 Grand Touring	2,000	Tundra Reg. Cab	10,500
Explorer V-6 4WD 2-Dr	5,205	CX-9 FWD	3,500	Tundra Double Cab	10,300
Explorer V-8 4WD	7,025	CX-9 AWD	3,500	Tundra Crew Max	10,100
Explorer Sport-Trac V6 2WD	5,250	Tribute V6	3,500	VOLKSWAGEN	
Explorer Sport-Trac V6 4WD/AWD	5,080	MERCEDES-BENZ		Routan S/SE	2,000
Explorer Sport Trac V8 4WD	6,990	G Class	3,500	Routan SEL/ SEL Premium	3,500
F-150 Reg. Cab 2WD 4.6L	5,400	GL Class	7,500	Tiguan	2,200
F-150 Reg. Cab 4WD 4.6L	8,000	GLK Class	3,500	Touareg	7,716
F-150 Super Cab 2WD 4.6L	5,300	ML 350	7,200	VOLVO	
F-150 Super Cab 4WD 4.6L	5,500	ML 350 BlueTEC	7,200	V50	2,000
F-150 Super Cab 2WD 5.4L	8,600	ML450 Hybrid	5,000	V70	3,300
F-150 Super Cab 4WD 5.4L	8,300	MERCURY		XC60	3,300
F-150 Super Crew 2WD 4.6L	5,200	Mariner V6	3,500	XC70	3,300
F-150 Super Crew 4WD 4.6L	7,700	Mountaineer V6 2WD 5 pass.	5,305	XC90 FWD	3,970
F-150 Super Crew 2WD 5.4L	8,500	Mountaineer V6 2WD 7 pass.	5,220	XC90 AWD	4,960
F-150 Super Crew 4WD 5.4L	9,600	Mountaineer V6 AWD 5 pass.	5,000		
F-250/F-350	12,500	Mountaineer V6 AWD 7 pass.	5,000		
HONDA		Mountaineer V8 AWD 5 pass.	7,040		
CR-V	1,500	Mountaineer V8 AWD 7 pass.	6,955		
Odyssey	3,500				
Pilot 2WD	3,500				
Pilot 4WD	4,500				
Ridgeline	5,000				



Scan this barcode using a QR Reader on your smart phone to learn more about Forest River.



Forest River Inc., 2405 Century Drive Goshen, IN 46528
www.forestriverinc.com/Surveyor, www.forestriveraccessories.com
 Ph. 574.642.3119

As Surveyor constantly strives to improve our product, all specifications listed in this informative brochure are subject to change without notice or obligation. Photos may show optional equipment which is not included in the purchase price of the unit. Review a current model on your dealer's lot today. FRSV112

SURVEYOR