

# PALOMINO

BACKPACK EDITION



SS-1251



# GOING UP?

It's easy with Palomino's New Motorized Camper Lift System featuring Rieco-Titan's Electric Roof Lift System with optional key fob control.



**No more hand cranking!**



PALOMINO  
BACKPACK EDITION

## PALOMINO SOFT-SIDE BACKPACK EDITION

No matter the size of your truck, we have a soft-side truck camper perfect for you. Thanks to the Rieco Titan® electric lift you can easily set up your camper without hand-cranking the top up or down. And with the optional remote, it works with just a push of a button. Plus, our 55" one-piece door makes it that much easier to enter and exit the camper, compared to our competition's 46" or 47" door. The soft-side series comes in a pearl or grey laminated gel coat exterior.

HS-8801



## PALOMINO HARD-SIDE TRUCK CAMPERS

Our lightweight, hard-side truck campers are packed with great features and keep a lighter payload, thanks to the fully aluminum welded frame. We've redesigned the interior to provide greater cabinet storage, and upgraded frameless windows. Our campers fit multiple truck sizes so check page 11 to find your favorite floorplan.



# PALOMINO HARD SIDE MAX BACKPACK EDITION

Our Hard Side Max series is our premium product. With the insulated, frameless windows and heated basement, this camper is ready for four season livability. Our exclusive front cap windshield opens the expansive living space with light and creates an inviting atmosphere.



HS-2911





Introducing the Industry First Gel-Coat Fiberglass front cap with a fully integrated windshield. Palomino RV partnered with the leaders in O.E. Automotive Windshield Manufacturing Guardian Industries as well as Dow Chemicals to create this Palomino Exclusive Feature. This automotive style windshield not only looks great rolling down the road, but also creates an open inviting environment in the Palomino Hard Side Max Cabover Bunks while you enjoy great panoramic views.



Above: The Hard Side Max comes with our exclusive Landing Pad bumper, which gives you more room when entering and exiting. When using the awning, the Landing Pad remains shaded and comfortable.

# PALOMINO HARD SIDE MAX TRUCK CAMPER CONSTRUCTION

Palomino Hard side truck campers are aluminum framed with laminated construction to offer a light weight yet durable product at a price you can afford.

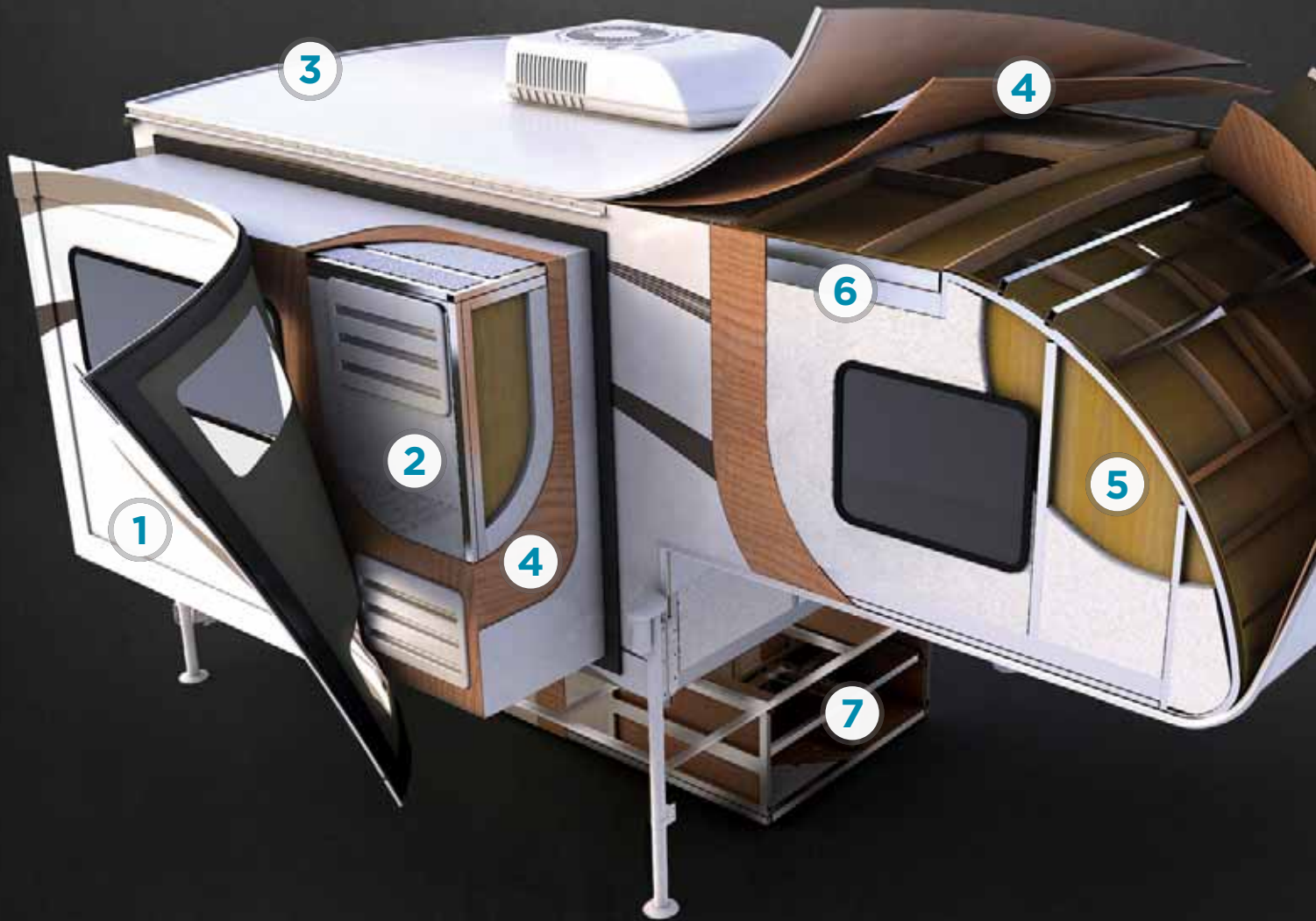

- 1 HI GLOSS GEL COAT FIBERGLASS EXTERIOR
- 2 HIGH DENSITY BLOCK FOAM INSULATION
- 3 ALPHA SUPER FLEX MEMBRANE ROOF
- 4 PLYWOOD SUBSTRATE
- 5 DECORATIVE WALL BOARD
- 6 ALUMINUM FRAMING-FULLY WELDED SUPER STRUCTURE (N/A ON HS-800)
- 7 4-SEASON HEATED INSULATED BASEMENT



## LANDING PAD BUMPER

Palomino exclusive Landing Pad bumper for additional storage space



PALOMINO BACKPACK EDITION

# STANDARDS & OPTIONS

EP

## ELITE PACKAGE

(AVAILABLE ON 8801/  
2902/2910/2911 ONLY)

- SOLID SURFACE COUNTER TOPS
- BACK UP CAMERA
- MOTION DETECTION
- EXTERIOR PORCH LIGHT
- LINE X<sup>®</sup> PACKAGE
- REAR POWER AWNING WITH LED LIGHTS

### STANDARD FEATURES

- LED Interior Lighting
- Vented Battery Box (2 Std. on Max Series)
- Battery Quick Disconnect
- Battery Charging Station
- Rieco Titan<sup>®</sup> Electric Roof Lift (Soft sides only)
- Ball Bearing Drawer Guides
- "Landing Pad" Integrated Bumper (Hard Side Max Only)
- Laminated Walkable Roof (Hard Side Only)
- Congoleum<sup>®</sup> Wood Grain Flooring
- Mortise and Tenon Walnut Hard Wood Cabinets
- Pocket Screw Lumber Core Cabinet Stiles
- 55" One-Piece Door (Soft Side Only)

### COMMONLY ORDERED OPTIONS

- Air Conditioning
- Pearl or Grey Hi-Gloss Exterior Fiberglass
- Entry Step
- Microwave (Hard Sides Only)
- Side Awning w/LED Lights (Hard Sides Only)
- Rear Awning w/LED Lights (Hard Sides Only)
- Wireless Remote for Rieco Titan<sup>®</sup> Roof Lift (Soft sides only)
- Elite Pkg - Hard Sides only (8801/2902/2910/2911)

\* See our website for a complete list of available options



### CHARGING PORT

Allows you to charge or maintain your on-board battery with ease from the exterior of your Palomino Camper.

### BARRELED ROOF

Vacuum bonded radius roof with vaulted ceiling provides superior insulation and additional interior height

# PALOMINO BACKPACK EDITION SOFT SIDE SERIES

## FLOORPLANS & SPECIFICATIONS

### SS 550

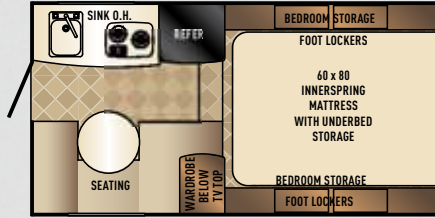

\*DESIGNED FOR ANY 1/2 TON TRUCK

### SS 800

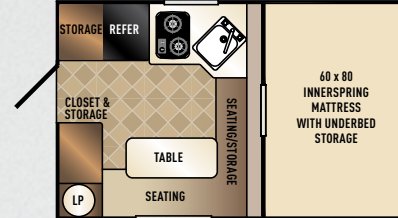

\*DESIGNED FOR COMPACT TRUCKS

### SS 1200

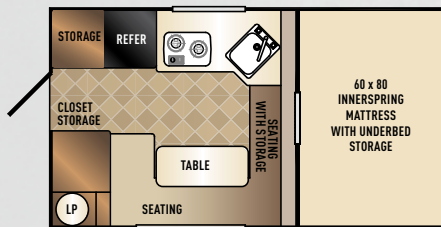

\*DESIGNED FOR A FULL-SIZE TRUCK W/ 6'6" OR 8' BED

### SS 1240

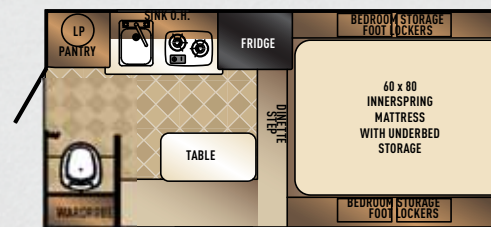

\*DESIGNED FOR 1/2 TON TRUCK W/ 6'6" OR 8' BED

### SS 1251

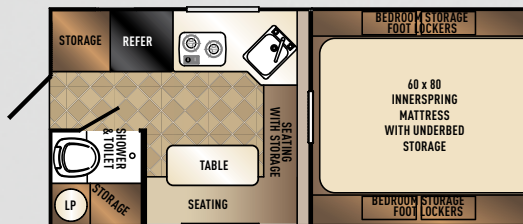

\*DESIGNED FOR A 1/2 TON TRUCK W/ 6'6" BED

### SS 1500

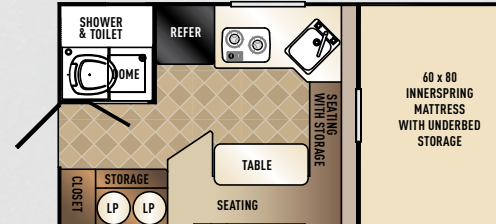

\*DESIGNED FOR A FULL-SIZE TRUCK W/ 8' BED

WEIGHTS & MEASURES	SS 550	SS 800	SS 1200	SS 1240	SS 1251	SS 1500
Total Exterior Length	13'5"	11'4"	12'10"	14'10"	14'10"	14'4"
Total Exterior Width	7'2"	7'2"	7'2"	7'2"	7'2"	7'2"
Floor Length	7'	6'9"	8'0"	8'6"	8'6"	9'6"
Wheel Well Width	46 1/2"	44"	46 1/2"	46 1/2"	46 1/2"	46 1/2"
Height Closed with Vent	6'	6'	6'	6'	6'	6'
Interior Open Height	7'	7'	7'	7'	7'	7'
Dry Weight (Lbs.)	1594	1462	1591	1876	1795	1910
Fresh Water Capacity (Gals.)	16	16	16	16	22	22
Black Water Capacity (Gals.)	0	0	0	7	7	7
LP Gas Capacity	20 lbs.	20 lbs.	20 lbs.	20 lbs.	20 lbs.	2 - 20 lbs.
Cab over Bed Size	60" x 80"	60" x 80"	60" x 80"	60" x 80"	60" x 80"	60" x 80"
Dinette Bed Size	36" x 90"	36" x 62"	36" x 72"	36" x 72"	36" x 62"	36" x 72"
Center of Gravity **	22"	29"	39"	37"	37"	45"

\* PALOMINO STRONGLY RECOMMENDS YOU CHECK YOUR TRUCKS OWNERS MANUAL OR CONTACT THE MANUFACTURER FOR YOUR TRUCKS CAPABILITIES.

\*\* THE CENTER OF GRAVITY MEASUREMENT IS AS BUILT. YOUR OPTIONS AND LOADING ON THE TRUCK MAY ADJUST THIS MEASUREMENT.

# HARD SIDE SERIES

**HARD SIDE HS 650**

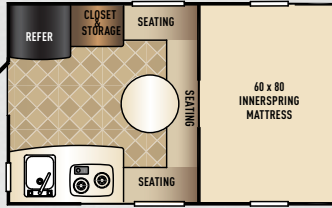

\*DESIGNED FOR 1/2 TON, 5'6", 6'6" OR 8' BED

**HARD SIDE MAX HS 2902 EP**

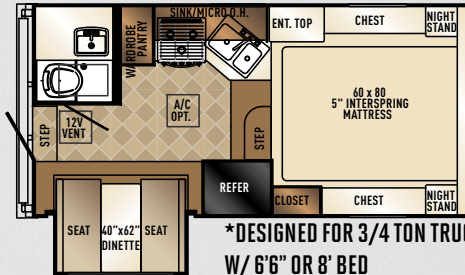

\*DESIGNED FOR 3/4 TON TRUCK W/ 6'6" OR 8' BED

**HS 6601**

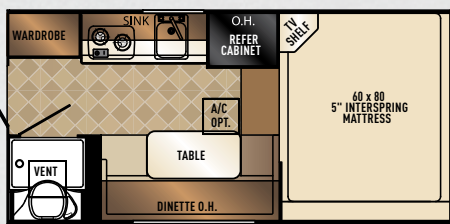

\*DESIGNED FOR 3/4 TON TRUCK W/ 6'6" OR 8' BED

**HS 2910 EP**

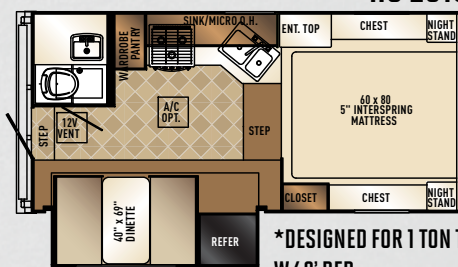

\*DESIGNED FOR 1 TON TRUCK W/ 8' BED

**HS 8801 EP**

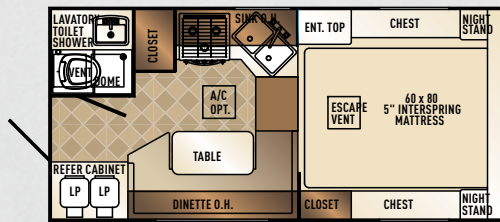

\*DESIGNED FOR 3/4 TON TRUCK W/ 6'6" OR 8' BED

**HS 2911 EP**

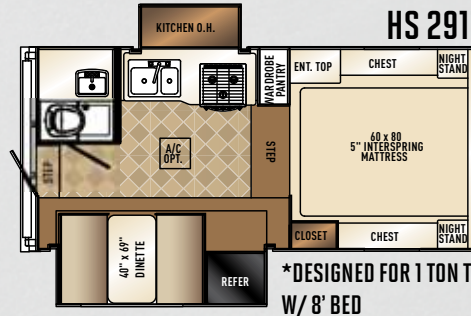

\*DESIGNED FOR 1 TON TRUCK W/ 8' BED

## HARD SIDE

## HARD SIDE MAX

	HS 650	HS 6601	HS 8801	HS 2902	HS 2910	HS 2911
<b>WEIGHTS &amp; MEASURES</b>						
Total Exterior Length (Including Ladder)	16'-0"	16'-8"	18'-0"	19'-0"	20'-0"	20'-0"
Total Exterior Width	7'-2"	7'-2"	7'-10"	8'-2"	8'-2"	8'-2"
Floor Length	6'-6"	9'	9'	9'	10'	10'
Wheel Well Width	48"	48"	48"	48"	48"	48"
Exterior Height with Ladder	7'7"	8'2"	8'2"	9'	9'	9'
Interior Height	6'6"	6'11"	6'11"	6'10"	6'10"	6'10"
Dry Weight (Lbs.)	1547	2051	2405	3261	3493	3590
Fresh Water Capacity (Gals)	15	31	31	45	45	45
Black Water Capacity (Gals)	0	6	7	20	20	20
Gray Water Capacity (Gals)	0	8	8	20	20	20
LP Gas Capacity	20 lbs.	20 lbs.	20 lbs.	20 lbs.	20 lbs.	20 lbs.
Cab over Bed Size	60" x 80"	60" x 80"	60" x 80"	60" x 80"	60" x 80"	60" x 80"
Dinette Bed Size	TBD	40" x 73"	40" x 73"	40" x 62"	40" x 69"	40" x 69"
Center of Gravity **	29 1/2"	38"	42"	37"	46"	46"

\*PALOMINO STRONGLY RECOMMENDS YOU CHECK YOUR TRUCKS OWNERS MANUAL OR CONTACT THE MANUFACTURER FOR YOUR TRUCKS CAPABILITIES.

\*\* THE CENTER OF GRAVITY MEASUREMENT IS AS BUILT. YOUR OPTIONS AND LOADING ON THE TRUCK MAY ADJUST THIS MEASUREMENT.

**EP** ELITE PACKAGE AVAILABLE. FOR ADDITIONAL INFORMATION ON THE ELITE PACKAGE PLEASE SEE PAGE 9.



Forest River, Inc. encourages our customers to purchase their Forest River products from a local dealership whenever possible for the following reasons:

- 1) Forest River, Inc. dealers are independently owned and operated businesses so priority service and scheduling is at their discretion and is often provided to customers that purchased their unit at that dealership.
- 2) Purchasing locally allows customers to establish meaningful relationships with a dealer, enhancing the RV experience through assistance with product questions, user tips or RV regulations for your state or country, and much more!
- 3) Canadian customers must meet requirements to bring an RV purchased out of the country to their home. These requirements may involve additional inspections and certifications, taxes and fees. Your local Canadian Dealer is a professional at meeting these requirements.
- 4) Scheduling timely warranty repairs and adjustments through a local dealership provides far greater flexibility and convenience to you, the customer!

It is the goal of Forest River, Inc. that all of our RV owners fully enjoy the RV experience and that customer satisfaction meets or exceeds their expectations!



#### PRE-DELIVERY INSPECTION FACILITY

20,000 square feet of quality assurance. The bare essentials for a premium product. This state-of-the-art facility gives immediate daily feedback to production for quality assurance in every unit built.

#### 24/7 EMERGENCY ROADSIDE ASSISTANCE

For a worry-free ownership experience Forest River includes one

## Coach-Net®

RV Technical & Roadside Assistance

year of Coach-Net RV Technical & Roadside Assistance with each RV purchase. Whether new to the RV lifestyle or an experienced RV enthusiast, Forest River owners have 24/7 access to technical, operational and emergency road service coverage throughout the US & Canada. Coach-Net's fast, dependable service is just a phone call away.



**FREE MEMBERSHIP**  
to Forest River Owners' Group

[www.forestriverfrog.com](http://www.forestriverfrog.com)



BACKPACK EDITION TRUCK CAMPER DEALER

#### Specification Definitions

**GVWR (Gross Vehicle Weight Rating)** - is the maximum permissible weight of the unit when fully loaded. It includes all weights, inclusive of all fluids, cargo, optional equipment and accessories. For safety and product performance do NOT exceed the GVWR.

**GAWR (Gross Axle Weight Rating)** - is the maximum permissible weight, including cargo, fluids, optional equipment and accessories that can be safely supported by a combination of all axles.

**UVW (Unloaded Vehicle Weight)\*** - is the typical weight of the unit as manufactured at the factory. It includes all weight at the unit's axle(s) and tongue or pin and LP Gas. The UVW does not include cargo, fresh potable water, additional optional equipment or dealer installed accessories.

\*Estimated average based on standard build optional equipment.

**CCC (Cargo Carrying Capacity)\*\*** - is the amount of weight available for fresh potable water, cargo, additional optional equipment and accessories. CCC is equal to GVWR minus UVW. Available CCC should accommodate fresh potable water (8.3 lbs per gallon). Before filling the fresh water tank, empty the black and gray tanks to provide for more cargo capacity.

\*\* Estimated average based on standard build optional equipment

Each Forest River RV is weighed at the manufacturing facility prior to shipping. A label identifying the unloaded vehicle weight of the actual unit and the cargo carrying capacity is applied to every Forest River RV prior to leaving our facilities.

The load capacity of your unit is designated by weight, not by volume, so you cannot necessarily use all available space when loading your unit.

All information contained in this brochure is believed to be accurate at the time of publication. However, during the model year, it may be necessary to make revisions and Forest River, Inc., reserves the right to make all such changes without notice, including prices, colors, materials, equipment and specifications as well as the addition of new models and the discontinuance of models shown in this brochure. Therefore, please consult with your Forest River, Inc., dealer and confirm the existence of any materials, design or specifications that are material to your purchase decision. Litho. U.S.A P / W: 2014.09.17



**Learn More**  
Scan this barcode using a QR Reader on your smart phone to learn more about Forest River.



A Berkshire Hathaway company.

SINCE 1968  
**PALOMINO**  
Recreational Vehicles  
a Division of Forest River

#### PALOMINO RV

1047 EAST M-86 | COLON, MI 49040  
P: 269.432.3271 | F: 269.432.2516  
[www.palominorv.com](http://www.palominorv.com)