

WOLF PUP, GREY WOLF, & WOLF DEN  
TRAVEL TRAILERS

CHER<sup>KEE</sup>

FOREST  
RIVER

CHER<sup>KEE</sup>

WOLF PUP, GREY WOLF & WOLF DEN  
TRAVEL TRAILERS



JOIN THE PACK.

14CCW



16BHSW

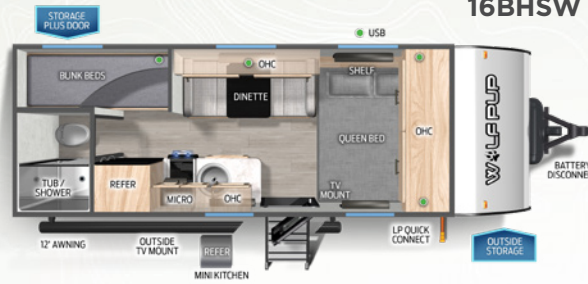

16CM



16EV



16FQW



16KHW

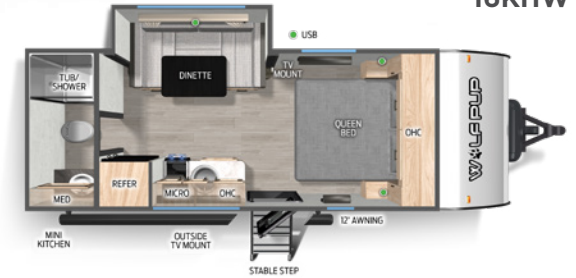

17EV



17JW

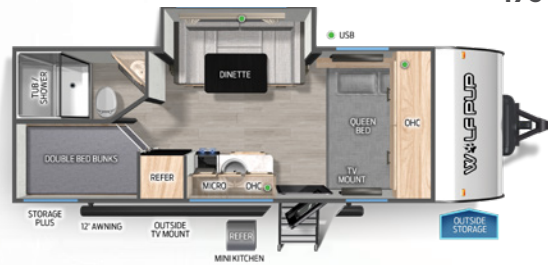

17SC



REAR RAMP & TRAVEL TRAILERS

	14CCW	16BHSW	16CM	16EV	16FQW	16KHW	17EV	17JW	17SC	18RJWB
Dry Hitch Weight	375-LBS.	475-LBS.	426-LBS.	393-LBS.	445-LBS.	535-LBS.	350-LBS.	607-LBS.	460-LBS.	655-LBS.
Ship Weight	3295-LBS.	3575-LBS.	3801-LBS.	3037-LBS.	3600-LBS.	3970-LBS.	3030-LBS.	4292-LBS.	4145-LBS.	3860-LBS.
Unloaded Vehicle Weight	3314-LBS.	3594-LBS.	3820-LBS.	2995-LBS.	3619-LBS.	3989-LBS.	3030-LBS.	4311-LBS.	4164-LBS.	3879-LBS.
Cargo Carrying Capacity	2161-LBS.	1981-LBS.	1706-LBS.	2498-LBS.	1926-LBS.	1646-LBS.	2420-LBS.	1396-LBS.	1396-LBS.	1876-LBS.
Axle Weight	2920-LBS.	3100-LBS.	3375-LBS.	2644-LBS.	3155-LBS.	3435-LBS.	2680-LBS.	3685-LBS.	3685-LBS.	3205-LBS.
Exterior Length	19'-3"	21'-9"	23'-10"	21'-9"	21'-10"	23'-9"	21'-10"	23'-11"	23'-10"	22'-8"
Exterior Height w/A/C	10'-6"	10'-6"	10'-6"	10'-6"	10'-6"	10'-6"	10'-6"	10'-6"	10'-6"	10'-6"
Exterior Width	7'-6"	7'-6"	7'-6"	7'-6"	7'-6"	7'-6"	7'-6"	7'-6"	7'-6"	7'-6"
Grey Capacity	28-GAL.	28-GAL.	28-GAL.	28-GAL.	28-GAL.	28-GAL.	28-GAL.	28-GAL.	28-GAL.	28-GAL.
Black Capacity	28-GAL.	28-GAL.	28-GAL.	28-GAL.	28-GAL.	28-GAL.	28-GAL.	28-GAL.	28-GAL.	28-GAL.
Fresh Capacity	26-GAL.	26-GAL.	26-GAL.	26-GAL.	26-GAL.	26-GAL.	26-GAL.	26-GAL.	26-GAL.	26-GAL.

TOYHAULER

18RJWB

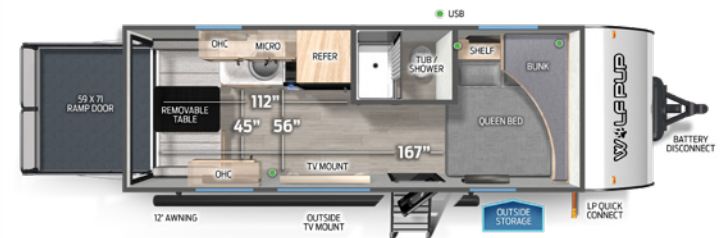

# WOLF PUP FEATURES

## LIMITED PACKAGE

- 13.5K BTU Air Conditioner
- 20,000 BTU Furnace
- Premium Bedding and Comforter
- Night Shades
- LED Interior Lights
- 12 V, High Efficiency 7.1 Cubic Foot Refrigerator with Travel Lock
- Upgraded Stainless Range Hood with Light and Fan
- Flush mount Range with Cover
- Seamless Countertop
- Inside and Outside Speakers
- USB-C Charging Stations
- Bedside Inverter
- Shower Tub Surround
- Exclusive Solar Thermo Controlled Reflective Tinted Safety Glass Windows
- Blackout Glass, Safety Slam, Friction Hinge Entry Door with Window and Shade Prep
- Cherokee Exclusive Stable Step with Oversized Landing
- Full Length Power Awning
- Exterior LED Light Strip at Awning
- Cherokee Backup Camera System
- Detachable Power Cord
- External Scare Light
- Outside Mini-Kitchen \* Where Available
- Outdoor Shower with Hot and Cold Water
- 12 Volt Tank Heaters
- Wolf Pup Quick Jack
- Four Stabilizer Jacks
- Spare Tire
- Tire Pressure Indicators
- Ladder Prep
- Tongue and Groove Plywood Flooring
- Power Gear Frame Technology and Space Saver Rail Design
- Seamless Roof Membrane with Heat Reflectivity
- Ramp Door Patio System
- \* Toyhauler Models Only
- Removable Gaucho Brackets
- \* Toyhauler Models Only
- Moonshade \* Toyhauler Models Only

Adventure Package \* Aggressive Off-road Tires, Diamond Plated Exterior & Lifted Frame

## ADVANTAGE PACKAGE

- Juice Pack \* 200W Roof Mounted Solar Panel, 30 Amp Solar Charger, Volt Meter & Battery Disconnect
- 14" Tires for improved towing in place of 13"
- 26" Wide Door IPO 22" Door
- Aerodynamic Smooth Radius Front Profile
- High Impact Front Metal IPO Corrugated Metal Exterior 110V Recept
- Large Exterior Folding Assist Handle
- Monitor Panel for Tanks and Battery Levels
- Outside Storage Door
- TV Antenna and Hookups
- RV Grill Quick Connect
- Roadside Assistance

## CAMPING PACKAGE

- 55 Amp Converter
- Tankless Water Heater
- Bathroom Fan
- Foot Flush Toilet
- High Flo Water Pump
- High Output Cooktop
- High Rise Faucet
- Large High Output Microwave
- Nitrogen Filled Tires
- One Piece, Walkable Decked Roof
- Oversized Dinette and Removable Table

## SAFETY PACKAGE

- Carbon Monoxide Detector
- Emergency Exit Windows
- Fire Extinguisher
- GFI Protective Outlet
- LP Gas Detector
- Safety Glass Windows
- Smoke Detector

\* Not All Features are Available on EV Models

# GREY WOLF

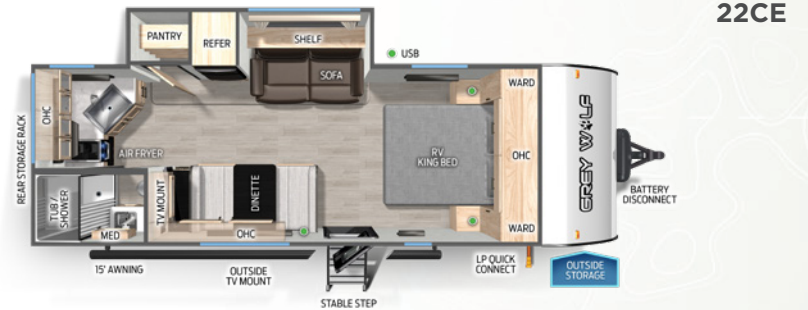
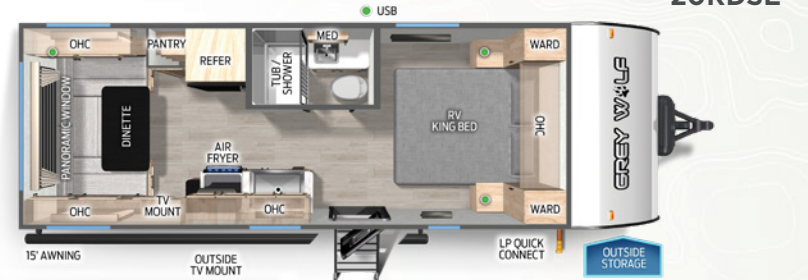
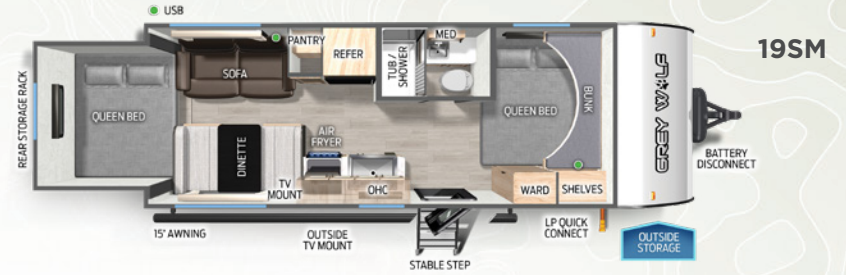

# GREY WOLF TRAVEL TRAILERS

	19SM	20RDSE	22CE
Dry Hitch Weight	526-LBS.	450-LBS.	615-LBS.
Ship Weight	4788-LBS.	4015-LBS.	4915-LBS.
Unloaded Vehicle Weight	4826-LBS.	4053-LBS.	4953-LBS.
Cargo Carrying Capacity	2700-LBS.	3397-LBS.	2662-LBS.
Axle Weight	4262-LBS.	3565-LBS.	4300-LBS.
Exterior Length	24'-5"	25'-4"	26'-2"
Exterior Height w/A/C	10'-6"	10'-6"	10'-6"
Exterior Width	97"	97"	97"
Grey Capacity	38 GAL.	38 GAL.	38 GAL.
Black Capacity	38 GAL.	28 GAL.	38 GAL.
Fresh Capacity	52-GAL.	52-GAL.	52-GAL.





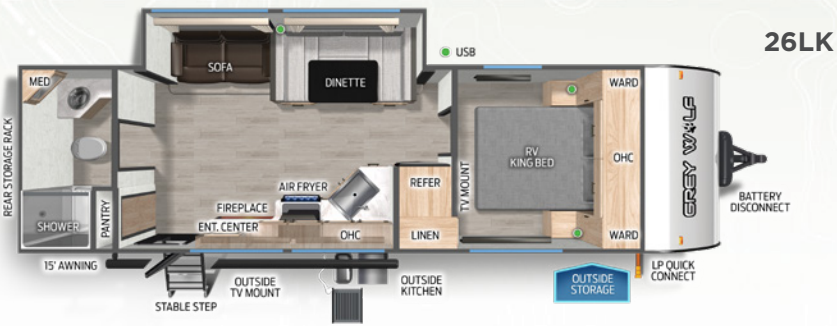

26LK



26SS

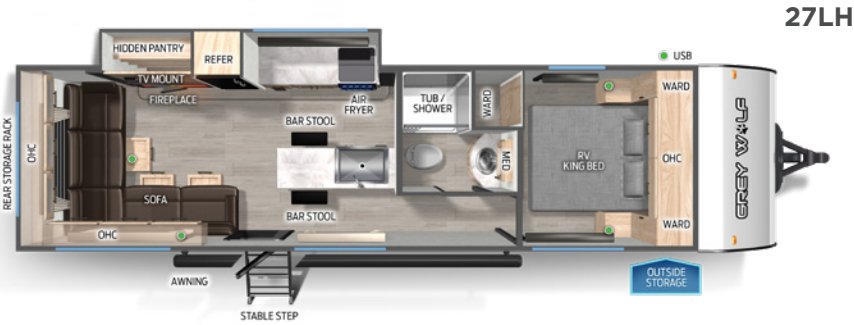

27LH

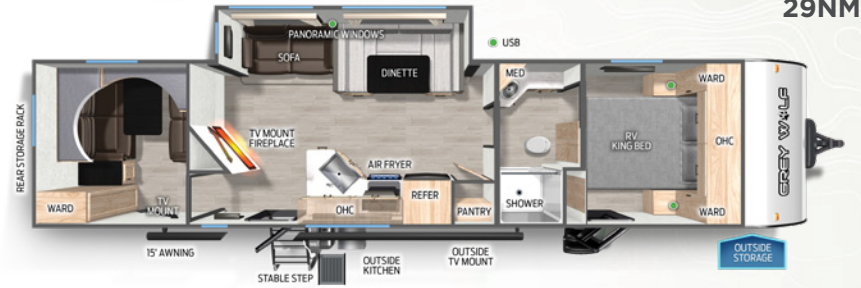

29NM

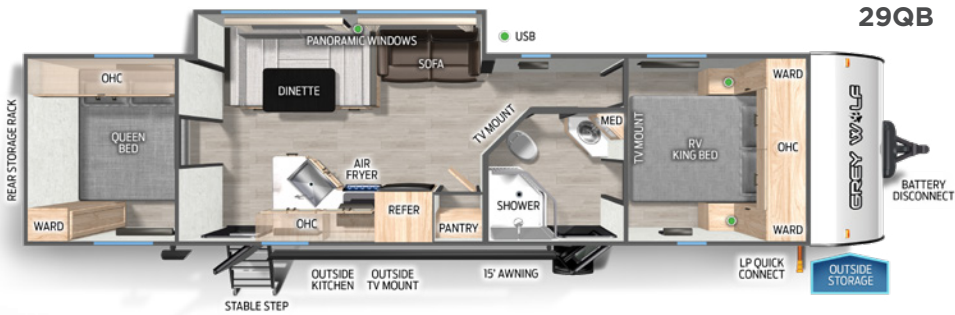

29QB

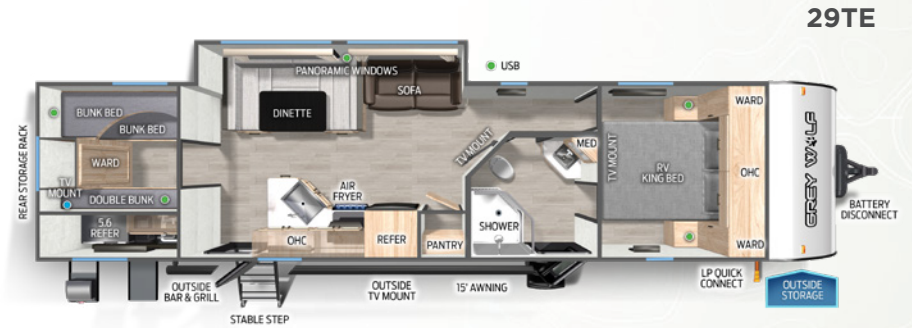

29TE

## GREY WOLF TRAVEL TRAILERS

	26LK	26SS	27LH	29NM	29QB	29TE
Dry Hitch Weight	815-LBS	700-LBS	755-LBS	905-LBS	977-LBS	837-LBS
Ship Weight	5735-LBS	6145-LBS	5915-LBS	6820-LBS	6580-LBS	6390-LBS
Unloaded Vehicle Weight	5773-LBS	6183-LBS	5953-LBS	6858-LBS	6618-LBS	6428-LBS
Cargo Carrying Capacity	2042-LBS	1517-LBS	1802-LBS	1047-LBS	1359-LBS	1409-LBS
Axle Weight	4920-LBS	5445-LBS	5160-LBS	5915-LBS	5603-LBS	5553-LBS
Exterior Length	31'-9"	30'-11"	33'-6"	37'-7"	36'-8"	36'-8"
Exterior Height w/A/C	10'-8"	10'-6"	10'-8"	10'-8"	10'-8"	10'-8"
Exterior Width	96"	97"	97"	97"	97"	97"
Grey Capacity	38-GAL.	38-GAL.	38-GAL.	38-GAL.	38-GAL.	38-GAL.
Black Capacity	28-GAL.	38-GAL.	38-GAL.	38-GAL.	38-GAL.	38-GAL.
Fresh Capacity	52-GAL.	52-GAL.	52-GAL.	52-GAL.	52-GAL.	52-GAL.



18RR

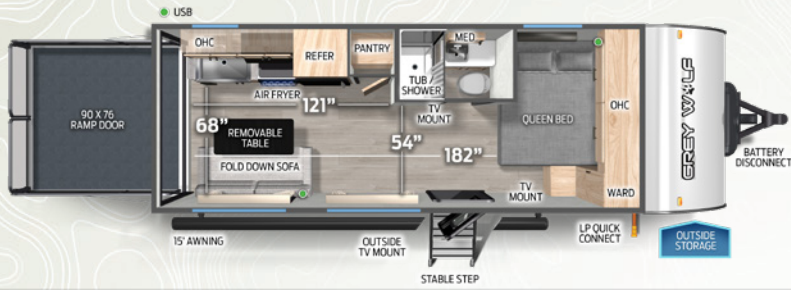

22RR



24RRT



25RRT

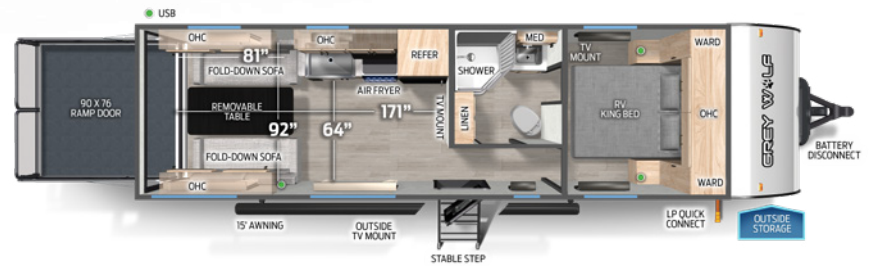

27RR

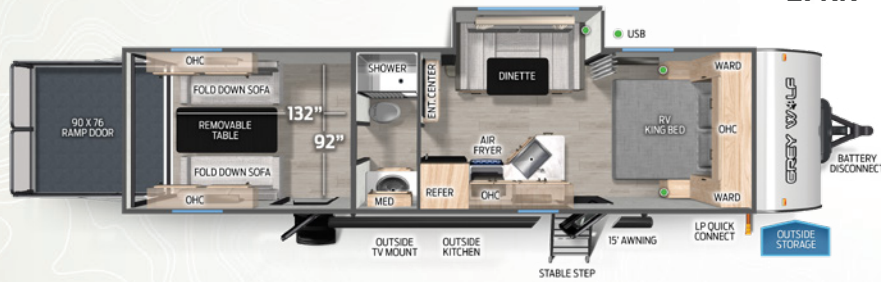

# GREY WOLF

	18RR	22RR	24RRT	25RRT	27RR
Dry Hitch Weight	550-LBS.	686-LBS.	995-LBS.	690-LBS.	1159-LBS.
Ship Weight	4425-LBS.	4833-LBS.	5815-LBS.	5065-LBS.	6533-LBS.
Unloaded Vehicle Weight	4463-LBS.	4871-LBS.	5853-LBS.	5103-LBS.	6571-LBS.
Cargo Carrying Capacity	3087-LBS.	2815-LBS.	2142-LBS.	2587-LBS.	1588-LBS.
Axle Weight	3875-LBS.	4147-LBS.	4820-LBS.	4375-LBS.	5374-LBS.
Exterior Length	24'-1"	29'-0"	33'-4"	30'-10"	34'-2"
Exterior Height w/ AC	10'-6"	10'-6"	10'-6"	10'-6"	10'-6"
Exterior Width	97"	96"	97"	97"	97"
Grey Capacity	28 GAL	38 GAL	38 GAL	38 GAL	38 GAL
Black Capacity	28 GAL	28 GAL	38 GAL	38 GAL	38 GAL
Fresh Capacity	52-GAL	52-GAL	52-GAL	52-GAL	52-GAL



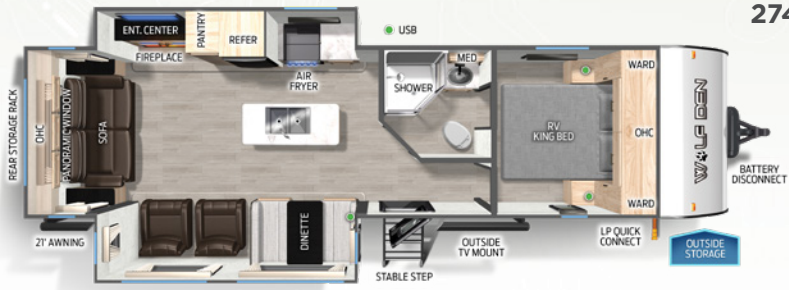

274WK

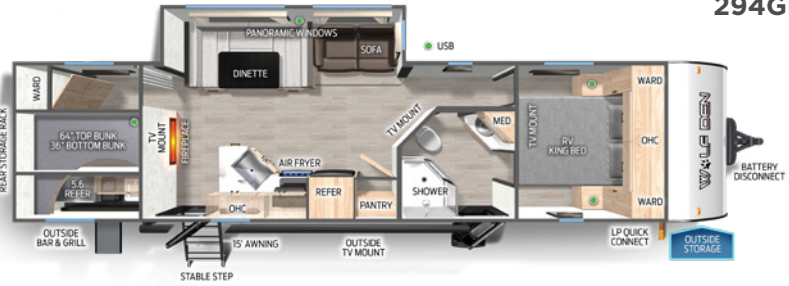

294GEBG

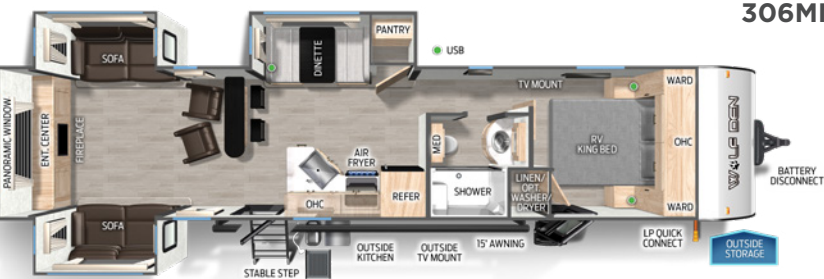

306MM



# WOLF DEN

	274WK	294GEBG	306MM
Dry Hitch Weight	895-LBS.	785-LBS.	900-LBS.
Ship Weight	7105-LBS.	6940-LBS.	8540-LBS.
Unloaded Vehicle Weight	7143-LBS.	6978-LBS.	8578-LBS.
Cargo Carrying Capacity	2842-LBS.	4007-LBS.	2522-LBS.
Axle Weight	6210-LBS.	6155-LBS.	7640-LBS.
Exterior Length	33'-2"	36'-8"	40'-1"
Exterior Height w/ AC	11'-1"	11'-1"	11'-1"
Exterior Width	97"	97"	97"
Grey Capacity	38-GAL	76-GAL	38-GAL
Black Capacity	38-GAL	38-GAL	38-GAL
Fresh Capacity	52-GAL	52-GAL	52-GAL



# GREY WOLF WOLF DEN FEATURES

## LIMITED PACKAGE

12 V, High Efficiency, 10 Cubic Foot Residential Refrigerator with Travel Lock  
 Chef Select Black Stainless Steel Kitchen Suite Package  
 Super Kitchen  
 Seamless Countertops  
 Matte Black Heavy Duty Spring Assisted Kitchen Faucet Sprayer  
 Residential Farm Style Black Stainless Steel Sink  
 Fireplace \* Where Available  
 Premium Bedding and Comforter  
 Upgraded Sofa with Bolster Arm Rests  
 Supersized Central Air Conditioning Unit 15,000 BTU \* Where Available  
 USB-C Charging Stations  
 Full Hybrid Tub with Shower Surround  
 LED Interior Lights  
 Light Filtering Sheet Shading Premium Blackout Zebra Blinds

RV King Bed \* Where Available  
 Bedside Inverter  
 Exclusive Solar Thermo Controlled Reflective Tinted Safety Glass Windows  
 Blackout Glass, Safety Slam, Friction Hinge Entry Door with Window and Shade Prep  
 Cherokee Exclusive Stable Step with Oversized Landing  
 Exterior LED Light Strip at Awning  
 External Porch Scare Light  
 Outside Kitchen \* Where Available  
 Premium Wheel Package  
 Tire Pressure Indicators  
 Spare Tire  
 Four Stabilizer Jacks  
 Ladder Prep  
 Cherokee Backup Camera System  
 12 Volt Tank Heaters  
 Ramp Door Patio System  
 \* Toyhauler Models Only

Removable Gaucho Brackets  
 \* Toyhauler Models Only  
 Moonshade \* Toyhauler Models Only  
 Adventure Package \* Aggressive Off-road Tires, Diamond Plated Exterior & Lifted Frame-Toyhauler Models Only  
 Juice Pack \* 200W Roof Mounted Solar Panel, 30 Amp Solar Charger, Volt Meter & Battery Disconnect  
 Power Gear Frame Technology and  
 Space Saver Rail Design  
 5/8" Tongue and Groove Plywood Flooring  
 Seamless Roof Membrane with  
 Heat Reflectivity-Walkable

Outside TV Bracket and Hookups  
 Power Awning  
 RV Grill Quick Connect

## CAMPFIRE PACKAGE

40" Dinette Drawers x 2 on Models with Slide Outs  
 Tankless Water Heater  
 Cabinets in Bedroom  
 High Output Attic Fan in Bathroom  
 Air Fryer  
 Roof Mounted Ducted Air Conditioner  
 \* NA on models under 26'  
 Skylight over Shower  
 Solid Bedroom Doors \* Where Available

\* Not All Features are Available on EV Models

## BASE CAMP PACKAGE

Black Waste Tank Flush Out Kit  
 Armored Underbelly Tank Enclosure  
 Flip Down Travel Rack \* NA on Toyhauler Models  
 Large Exterior Folding Assist Grab Handle  
 Outdoor Shower with Hot and Cold Water

**FREE MEMBERSHIP**  
 to Forest River Owners' Group  
[www.forestriverfrog.com](http://www.forestriverfrog.com)



**Learn More:**  
 Scan this barcode using a QR reader on your smart phone to learn more about Forest River.



[WWW.FORESTRIVERINC.COM/CHEROKEE](http://WWW.FORESTRIVERINC.COM/CHEROKEE)  
 574.264.6664



### PRE-DELIVERY INSPECTION FACILITY

20,000 square feet of quality assurance. The bare essentials for a premium product. This state-of-the-art facility gives immediate daily feedback to production for quality assurance in every unit built.



### 24/7 EMERGENCY ROADSIDE ASSISTANCE WITH VEHICLE PURCHASE\*

TOWING  
 JUMP-STARTS  
 TIRE CHANGES  
 FLUID DELIVERY  
 LOCKOUT  
 SERVICE

WINCH-OUT  
 MOBILE MECHANIC  
 TECHNICAL  
 SUPPORT  
 DEALER LOCATOR  
 SERVICES



\*VALID FOR 1 YEAR FROM DATE OF PURCHASE

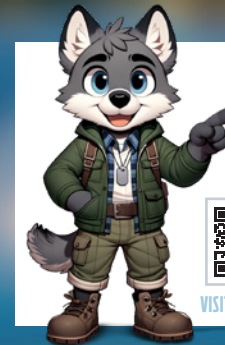

VISIT US ONLINE

YOUR CHEROKEE DEALER



**SPECIFICATION DEFINITIONS GVWR (Gross Vehicle Weight Rating)**-is the maximum permissible weight of the unit when fully loaded. It includes all weights, inclusive of all fluids, cargo, optional equipment and accessories. For safety and product performance do NOT exceed the GVWR. // **GAWR (Gross Axle Weight Rating)**-is the maximum permissible weight, including cargo, fluids, optional equipment and accessories that can be safely supported by a combination of all axles. // **UVW (Unloaded Vehicle Weight)**\*-is the typical weight of the unit as manufactured at the factory. It includes all weight at the unit's axle(s) and tongue or pin and LP Gas. The UVW does not include cargo, fresh potable water, additional optional equipment or dealer installed accessories. \*Estimated average based on standard build optional equipment. // **CCC (Cargo Carrying Capacity)\*\***-is the amount of weight available for fresh potable water, cargo, additional optional equipment and accessories. CCC is equal to GVWR minus UVW. Available CCC should accommodate fresh potable water (8.3 lbs per gallon). Before filling the fresh water tank, empty the black and gray tanks to provide for more cargo capacity. \*\* Estimated average based on standard build optional equipment. Each Forest River RV is weighed at the manufacturing facility prior to shipping. A label identifying the unloaded vehicle weight of the actual unit and the cargo carrying capacity is applied to every Forest River RV prior to leaving our facilities. The load capacity of your unit is designated by weight, not by volume, so you cannot necessarily use all available space when loading your unit.