

# BRAXTON CREEK

*Family Values Run Deep*

## ***BX SERIES***





# BX FLOORPLANS

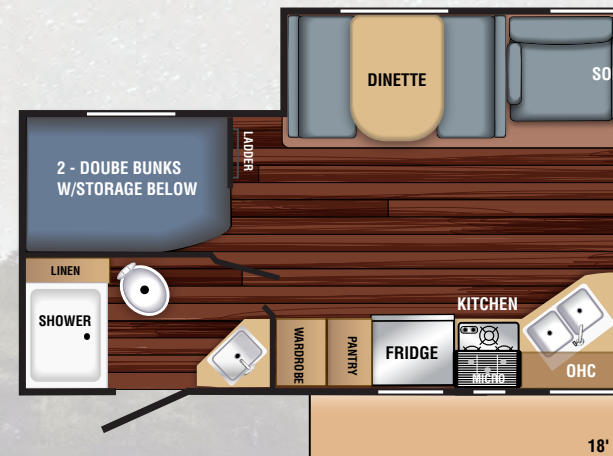
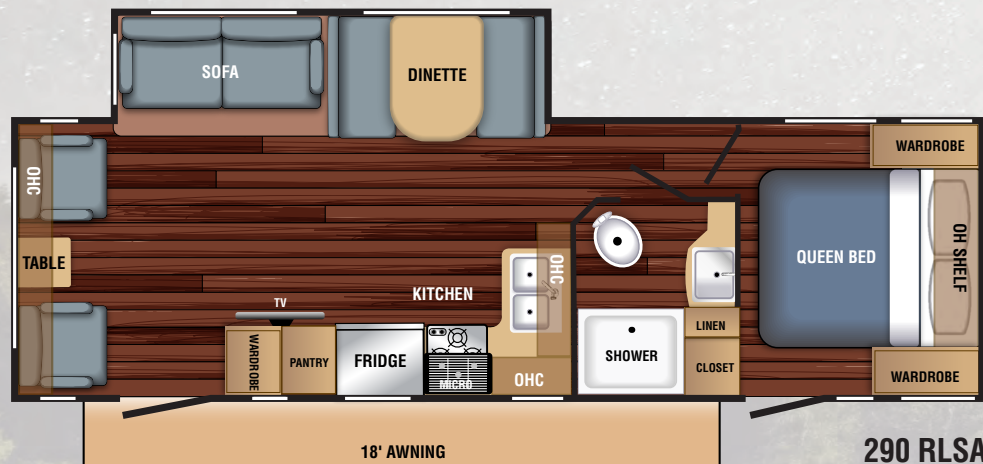
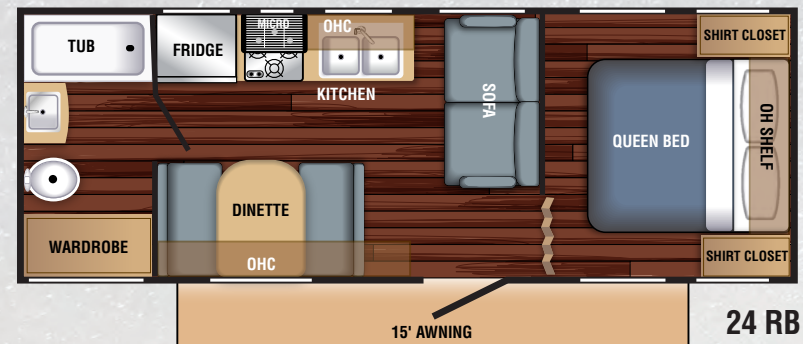
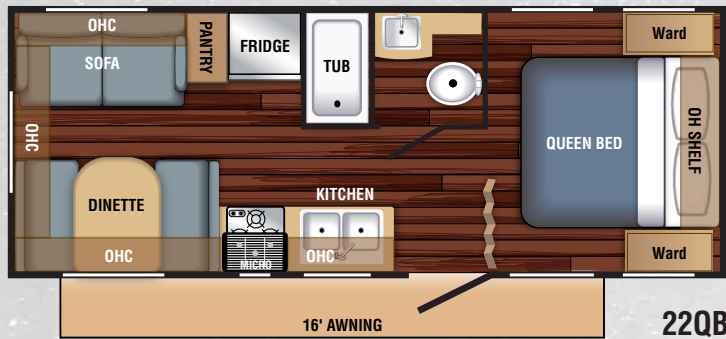

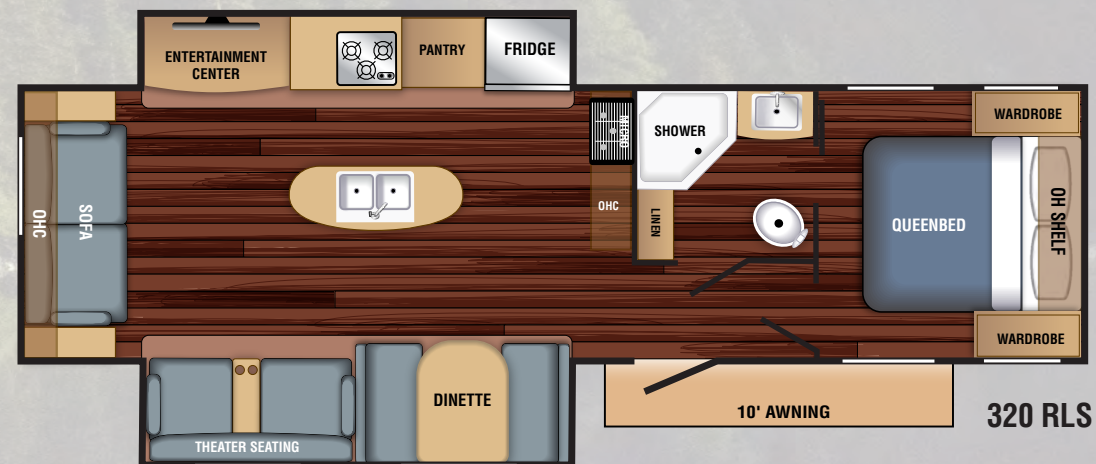
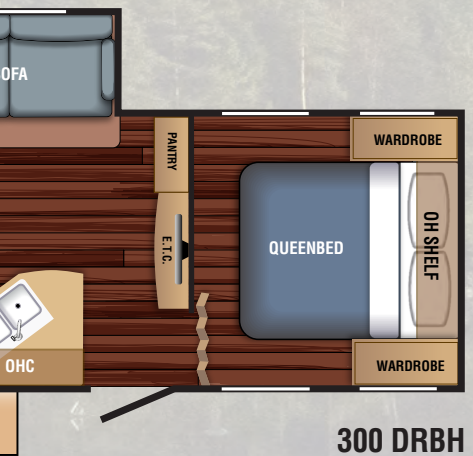
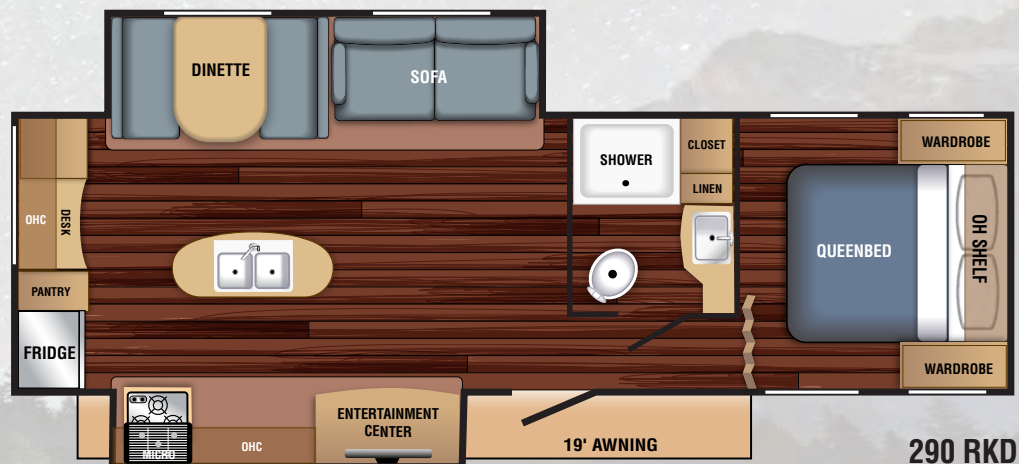
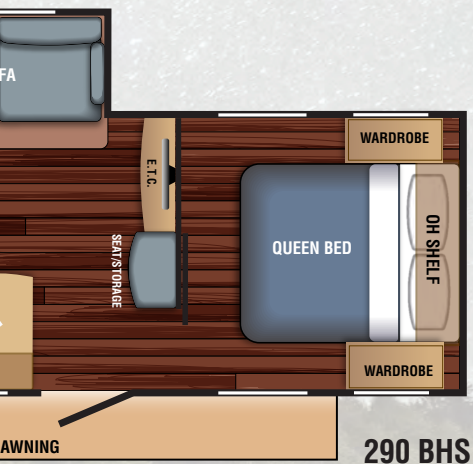
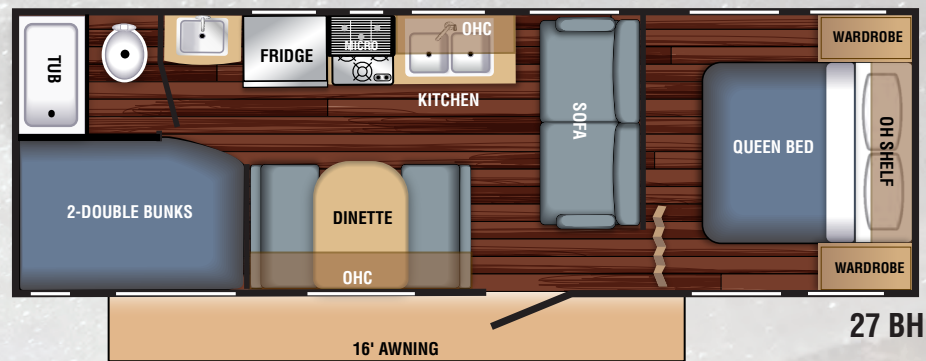
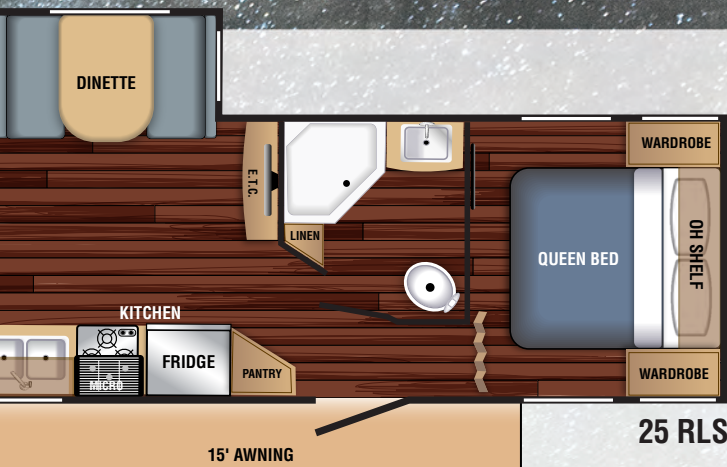



## BX STANDARD FEATURES

### STANDARD EXTERIOR FEATURES

- Fully decked, one piece Dicor Tufflex roof with 15 year manufacturers backed warranty
- 4" Radius truss roof rafters, 16" on center, with 3/8" full coach walk-on decking
- Drip rails with extended spouts
- .024 mesa crimp aluminum exterior (side-walls & back), with fade resistant, stylized graphics
- Exclusive Z-Frame, NXG Norco main frame, with a fully integrated, welded A-frame, and Huck-bolted outriggers
- American made Dexter Axles, with balanced RV specific radial tires
- 5/8" tongue and groove plywood floor with R-7 fiberglass blanket wrapped insulation.
- 16" on center sidewall, and floor structure with, complete blanket wrapped fiberglass insulation in roof, walls, end walls, and floor
- Radius entry door
- Folding entry assist handle

- Radius baggage doors
- Dometic 13,500-BTU roof mounted A/C, with full coach high-efficiency air ducting
- Dark-tint, safety-glass windows with automotive gasket seals
- Galvanized steel, impact-resistant wheel wells
- Aerodynamic front profile
- Lower, front chip resistant diamond-plate rock guard.
- .030 Smooth aluminum front exterior wall
- 30 AMP electrical service with extra-long detachable power cord
- Easy access, outside cable TV hookup
- Integrated, Huck-bolted rear bumper w/sewer hose storage
- LED exterior lights
- Fold-A-Way Entry Assist Handle at main entrance

### STANDARD INTERIOR FEATURES

- 81" ceiling height

- Extra tall slide-rooms
- Bedroom roof vent
- USB port-Bedroom & Living Room
- Rich, contemporary wood color, and long-lasting, interior designer fabrics
- Amish crafted hardwood cabinets, and cabinet doors w/contemporary style
- Ball-bearing drawer guides throughout, 75# capacity, full extension
- Laminated countertops with profiled edges throughout
- Acrylic double kitchen sink w/ High-rise faucet (Brushed Nickel)
- Dometic high-efficiency furnace
- Dometic, wall mounted, digital thermostat for A/C & Furnace
- LED Interior lights
- Durable, woodgrain plank, linoleum flooring throughout
- Home Styled Furniture
- Premium sound system w/MP3/iPod input jacks, Bluetooth and exterior marine speakers

- Plywood bed and booth dinette seats
- Dometic marine toilet with foot-flush
- 1-piece tub surround w/retractable shower enclosure (except on 25RLS & 320RLS)
- Glass shower enclosure-25RLS & 320RLS
- Medicine cabinet w/mirror in bathroom
- Queen bed with easy-lift, under bed storage.
- Privacy curtains in bedroom and bunk areas.
- 4-inch bunk mattresses covered in soft-quilted durable fabric

### BX Campers VALUE PACKAGE

- EZ-Swap 20# LP Tanks with cover
- Go Power Pre-Wire Solar Prep Package
- Gas/Electric DSI Water Heater
- Systems Monitor Panel
- King Digital Antenna
- Rear Aluminum Ladder
- Bath Skylight

- Front Diamond Plate
- MORryde One-Step entry step at main entry door
- Pre-wired backup camera
- Power electric outside awning with LED lights
- Outside Shower
- Pleated Window Shades
- Designer, quilted bedspread
- 3-Burner cook-top, range and vent-hood with fan and light
- Spare Tire with Carrier & Cover
- 4 Stabilizer Jacks
- Black tank flush-out system
- Water Heater Bypass Kit
- Fully Enclosed, Insulated & Heated Underbelly
- Marine-style outside speakers
- High-Point Microwave
- Wheel Upgrade Package
- 6 cu. Ft. Dometic Americana-Plus refrigerator with adjustable thermostat



All information in this brochure is the latest available at the time of publication approval. Braxton Creek reserves the right to make changes and to discontinue models without notice or obligation. Photography may show optional equipment or props used for decoration purposes only.

## BX SPECIFICATIONS

MODEL	Exterior Length	Exterior Width	Exterior Height	Interior Height	Unloaded TT Weight	Dry Hitch Weight	GVWR	Cargo Carrying Capacity	Fresh Water Capacity	Grey Waste Water Capacity	Black Waste Water Capacity	Sleeping Capacity
22QB	25' 5"	96"	10' 8"	81"	4440	550	7000	2145	50	44	44	4
24RB	27' 1"	96"	10' 8"	81"	4460	500	7000	2125	50	44	44	4-6
25RLS	29' 4"	96"	11' 1"	81"	5340	540	7000	1245	50	44	44	4-6
27BH	29' 4"	96"	10' 8"	81"	4970	490	7000	1615	50	44	44	8-10
290RLSA	32' 4"	96"	11' 4"	81"	6500	700	8800	1885	50	44	44	4-6
290BHS	33' 10"	96"	11' 2"	81"	6380	720	8800	2005	50	88	44	8-10
300BHS	32' 8"	96"	11' 2"	81"	6340	700	8800	2045	50	88	44	8-10
290RKD	32' 2"	96"	11' 4"	81"	6520	560	8800	1865	50	44	44	4-6
300DRBH	34' 2"	96"	11' 4"	81"	6500	880	8800	1885	50	44	44	8-10
320RLS	34' 8"	96"	11' 4"	81"	7000	793	8800	1385	50	44	44	4-6

*\*Braxton Creek reserves the right to change specifications without notice or obligation.*



# BRAXTON CREEK

0925N. State Road 5, Shipshewana, IN 46565

P.260-768-7932 F.260-768-7921

www.braxtoncreek.com